

WEG General Purpose

Three-Phase Electric
Motor
Technical Catalogue
Turkish Market

Industrial Motors

Commercial &
Appliance Motors

Automation

Digital &
Systems

Energy

Transmission &
Distribution

Coatings

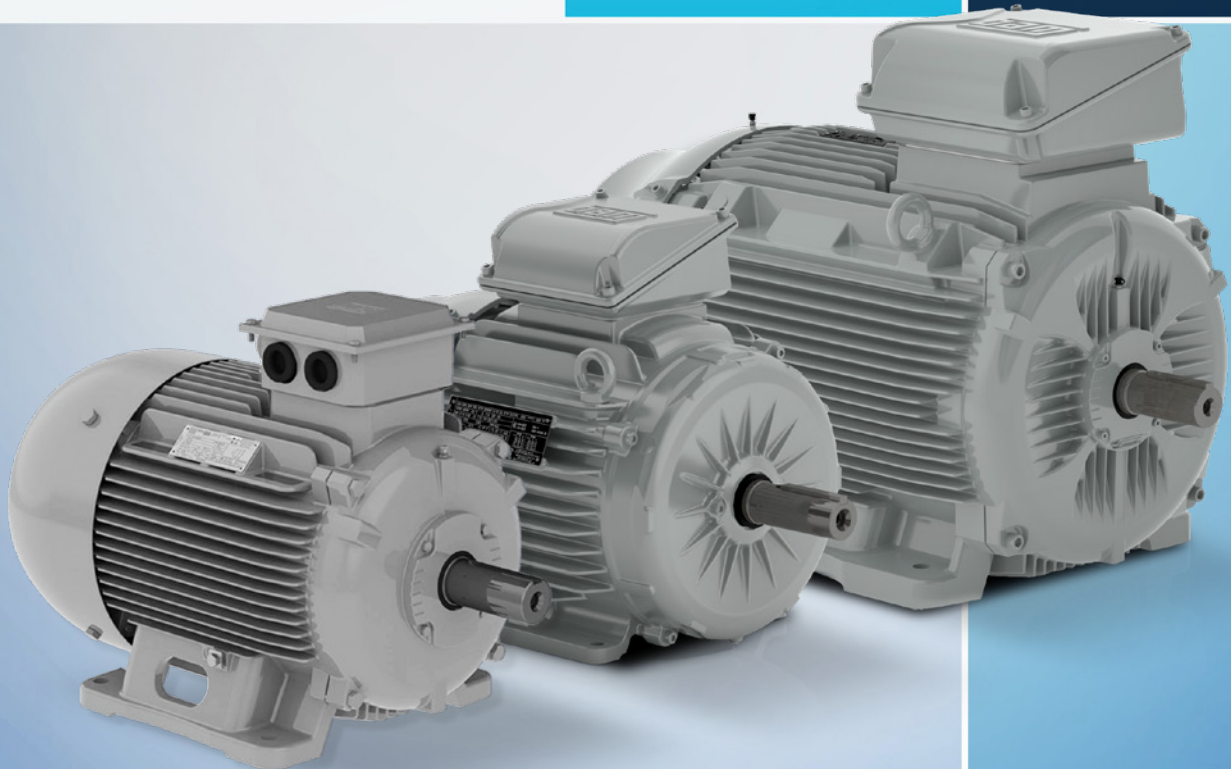

Driving efficiency and sustainability



WEG GENERAL PURPOSE

The **evolution**
of the standard.

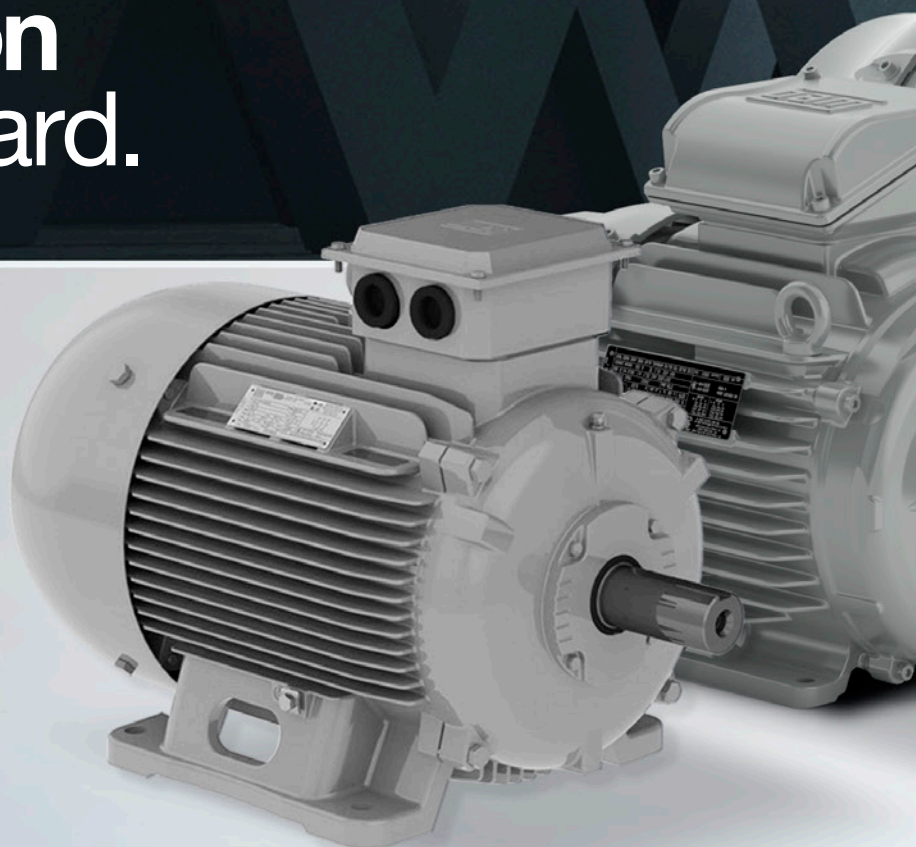

Able to operate
with frequency
inverter



IP55 - protection
against water
and dust

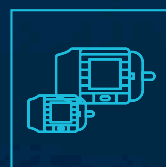

Frames 56 to 355
(0.12 up to
355 kW @50 Hz)

Industrial Motors

Commercial &
Appliance Motors

Automation

Digital &
Systems

Energy

Transmission &
Distribution

Coatings

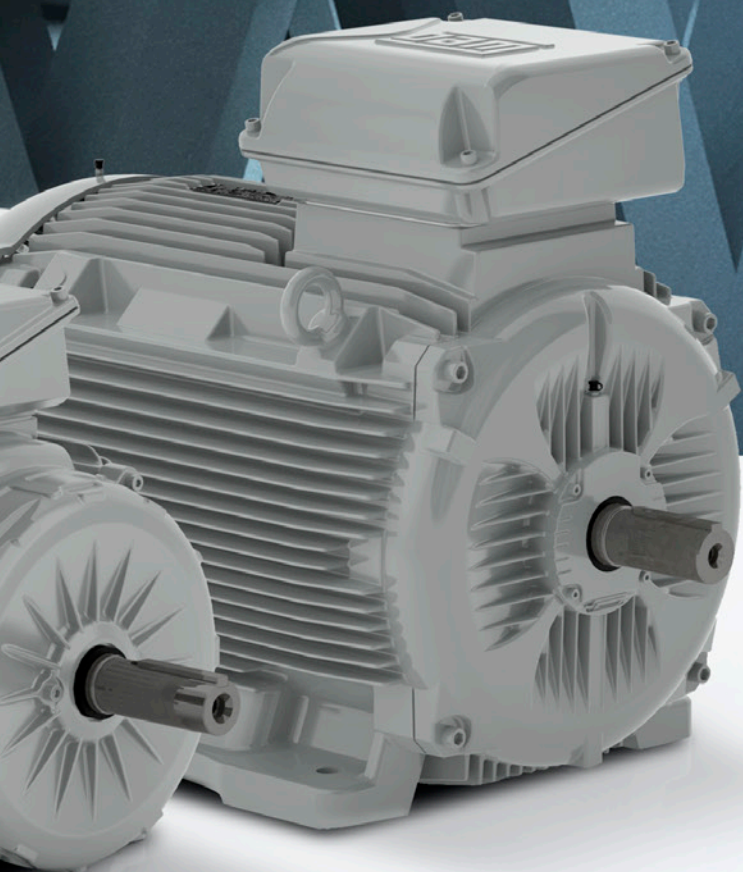

WEG quality, recognized worldwide, is present in all of our electric motors, from those developed for specific applications to models manufactured for general use, such as the new **WEG General Purpose** line. A light, compact and reliable solution that guarantees efficiency and high performance in a great variety of applications.

Driving efficiency and sustainability



1. Construction Features

Frame size	56	W63	W71	80	90S/L	100L	112M	132S	S132S	
Mechanical features										
Marking	CE (according EU regulation), UKCA (according UK regulation) and EAC									
Certification	EAC									
Mounting	B3T									
Frame Material	Aluminum									
Degree of protection	IP55									
Grounding	Single Grounding									
Cooling method	Totally enclosed fan cooled (IC411)									
Fan Material	2P	Polymeric								
	4P									
Fan cover Material	Polymeric									
Endshields Material	Aluminum	Polymeric	FC-200 Cast Iron							
Drain plug	Automatic drain plug									
Rolling bearings	Shielded/Clearance (DE/NDE)	2P	ZZ							
		4P								
	Locking		None			DE bearing locked				
	Bearing life (h)		20.000							
	Drive end side	2P	6201	6202	6204	6205	6206	6207	6208	
4P										
Non drive end side	2P	6201		6202	6204		6206	6207		
	4P									
Bearing sealing	Drive end side		V'ring							
	Non drive end side		Without sealing							
Joints sealing		Without sealing								
Lubrication	Grease type		Mobil Polyrex EM							
	Grease fitting	2P	Not applicable							
4P										
Terminal block		BMC 6 pins								
Terminal box material		Polymeric			Steel Plate					
Additional terminal box		None								
Leads inlet	Main	Size	1 x Ø22,4 (able to M20)			M24 x 1.5 e 2 x M32 x 2				
	Lateral hole		None							
	Plug		Flat polymeric plug			Knockout				
Shaft	Material		SAE 1040/45							
	DE threaded hole	2P	M3	M4	M5	M6	M8	M10	M12	
		4P								
Key		Fitted with "A" type								
Vibration level		Grade A								
Balancing	2P	None			With 1/2 key		With 1/2 key			
	4P	None			With 1/2 key		With 1/2 key			
Nameplate material		Label			Stainless Steel AISI 304					
Painting	Type	Without Painting			201A					
	Color	No Painting			Aluminum					
Packaging		Pallet				Cardboard box				
Electrical features										
Design		N								
Voltage (50//60 Hz)		230/400V //460V					400/690V //460V			
Winding	Impregnation		Dip and Bake							
	Insulation class	IE1	F (F)							
		IE2, IE3 and IE4	F (B)							
Service factor		1,00								
Thermal protector		None								
Space heaters										
Flying leads										
Ambient temperature		-20 °C up to +40°C								
Starting method		Direct on-line								

Frame size		160M	160L	180M	180L	200M/L	225S/M	250S/M	W280S/M	W315S/M	315S/M	315L	355M/L		
Mechanical features															
Marking		CE (according EU regulation), UKCA (according UK regulation) and EAC													
Certification		EAC													
Mounting		B3T													
Frame Material		FC-200 Cast Iron													
Degree of protection		IP55													
Grounding		Single Grounding						Double Grounding							
Cooling method		Totally enclosed fan cooled (IC411)													
Fan Material	2P	Polymeric													
	4P	Polymeric									Aluminum ¹				
Fan cover Material		Polymeric						FC-200 Cast Iron							
Endshields Material		FC-200 Cast Iron													
Drain plug		Automatic T-labyrinth drain plug													
Rolling bearings	Shielded/ Clearance (DE/NDE)	2P	ZZ-C3						C3						
		4P													
	Locking		DE bearing locked with inner bearing cap and fitted with wave washer in the NDE bearing						DE bearing locked with inner and outer bearing cap and fitted with helical spring washer in the NDE bearing						
	Bearing life (h)		20.000												
	Drive end side	2P	6209	6209	6211	6211	6212	6214	6214	6314	6314	6314	6314	6316	
4P									6316	6319	6319	6319	6322		
Non drive end side	2P	6209	6209	6209	6209	6209	6212	6212	6212	6314	6314	6314	6314		
	4P									6316	6316	6316	6319		
Bearing sealing	Drive end side		V'ring						WSeal						
	Non drive end side		V'ring						WSeal						
Joints sealing		None													
Lubrication	Grease type		Mobil Polyrex EM												
	Grease fitting	2P	None						With grease fittings in DE and NDE bearings						
4P															
Terminal block		BMC 6 pins													
Terminal box material		FC-200 Cast Iron													
Additional terminal box		None													
Leads inlet	Main	Size	2 x M40 x 1.5			2 x M50 x 1.5			2 x M63 x 1.5			2 x M80 x 2			
	Lateral hole		M20 x 1.5												
	Plug		Polymeric plug for transport and storage purposes												
Shaft	Material		SAE 1040/45									SAE 4140			
	DE threaded hole	2P	M16						M20						M20
		4P													M24
Key		Fitted with "A" type						Fitted with "B" type							
Vibration level		Grade A													
Balancing	2P		With 1/2 key												
	4P														
Nameplate material		Aluminum													
Painting	Type		203A												
	Color		Matte Gray RAL 7042												
Packaging		Crate													
Electrical features															
Design		N													
Voltage (50/60 Hz)		400/690V //460V													
Winding	Impregnation		Dip and Bake						Continuous Resin Flow						
	Insulation class	IE1	F (F)												
IE2, IE3 and IE4		F (B)													
Service factor		1,00													
Thermal protector		Single PTC Thermistor - 155 °C (1 per motor)													
Space heaters		None													
Flying leads															
Ambient temperature		-20 °C up to +40°C													
Starting method		Direct on-line													

Note:

1) Polymeric fan material for IE3 and IE4 motors in 315L frame size.

2.2 WEG General Purpose - Super Premium Efficiency - 50 Hz - IE4 ⁽¹⁾

Output		Frame	Full Load Torque (Nm)	Locked Rotor Current I/In	Locked Rotor Torque Tl/Tn	Break-down Torque Tb/Tn	Inertia J (kgm ²)	Allowable locked rotor time (s)		400 V							Full load current In (A)
										Rated speed (rpm)	% of full load						
											Efficiency			Power Factor			
kW	HP							Hot	Cold		50	75	100	50	75	100	
II Poles																	
11	15	160M	35,5	8,8	3,0	4,3	0,0514	12	22	2960	90,6	92,1	92,6	0,68	0,79	0,84	20,4
15	20	160M	48,6	8,7	3,1	4,1	0,0514	12	22	2950	91,6	92,7	93,3	0,69	0,79	0,85	27,3
18,5	25	160L	59,8	9,2	3,5	4,3	0,0625	12	22	2955	92,1	93,2	93,7	0,70	0,80	0,85	33,5
22	30	180M	71,0	8,5	2,4	3,8	0,0973	12	22	2960	92,3	93,4	94,0	0,72	0,81	0,85	39,7
30	40	200M/L	96,5	8,1	3,5	3,8	0,2119	12	22	2970	92,5	93,7	94,5	0,71	0,81	0,85	53,9
37	50	200M/L	119,7	8,1	3,5	3,7	0,1950	18	32	2965	93,0	94,1	94,8	0,70	0,80	0,84	67,1
45	60	225S/M	144,2	9,0	3,1	3,9	0,3771	12	22	2975	92,8	94,0	95,0	0,73	0,82	0,86	79,5
55	75	250S/M	176,6	8,7	3,6	3,6	0,4906	18	32	2975	93,3	94,3	95,3	0,76	0,84	0,87	95,7
75	100	W280S/M	242,0	8,3	3,2	3,4	0,457	32	70	2965	93,9	94,7	95,6	0,76	0,84	0,87	130,0
90	125	W280S/M	290,0	8,4	3,4	3,4	0,541	27	59	2970	94,2	95,0	95,8	0,78	0,85	0,88	154,0
110	150	W315S/M	353,0	7,4	2,4	3	1,38	29	64	2976	94,5	95,3	96,0	0,79	0,85	0,88	188,0
132	175	315S/M	423,0	7,3	2,1	2,9	1,88	39	86	2984	94,6	95,6	96,2	0,77	0,85	0,88	225,0
160	220	315S/M	513,0	7,0	2,1	2,7	2,24	37	81	2983	95,1	95,8	96,3	0,80	0,87	0,88	273,0
200	270	315S/M	640,0	8,5	2,4	3,3	2,77	23	51	2986	95,0	95,9	96,5	0,78	0,85	0,88	340,0
250	340	315L	800,0	8,8	2,9	3,2	3,59	18	40	2986	95,1	96,1	96,5	0,79	0,86	0,89	420,0
315	430	355M/L ²	1008,0	7,6	2,4	2,4	5,25	31	68	2985	95,4	96,0	96,5	0,82	0,87	0,89	529,0
355	480	355M/L ²	1135,0	8,7	2,7	3	6,01	23	51	2988	95,3	96,0	96,5	0,81	0,87	0,89	597,0
IV Poles																	
11	15	160M	71,2	6,9	2,5	3,4	0,1118	18	32	1476	92,2	93,1	93,3	0,67	0,78	0,83	20,5
15	20	160L	97,0	7,6	2,9	3,7	0,1537	18	32	1477	92,6	93,5	93,9	0,67	0,78	0,83	27,8
18,5	25	180M	119,7	7,8	3,6	3,9	0,1827	18	32	1476	92,8	93,9	94,2	0,63	0,75	0,81	35,0
22	30	180L	142,2	7,6	3,2	3,7	0,2262	18	32	1475	93,4	94,3	94,5	0,67	0,77	0,83	40,5
30	40	200M/L	193,3	8,5	3,2	4,0	0,3074	23	41	1481	93,5	94,5	94,9	0,64	0,75	0,81	56,3
37	50	225S/M	238,4	8,7	3,2	3,8	0,6634	18	32	1486	93,7	94,6	95,2	0,67	0,77	0,83	67,6
45	60	225S/M	290,4	7,7	2,8	3,3	0,5897	47	85	1483	94,1	94,9	95,4	0,69	0,78	0,83	82,0
55	75	250S/M	353,2	8,8	3,2	3,5	1,2100	12	22	1487	94,7	95,4	95,7	0,70	0,80	0,84	98,8
75	100	W280S/M	483,0	8,0	3,4	3,5	1,08	31	68	1485	95,0	95,6	96,0	0,69	0,79	0,83	136
90	125	W280S/M	579,0	7,9	3,5	3,5	1,21	27	59	1484	95,1	95,7	96,1	0,69	0,79	0,83	163
110	150	W315S/M	706,0	7,5	2,7	3	2,60	23	51	1488	95,2	95,9	96,3	0,67	0,77	0,82	201
132	175	W315S/M	848,0	7,9	3	3,2	3,13	17	37	1488	95,3	95,9	96,4	0,66	0,76	0,82	241
160	220	315S/M	1025,0	7,8	3	3	4,22	33	73	1492	95,5	96,2	96,6	0,73	0,82	0,86	278
200	270	315S/M	1282,0	7,7	3	2,8	5,33	29	64	1491	95,8	96,4	96,7	0,76	0,84	0,87	343
250	340	315L	1604,0	6,8	2,6	2,6	5,64	26	57	1489	96,1	96,6	96,7	0,77	0,84	0,87	429
315	430	315L ²	2020,0	7,9	3,1	2,8	6,85	18	40	1490	96,0	96,5	96,7	0,74	0,83	0,86	547
355	480	355M/L ²	2273,0	7,5	2,9	2,9	11,5	20	44	1492	95,3	96,2	96,7	0,72	0,80	0,84	631

Note:

(1) Efficiency values are given according to IEC 60034-2-1. They are calculated according to indirect method, with stray load losses determined by measurement.

(2) Fitted with air deflector in the drive end side.

* 6 poles and 8 poles motors under request.

3. Mechanical Data

3.1 Foot Mounted Motors, Terminal Box Top

Frames 56 to 71/M

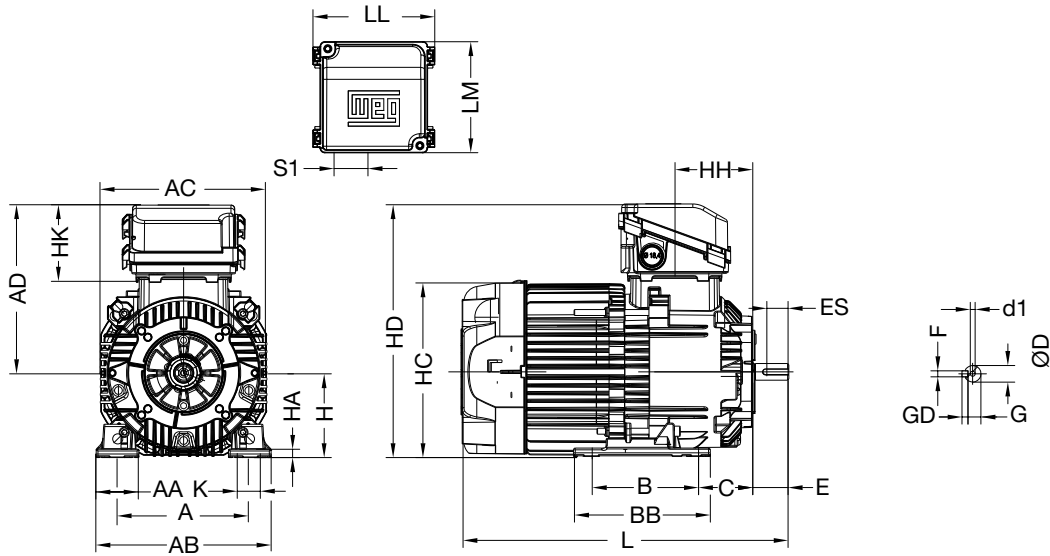

Frames 80 to 132M

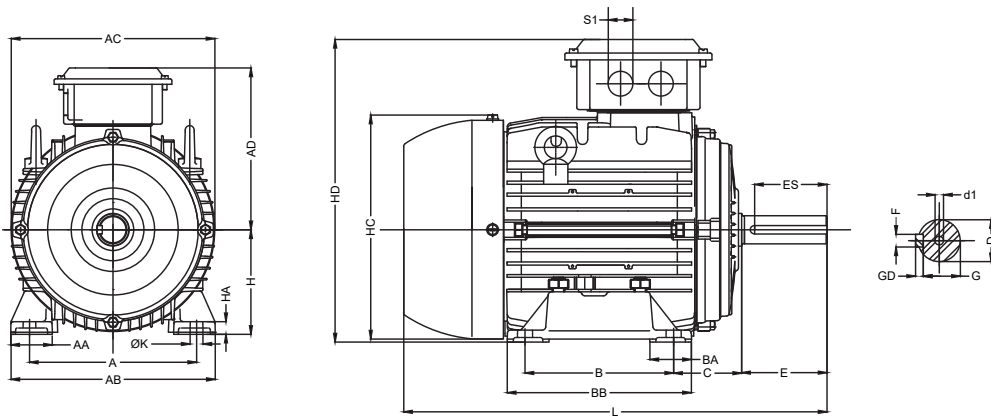

Frames 160M to W315S/M

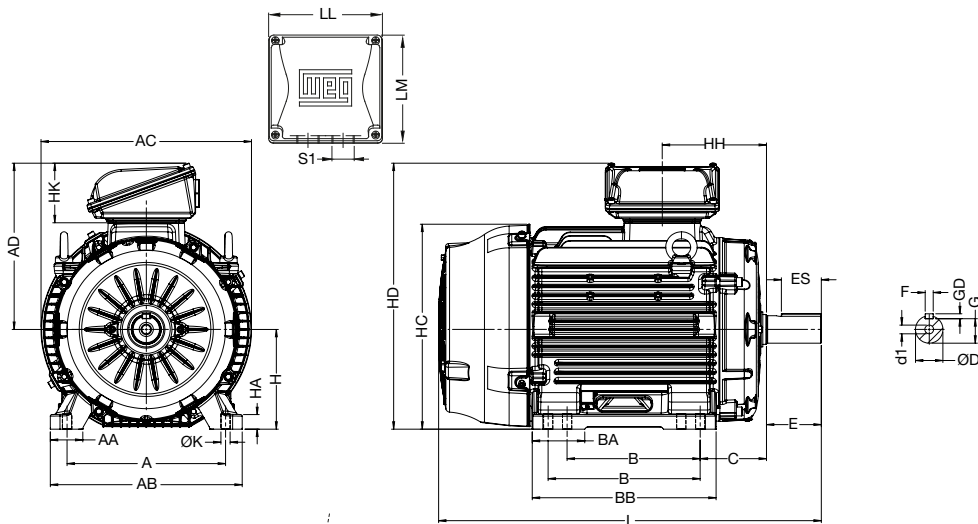

Frames 315S/M to 355M/L

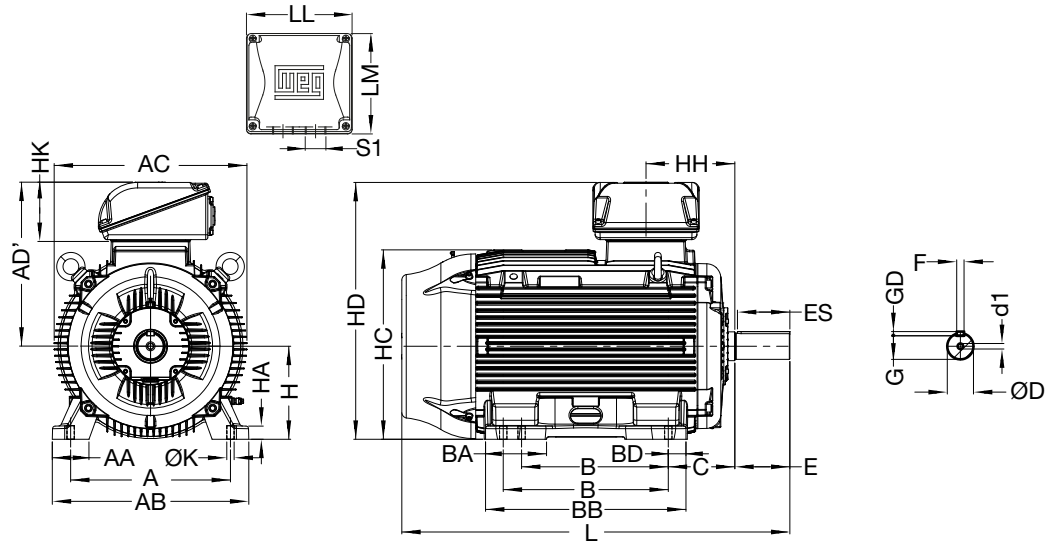

Frames	Feet											Terminal Box					Key			
	A	B	K	C	H	AA	AB	BA	BD	BB	HA	LL	LM	HK	HH	S1	F	GD	G	ES
Mounting	Only with feet											All								
IEC56	90	71	6,6	36	56	26	110	23,3	14,3	95	6,5	97	86,5	51	47	22,4	3	3	7,2	12
W63	100	80	7	40	63	32	120	30	11	104	6,7				56		4	4	8,5	14
W71	112	90		45	71	38	132	36	16	117	7,5	10	94	62	65	28,4/22,4	5	5	11	18
71			36	147	22	115	7	125	8											
80	125	100	10	50	80	41	155	30	10	125	8	103	94	62	65	28,4/22,4	6	6	15,5	28
90S/L	140	125		56	90	40	171	38	16,3	155	11,5						8	7	20	36
100L	160	140	12	63	100	45	187	38,5	18	175	11,5	131	122	73,5	85	34,4	8	7	24	45
112M	190			70	112	63	246	45	24,5	200									8,5	10
132S/M	216	140/178		89	132	65	279	90	23	230	12									

Frames	Shaft						Feet														S1	CG***	d1	Bearing			
	D	E	ES	F	G	GD	A	AA	AB	AC	AD	B	BA	BB	C	H	HA	HC	HD	K				L	DE	NDE	
80	19j6	40	28	6	15,5	6	125	32	155	159	136	100	28	124	50	80	8	157	216	10	276/**325	M24x1,5	10-15	DM6	6204-ZZ	6203-ZZ	
90S/L	24j6	50	36	8	20	7	140	35	170	179	146	100	49	146	56	90	9	177	236	10	330/**360			DM8	6205-ZZ	6204-ZZ	
100L	28j6	60	45	8	24	7	160	40	196	199	156	140	30	170	63	100	12	198	256	12	376/**418	2xM30x2	13-18	DM10	6206-ZZ	6205-ZZ	
112M	28j6	60	45	8	24	7	190	46	220	222	179	140	32	170	70	112	12	235	291	12	393/**422			DM10	6307-ZZ	6206-ZZ	
S132S												140	40									452	2xM30x2	13-18			
132S	38k6	80	63	10	33	8	216	44	248	270	207	140	32		89	132	12	274	344		490/**515	DM12			6308-ZZ	6307-ZZ	
132M												178	33	210								339					

***CG (cable gland) is optional. This is the inner diameter range, in mm.
If the cable size exceeds this range, please contact the relevant sales personnel.

Frames	Feet											Terminal Box					Key						
	A	B	K	C	H	AA	AB	BA	BD	BB	HA	LL	LM	HK	HH	S1	F	GD	G	ES			
Mounting	Only with feet											All											
90S/L	140	125	10	56	90	40	171	38	16,25	155	12	91	94	65	70	22,4	8	7	20	36			
100L	160	140	12	63	100	45	187	38,5	18	175	12				65						4	4	8,5
112M	190			140/178	12	70	112	63	246	45	24,5	200	9	119	122	69	88	22,4	10	8	33	63	
132S/M	216	89	132			65	279	90	23	230	12	94	6				6						15,5
160M	254	210	14,5	108	160	36	292	-	-	-	-	198,5	190	102	213	2xM40x1,5	12	8	37	80			
160L		254													290						17	187	
180M		241													288						19	242	213
180L		279													325						19	213	213
200M/L	318	267/305	18,5	133	200	65	385	105	369	30	230	220	119	209	2xM50x1,5	16	10	49	100				
225S/M¹	356	286/311		149	225	80	436	102	395	28	204												
225S/M			406	311/349	168	250	100	506	135	447	30	269	285	151	217	2xM63x1,5	18	11	53	125			
250S/M¹	457	368/419																			190	280	557
W280S/M¹			508	406/457	24	216	315	120	630	184	626	48	379	382	176	264	2xM63x1,5	18	11	58			
W280S/M	508	406/457																			28	216	315
W315S/M¹			508	406/457	28	216	315	120	630	184	626	48	379	382	176	264	2xM63x1,5	18	11	58			
W315S/M	508	406/457																			28	216	315
315S/M¹			508	406/457	28	216	315	120	630	184	626	48	379	382	176	264	2xM63x1,5	18	11	58			
315L¹	508	406/457																			28	216	315
315L			508	406/457	28	216	315	120	630	184	626	48	379	382	176	264	2xM63x1,5	18	11	58			
355M/L¹	610	560/630																			28	254	355
355M/L			28	16	90	200																	

Frames	Shaft end			External												Bearings																	
	E	D	d1	L	AC	AD	HC	HD	AC	AD	HB	HC	HD	AC	AD	HD	D.E.	N.D.E.															
Mounting	All			Top				Sideway				Footless				All																	
IEC56	20	9j6	M3	See the Electric table	110	111	114	167	110	111	-	114	-	110	111	166	6201-ZZ	6201-ZZ															
W63	23	11j6	M4		120		124	176	120			124		120		120			120														
W71	30	14j6	M5		132		129	184	132			129		129		132			132														
71					276		141	215	141			141		141		141			141	141													
80	40	19j6	M6	305	180	144	150	224	140	144	-	150	-	140	144	211	6204-ZZ	6202-ZZ															
90S/L	50	24j6	M8	364			160	185	250			180		160	185	202			180	160	249	6205-ZZ	6205-ZZ										
100L	60	28j6	M10	374	158	190	260	158	158	190	212	158	253	6206-ZZ	6206-ZZ																		
112M				422	225	194	233	306	225	194	233	244	225	194		305	6207-ZZ	6206-ZZ															
132S/M	80	38k6	M12	See the Electric table	265	214	273	346	265	214	-	273	278	265	214	345	6208-ZZ	6207-ZZ															
160M	110	42k6	M16	620	358	277	332	437	358	277		341	72	394	362	277	448	6209-ZZ-C3	6209-ZZ-C3														
160L				664																664	664	664	664	664	664	664	664	664	664	664	664	664	664
180M				684																388	293	366	473	388	293	377	92	430	393	293	478	6211-ZZ-C3	6212-ZZ-C3
180L				722							770									422	333	411	533	422	333	414	101	476	428	333	540	6212-ZZ-C3	
200M/L	140	55m6	M20	856	488	395	469	620	488	395	468	105	539	488	395	639	6214 C3	6212 C3															
225S/M ¹				886															965	528	415	514	665	528	415	508	130	579	528	415	679		
225S/M	140	60m6	M20	993	599	786	615	786	599	445	615	421	735	599	786	1086	6314 C3	6314 C3															
250S/M ¹				965															993	544	695	538	160	609	6314 C3								
250S/M	140	65m6	M20	1123 ³	599	786	615	786	599	445	615	421	735	599	786	1086	6314 C3	6314 C3															
W280S/M ¹				1153 ³															1244	845	845	845	845	845	845	845	845	845	845	845	845	845	845
W280S/M	140	80m6	M20	1274	657	891	644	845	657	525	644	386	768	657	845	845	6319 C3	6316 C3															
W315S/M ¹				1355															1274	845	845	845	845	845	845	845	845	845	845	845	845	845	
W315S/M	170	80m6	M24	1385	736	975	723	975	736	609	723	461	898	736	975	975	6316 C3	6314 C3															
315S/M ¹	140	65m6		1412															891	891	891	891	891	891	891	891	891	891	891	891			
315S/M	170	80m6	M24	1482	736	975	723	975	736	609	723	461	898	736	975	975	6322 C3	6319 C3															
315L ¹	140	65m6		1482															891	891	891	891	891	891	891	891	891	891	891	891			
315L	170	80m6	M24	1482	736	975	723	975	736	609	723	461	898	736	975	975	6322 C3	6319 C3															
355M/L ¹	140	75m6		1482															891	891	891	891	891	891	891	891	891	891	891	891			
355M/L	210	100m6	M24	1482	736	975	723	975	736	609	723	461	898	736	975	975	6322 C3	6319 C3															

Notes:

1) Dimensions for 2 pole motors.

2) All dimensions are in mm.

3) For 2-pole footless motors in W315S/M frame, the dimension L is 1073 mm. For 4-pole footless motors in W315S/M frame, the dimension L is 1103 mm.

3.2 Flange Mounted Motors

3.2.1 "FF" Flange

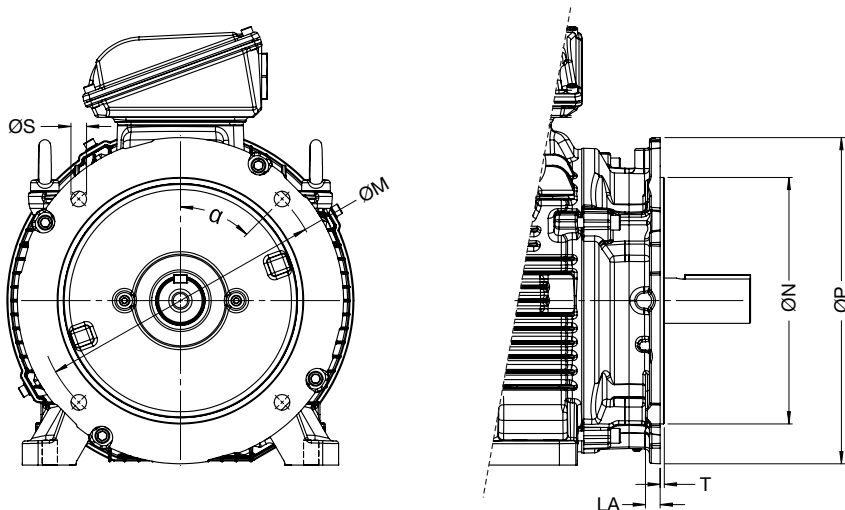

Frame	Flange	LA	M	N	P	S	T		N° of holes		
63	FF-115	9	115	95	140	10	3	45°	4		
71	FF-130	8	130	110	160		3,5				
80	FF-165		10,2	165	130	200	12				
90S/L		FF-215		11	215	180	250			15	4
100L	FF-265		16		265	230	300			19	5
112M		FF-300		18	300	250	348				
132	FF-350		20		350	300	398				
160		FF-400		22	400	350	448				
180	FF-500		16		500	450	548				
200M/L		FF-600		22	600	550	660/780 ¹⁾				
225S/M	FF-740		16					740	680		
250S/M		FF-500		20	500	450	548				
280S/M	FF-600		22					600	550		
315S/M		FF-740		16	740	680	800/880 ¹⁾				
315L	FF-500		20					500	450	548	
355		FF-600		22	600	550	660/780 ¹⁾				

Notes:

- 1) Only for motors fitted with air deflector in drive end side.
- 2) All dimensions are in mm.

3.2.2 "C-DIN" Flange

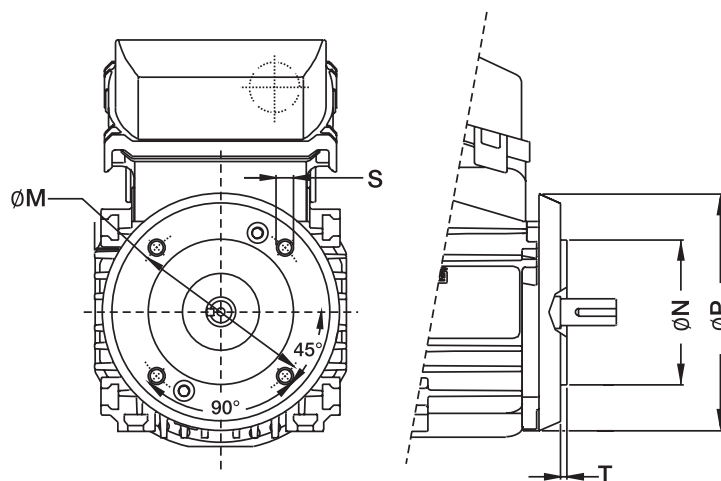

Frame	Flange	LA	M	N	P	S	T	α	N° of holes
IEC56	C-80	11,5	65	50	95	M5 ⁽²⁾	2,5	45°	4
W63	C-90	9	75	60	98	M5			
W71	C-105	11,5	85	70	108	M6 ⁽²⁾	3		
71		12							
80	C-120	22	100	80	170,5	M8	3,5		
90S/L	C-140		115	95					
100L	C-160	22	130	110	221,5	M10	4		
112M			165	130					
132	C-200	18	215	180	250	M12	4		
160	C-250		215	180	250	M12	4		

Notes:

- 1) All dimensions are in mm
- 2) Holes are able to bolts.

Flange runout

Frame	Flange Material	Runout	Maximum (mm)
IEC56, W63 and W71	Aluminum	Radial	0,18
		Axial	0,11
	Polymeric	Radial	0,50
		Axial	0,90
71 80 90S/L 100L and 112M	Aluminum machined	Radial	0,1
		Axial	0,1
132S/M		Radial	0,125
		Axial	0,125

Notes:

Other frame sizes follows IEC 60072-1

The scope of WEG Group solutions is not limited to the products and solutions presented in this brochure.

To know our portfolio, contact us.

For WEG's worldwide operations visit our website



www.weg.net



+55 47 3276.4000

motores@weg.net

Jaraguá do Sul - SC - Brazil

Cod: 50129304 | Rev: 01 | Date (m/y): 10/2023.

The values shown are subject to change without prior notice.
The information contained is reference values.