

**CWBC**10006977751.02
WEG Automação
www.weg.net**ATENÇÃO:**

- Desconectar da rede elétrica antes de proceder qualquer trabalho neste equipamento.
- Somente profissionais qualificados podem efetuar a instalação e manutenção.
- Obedecer normas nacionais, estaduais, locais e instruções de operação.

WARNING:

- Installation and maintenance to be performed by authorized personnel only.
- User is cautioned to observe all recommendations, warnings and cautions relating to safety of personnel and equipment as well as general and local health and safety laws, codes and procedures.

ATENCIÓN:

- Desconectar de la red eléctrica antes de hacer cualquier trabajo en este equipamiento.
- Recomendase instalación por profesional calificado.
- Respetar normas nacionales y locales.
- Producto destinado a utilización en instalaciones eléctricas de baja tensión.

WARNING:

- Bevor irgend eine Arbeit am Gerät vorgenommen wird, muss sichergestellt sein, dass die Einheit stromlos und freigeschaltet ist.
- Sämtliche Arbeiten an der Einheit dürfen daher ausschließlich nur von Fachpersonal vorgenommen werden.
- Die jeweils geltenden nationalen, örtlichen und anlagenspezifischen Bestimmungen und Erfordernisse sind zu berücksichtigen.

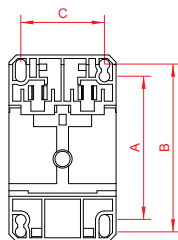

	mm in		
	A	B	C
CWBC9...32	60 2.36	70 2.75	35 1.38
CWBC50...65	95 3.74	105 4.13	45 1.77
CWBC95...125	-	111 4.33	61 2.36

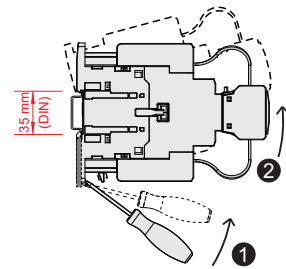
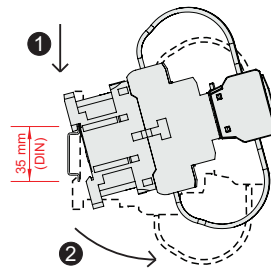
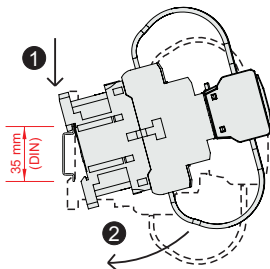
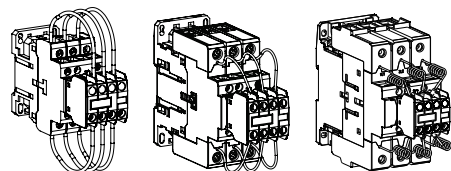
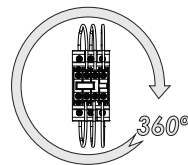
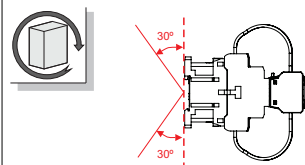
**GARANTIA / WARRANTY / GARANTÍA / GEWÄHRLEISTUNG:**

A WEG oferece garantia limitada contra defeitos de fabricação ou de materiais de seus produtos. Para mais informações acesse nosso site:

WEG provides a limited warranty for its products against defects in materials and workmanship. For more information access our site:

WEG ofrece garantía limitada contra defectos de fabricación o de materiales de sus productos. Para más informaciones acceda al WEB sitio:

WEG bietet eine beschränkte Gewährleistung für ihre Produkte gegen Herstellungs- und Materialfehler. Für weitere Informationen besuchen Sie bitte unsere Webseite:

www.weg.net/warranty-automation

CWBC9 CWBC18	mm² AWG	1...6 18...10	1...4 18...12	1,7 Nm 15 lb.in	PHILLIPS #2
	mm² AWG	1...6 18...10			
CWBC25 CWBC32	mm² AWG	1,5...10 16...8	1,5...6 16...10	2,5 Nm 22 lb.in	PHILLIPS #2
	mm² AWG	2,5...10 14...8			
CWBC50 CWBC65	mm² AWG	2,5...35 14...2		5 Nm 45 lb.in	ALLEN 4 mm
	mm² AWG				
CWBC95 CWBC125	mm² AWG	2,5...70 14...2/0		6 Nm 53 lb.in	ALLEN 4 mm
	mm² AWG				

PHILLIPS #2	1,0 Nm 8,8 lb.in	2 X 1...2,5mm² 1 X 1...4mm² 2 X 18...14AWG 1 X 18...12AWG

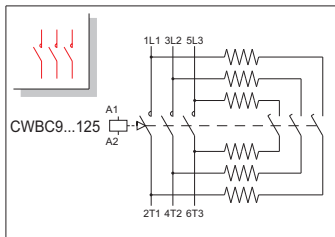

-PROIBIDO ACCIONAMIENTO MANUAL.
-MANUAL ACTIVATION IS PROHIBITED.
-ACTIVACIÓN MANUAL ESTÁ PROHIBIDA.
-MANUELLE AKTIVIERUNG IST VERBOTEN.



Substituição de contatos não permitida
 Changing contacts is not allowed
 Cambio de contactos prohibido
 Kontaktaustausch nicht erlaubt

O contator CWBC não permite contato auxiliar adicional
 The CWBC contactor does not allow additional auxiliary contact.
 El contactor CWBC no permite contacto auxiliar adicional.
 Das CWBC-Schütz erlaubt keinen zusätzlichen Hilfskontakt.

Não retirar as resistências
 Don't remove resistance wires
 No desconectar las resistencias
 Widerstandsdrähte nicht abkleimen

-O terminal garfo do resistor nunca poderá ser montado acima do cabo.
 -El terminal de horquilla de la resistencia nunca debe montarse por encima del cable.
 -Der Gabelanschluss des Widerstands darf niemals über dem Kabel montiert werden.

CWBC50...65 CWBC95...125 CWBC9...32

mm in	CWBC9...18	CWBC25...32	CWBC50...65	CWBC95...125
	AC DC AC DC AC DC AC DC AC DC	AC DC AC DC AC DC AC DC AC DC	AC DC AC DC AC DC AC DC AC DC	AC DC AC DC AC DC AC DC AC DC
A	45 1,77		53,8 2,11	72 2,83
B	125,8 4,95	134,6 5,29	131,9 5,19	141,1 5,55
C		152 5,98	115 4,52	149 5,87

WEG IMPORTERS IN THE EUROPEAN UNION

AUSTRIA - WATT DRIVE ANTRIEBSTECHNIK GMBH - Wöllersdorfer Str. 68, 2753 Markt Piesting, Wiener, Austria; **BELGIUM** - WEG BENELUX S.A. - Rue de l'Industrie 30/D, 1400 Nivelles, Belgium; **FRANCE** - WEG FRANCE SAS - 13 Rue du Morellon, 38297 Saint Quentin Fallavier, France; **GERMANY** - WEG GERMANY GMBH - Geigerstraße 7, 50169 Endenriederweg Tümmich 3, Kerpen, Germany; **ITALY** - WEG ITALIA S.R.L. - Via Viganò de Vizzi, 93/95, 20092 Cinisello Balsamo, Milano, Italy; **NETHERLANDS** - WEG NETHERLANDS - Hanzepoort 23C, 7575 DB Oldenzaal, Netherlands; **PORTUGAL** - WEG EURO-INDUSTRIA ELECTRICA S.A. - R. Eng. Frederico Ulrich 605, 4471-908 Maia, Portugal; **SPAIN** - WEG IBERIA INDUSTRIAL S.L. - C/ Tierra de Barros, 5-7, 28823 Coslada, Madrid, Spain; **SCANDINAVIA** - WEG SCANDINAVIA AB - Box 27, 435 21, 43533 Mölnlycke, Sweden; **UNITED KINGDOM** - WEG (UK) LTD - Broad Ground Road, Redditch B988YP, Worcestershire, United Kingdom.

Information valid for WEG Group Importers.