

ELECTRIC MOTOR PRICE LIST

2023

JANUARY

ZEST

WEG Group



Visit our online shop: www.zestweg.com

MOTION FLEET MANAGEMENT

Connectivity for performance and condition monitoring



We are proud to announce our new Software as a Service called WEG Motion Fleet Management (MFM). The MFM is a new software for end-user asset fleet management, offering various features. This cloud-based solution is designed to perform the asset on-line monitoring, enabling the condition based maintenance with feasible cost and putting the industrial asset fleet management at next level. Using the MFM, the customer cuts down the fleet TCO (total cost of ownership).

MFM Sensor	<100	≥100	≥500
For motors and driven equipment such as compressors, pumps, gearboxes and fans.	R 6 900	R 6 555	R 6 210

Motot Scan Gateway	<100	≥100	≥500
For automatic scanning of sensors and data uploads to the MFM cloud. Up to 100 sensors and radius of 30m	R 32 200	R 29 210	R 25 990

MFM Subscription Plans		New sensor year 1	Year 2 and on	Replacement sensor year 1
Management Plan per sensor/year Inclusive of management plan	Fleet overview, alarms, dashboards, on-line monitoring and fleet reports	Free	R 3 450	Free
Specialist Plan per sensor/year Inclusive of management plan	Advanced algorithms for failure diagnosis and consumption analysis	R 3 450	R 6 900	R 3 450
Exchange Module per sensor/year Inclusive of management plan	Data integration with third party's customer's systems	R 3 450	R 6 900	R 3 450

www.weg.net/wegmotorscan/en/how-it-works





CONTENTS

Branch Contact Details	04
Warranty Terms and Return Policy	06
Three Phase Cast Iron Motor IE4	07
Three Phase Cast Iron Motor IE3	11
Is Your Motor VSD Compatible?	20
Three Phase Cast Iron Motor IE1	21
Three Phase Aluminium Motor IE1	30
Single Phase Aluminium Motor	32
WEG Electronically Commutated Motor IE5	33
Brake Motor IE3	38
Flame Proof Motor W21X/W22X	39
Slide Rails	42
Invicta Vibrator Motor	43
Optional Features	46
Spare Parts for Cast Iron Motors	47
Dimensions for W22 Range Foot Mount	48
Dimensions for W22 Range Pad Mount	52
Dimensions for W22 Range Flange Mount	54
Dimensions for W22 Fans IE1 & IE3	55
W22 Motor Terminal Box Dimensions	56
Packaging Dimensions	57
Technical Information	58
Formulae	60
Mounting Configurations	61
Global Product Certification	62
Product Solutions Contact Details	63
National Distributor Contact Details	64
African Network Contact Details	65



— now you can —

SHOP ONLINE*

& compare products, download
motor data sheets, drawings
and manuals

www.zestweg.com

BRANCH CONTACT DETAILS

HEAD OFFICE

JOHANNESBURG

6 Laneshaw Street, Longlake Ext 4
Private Bag X10011, Sandton 2146
Tel +27 (0) 11 723 6000

LV MOTOR SALES

lvmotorsales@zestweg.com

HV MOTORS & PROJECTS

zpq@zestweg.com

DRIVES & AUTOMATION

drivesales@zestweg.com

DRIVES PROJECTS

projects@zestweg.com

SWITCHGEAR

switchgearsales@zestweg.com

GENERATOR SET DIVISION

gensets@zestweg.com

MOTOR TECHNICAL SUPPORT

ts-motors@zestweg.com

+27 (0) 83 635 0634

AFTER HOURS

MOTOR SALES

+27 (0)87 830 6616

TRANSFORMERS

+27 (0)72 616 2219

DRIVES & AUTOMATION

+27 (0) 82 887 2615

GENSETS

+27 (0) 83 326 6862

SWITCHGEAR

+27 (0) 72 628 8767

BRANCHES

CAPE TOWN

9 Omuramba Rd Marconi Beam
Monague Gardens, Milnerton
P.O Box 36582, Chempet 7442
Tel +27 (0) 21 551 2710
Fax +27 (0) 86 417 8153
capetown@zestweg.com

BRANCH MANAGER

Marthinus Greeff

+27 (0) 83 326 6870

AFTER HOURS

DRIVES & AUTOMATION

+27 (0) 79 830 0520

MOTORS

+27 (0) 76 042 9644

DURBAN

51 Island Circle, Riverhorse Valley Business Estate
P O Box 20667 Durban North 4016
Tel: +27 (0) 31 569 7260
Fax: +27 (0) 86 417 8424
durban@zestweg.com

REGIONAL MANAGER (KZN)

Glen Ward

+27 (0) 82 883 4070

AFTER HOURS

DRIVES & AUTOMATION

+27 (0) 82 301 6996

MOTORS

+27 (0) 82 570 0876

MIDDELBURG

6 Wicht Street, Vaalbank, Middelburg
Tel: +27 (0) 13 246 2849
Fax: +27 (0) 86 417 8404
mpumalanga@zestweg.com

BRANCH MANAGER

Fritz Hoogenboezem

+27 (0) 82 802 4805

AFTER HOURS

DRIVES & AUTOMATION

+27 (0) 82 885 2307

+27 (0) 82 889 3375

MOTORS

+27 (0) 76 042 9644

GQEBERHA

1 Millennium Road, Old Showgrounds, North End
P.O. Box 2565, North End 6056
Tel: +27 (0) 41 486 1262
Fax: + 27 (0) 86 417 8358
gqeberha@zestweg.com

BRANCH MANAGER

Pieter De Villiers

+27 (0) 72 058 8936

AFTER HOURS

DRIVES & AUTOMATION & MOTORS

+27 (0) 82 677 5491



RICHARDS BAY

100 Alumina Allee

Tel: +27 (0) 35 751 1607

Fax: +27 (0) 86 417 8296

richardsbay@zestweg.com

BRANCH MANAGER

Koos Robbetsse

+27 (0) 82 906 4616

AFTER HOURS

DRIVES & AUTOMATION & MOTORS

+27 (0) 82 802 1948

RUSTENBURG

6 Kgwebo Road, Mabe Business Park

Old Pretoria Road

P O Box 649, Rustenburg 0300

Tel: +27 (0) 14 594 0450

Fax: +27 (0) 86 417 8155

rustenburg@zestweg.com

BRANCH MANAGER AFTER HOURS

Leon Byleveldt

+27 (0) 78 804 0228

DRIVES & AUTOMATION & MOTORS

+27 (0) 82 881 1549

+27 (0) 72 611 6932

TRICHARDT

3 Schabort Street, Trichardt

P O Box 1626, Secunda 2302

Tel: +27 (0) 17 638 1571

Fax: +27 (0) 86 417 8336

trichardt@zestweg.com

BRANCH MANAGER AFTER HOURS

Richard Hudson

+27 (0) 87 405 4744

DRIVES & AUTOMATION & MOTORS

+27 (0) 82 803 5580

+27 (0) 17 638 1571

WARRANTY TERMS FOR LV ELECTRIC MOTORS, DRIVES AND CONTROLS.

These products, when operated under the conditions stipulated by WEG in the operating manuals carry a warranty against defects in workmanship and materials for the specified periods indicated below. The warranty period commences from the date of delivery or collection.

- o WEG W20, W21 and WGP Electric Motor ranges: 2 Years
- o WEG W22 Electric Motor range: 5 Years
- o WEG Variable Speed Drives and Soft Starters: 2 Years
- o WEG Variable Speed Drives or Soft Starters in combination with W22 motors: 3 Years
- o WEG Low Voltage Switchgear: 3 Years

This warranty does not apply to any product which has been subject to misuse, misapplication, neglect (including without limitation, inadequate maintenance, accident, improper installation, modification, unauthorised repair or any other case arising from incorrect application).

Zest WEG will not be held responsible for any expenses incurred in installation, removal from service, consequential expenses such as financial losses nor transportation costs as well as air tickets and accommodation expenses of a technician when this is requested by the customer.

The repair and/or replacement of parts or components, when approved by Zest WEG within the warranty period do not provide warranty extensions, unless otherwise expressed in writing by Zest WEG. This document constitutes Zest WEG only terms of warranty and is in lieu of all other warranties, expressed or implied, written or oral.

No employee, agent, dealer, repair shop or other person is authorized to give any warranties on behalf of Zest WEG or to assume on behalf of Zest WEG any other liability in connection with any of its products. In the event of this happening without Zest WEG's authorization, such warranty is automatically cancelled.

RETURN POLICY

WEG products that are purchased from Zest WEG may only be returned within 6 months from the date of purchase. Freight is to be paid by the customer. Returned products must be unused, and in undamaged original packaging. If the returned products are deemed not to be in an unused, undamaged condition, or in original packaging, then additional fees will be applied. Returns on any modified products will not be allowed. Any products that are ordered as a special (with features that would not allow them to be stocked items) cannot be returned. No returns are accepted on spare parts. A copy of the Dispatch note or Invoice is to accompany all returned goods.



THREE PHASE CAST IRON MOTOR

IE4 Super Premium Efficiency

W22



Minimum info required for orders and enquiries.

W22 IE4

kW	
Speed	
Voltage	
Mounting	

Reduces your energy costs
5 Year Warranty on W22 Range

IP66

Class H Insulation

Δ 380-415V or Y 660-690V 50Hz (225 to 355 frame)

Δ 460V – 60Hz (225 to 355 frame)

or

Δ 525-550V (225 to 355 frame)

Suitable for VSD

Electrically Insulated non-drive end bearing via end shield (\geq 315 frame)

Thermistors 01/ phase (225 to 355 frame)

Please refer to the Optional Features and Parts section for information on Optional Features.

Efficiency values are given according to IEC 60034-2-1, they are calculated according to indirect method with stray load losses determined by measurement.

Paint finish RAL 6018

Regreasable end shields (225 to 355 frame)

Removable gland plate (280 to 355 frame)

All prices and values are subject to change without prior notice.

THREE PHASE CAST IRON MOTOR IE4 SUPER PREMIUM EFFICIENCY W22 Class H Insulation

380V / 400V / 415V or 525V / 550V

IP66

2 Pole					Excl. VAT	
kW	r/min	Frame Size	Shaft (mm)	Weight (kg)	Foot Mounted	Flange Mounted
45	2970	225S/M	55	425	R 107 811	R 118 859
55	2970	250S/M	60	520	R 134 042	R 145 450
75	2970	250S/M	60	530	R 178 461	R 196 857
90	2980	280S/M	65	890	R 204 191	R 222 364
110	2980	280S/M	65	755	R 241 930	R 260 468
132	2983	315S/M	65	1095	R 281 889	R 303 966
160	2975	315S/M	65	1197	R 322 113	R 351 789
185	2984	315S/M	70	1315	R 382 955	R 398 896
200	2982	315S/M	70	1345	R 397 060	R 419 157
220	2987	355M/L	90	1500	R 524 030	R 544 823
250	2984	355M/L	90	1530	R 600 405	R 624 696
280	2986	355M/L	90	1664	R 684 106	R 718 665
300	2986	355M/L	90	1751	R 695 578	R 730 358
315	2986	355M/L	90	1838	R 719 238	R 748 520

4 Pole					Excl. VAT	
kW	r/min	Frame Size	Shaft (mm)	Weight (kg)	Foot Mounted	Flange Mounted
37	1485	225S/M	60	437	R 85 587	R 94 427
45	1485	225S/M	60	440	R 98 682	R 109 943
55	1487	250S/M	70	550	R 127 020	R 135 604
75	1488	L250S/M	70	634	R 151 731	R 165 039
90	1488	280S/M	80	895	R 174 719	R 187 721
110	1487	280S/M	80	895	R 209 549	R 227 264
132	1490	315S/M	85	1332	R 244 129	R 273 200
160	1490	315S/M	85	1145	R 271 540	R 295 788
185	1492	315S/M	90	1480	R 323 923	R 340 460
200	1490	315S/M	90	1527	R 336 485	R 352 722
220	1490	355M/L	100	1670	R 443 480	R 463 541
250	1493	355M/L	100	1730	R 503 097	R 552 736
260	1493	355M/L	100	1730	R 512 372	R 557 813
280	1492	355M/L	100	1772	R 554 970	R 582 668
300	1491	355M/L	100	1825	R 572 340	R 609 120
315	1493	355M/L	100	1878	R 605 104	R 635 596

Note: Prices Exclude VAT.



THREE PHASE CAST IRON MOTOR IE4 SUPER PREMIUM EFFICIENCY W22

IP66

Class H Insulation

380V / 400V / 415V or 525V / 550V

2 Pole															
			Current			Torque				Efficiency			Power Factor		
kW	Frame Size	r/min	400V In(A)	525V In(A)	Lock Rotor Current I/In	Full Load Torque Nm	Lock Rotor Torque Tl/Tn	Break-down Torque Tb/Tn	Allowed locked rotor time (s) Hot	50%	75%	100%	50%	75%	100%
										45	225S/M	2970	77.7	59.2	8.7
55	250S/M	2970	93.6	71.3	8.2	177	3.3	3.3	34	94.2	95	95.3	0.81	0.87	0.89
75	250S/M	2970	127	96.8	9.6	241	3	2.8	20	94.7	95.3	95.6	0.7	0.86	0.89
90	280S/M	2980	152	116	8.8	288	2.6	2.9	30	95.1	95.8	95.8	0.79	0.86	0.89
110	280S/M	2980	190	145	8.8	353	2.3	3	26	94.8	95.7	96	0.76	0.84	0.87
132	315S/M	2983	225	171	8.7	423	2.7	2.8	30	95.4	96.2	96.2	0.77	0.85	0.88
160	315S/M	2975	266	203	7.6	514	2	2.7	30	95.7	96.2	96.3	0.82	0.88	0.9
185	315S/M	2984	311	237	8.5	592	3	2.8	29	95.3	96.1	96.5	0.77	0.85	0.89
200	315S/M	2982	332	253	8.2	641	2.7	2.9	32	95.5	96.1	96.5	0.8	0.87	0.9
220	355M/L	2987	370	282	8.6	703	2.4	3.1	48	94.8	95.6	96.5	0.82	0.88	0.89
250	355M/L	2985	415	316	7.8	800	2.6	3	36	95	95.7	96.5	0.84	0.89	0.9
280	355M/L	2986	471	359	8.5	896	2.5	2.9	35	95.6	96.2	96.5	0.79	0.86	0.89
300	355M/L	2986	499	380	8.6	959	2.3	2.6	30	95.8	96.3	96.5	0.82	0.88	0.9
**315	355M/L	2986	548	418	8.5	1007	3.3	3.3	22	95	95.9	96.5	0.8	0.85	0.86

4 Pole															
			Current			Torque				Efficiency			Power Factor		
kW	Frame Size	r/min	400V In(A)	525V In(A)	Lock Rotor Current I/In	Full Load Torque Nm	Lock Rotor Torque Tl/Tn	Break-down Torque Tb/Tn	Allowed locked rotor time (s) Hot	50%	75%	100%	50%	75%	100%
										37	225S/M	1485	66.8	50.9	8.6
45	225S/M	1485	84.1	64.1	9	289	3.5	3.9	15	94.2	95	95.4	0.62	0.74	0.81
55	250S/M	1487	100	76.2	9	353	3.5	3.7	17	94.9	95.4	95.7	0.66	0.78	0.83
75	L250S/M	1488	141	105	10	481	4.3	4.4	14	94.8	95.4	96	0.61	0.73	0.8
90	280S/M	1488	157	120	7.9	578	2.6	2.9	30	95.9	96	96.1	0.73	0.82	0.86
110	280S/M	1487	194	148	8.6	706	3	3	33	95.8	96.3	96.3	0.73	0.82	0.85
132	315S/M	1490	230	175	7.5	846	2.8	2.7	30	96.1	96.4	96.4	0.73	0.82	0.86
160	315S/M	1490	278	212	7.6	1026	2.8	2.8	40	95.8	96.2	96.6	0.74	0.83	0.86
185	315S/M	1492	325	248	7.7	1184	3.1	3.1	35	96	96.5	96.7	0.7	0.8	0.85
200	315S/M	1490	347	264	7.9	1282	3	2.7	30	96.3	96.5	96.7	0.74	0.83	0.86
220	355M/L	1490	386	294	7.9	1410	2.6	2.8	36	95.9	96.6	96.9	0.72	0.81	0.85
250	355M/L	1493	450	343	8.2	1599	3	3	33	95.7	96.5	96.7	0.65	0.76	0.83
260	355M/L	1493	468	357	8.2	1663	2.7	2.8	33	95.7	96.5	96.7	0.67	0.78	0.83
280	355M/L	1492	492	375	7.9	1792	2.7	2.7	28	96.3	96.5	96.7	0.72	0.81	0.85
300	355M/L	1491	527	402	7.8	1922	2.4	2.6	24	96.4	96.5	96.7	0.73	0.82	0.85
315	355M/L	1493	566	431	7.8	2015	2.9	2.9	27	96.1	96.6	96.7	0.66	0.77	0.83

(**) Fitted with air deflector on drive end shield

All values rated at 400V

THREE PHASE CAST IRON MOTOR IE4 SUPER PREMIUM EFFICIENCY W22

Class H Insulation

380V / 400V / 415V or 525V / 550V

IP66

6 Pole					Excl. VAT	
kW	r/min	Frame Size	Shaft (mm)	Weight (kg)	Foot Mounted	Flange Mounted
30	988	225S/M	60	430	R 112 124	R 126 159
37	988	250S/M	70	520	R 140 291	R 153 966
45	990	L250S/M	70	723	R 171 162	R 188 373
55	990	280S/M	80	740	R 189 878	R 204 868
75	992	315S/M	85	1106	R 225 391	R 243 820
90	991	315S/M	85	1180	R 272 828	R 297 228
110	991	315S/M	90	1320	R 327 616	R 353 684
132	993	315S/M	90	1384	R 378 112	R 389 458
160	994	355M/L	100	1448	R 435 683	R 450 505
185	994	355M/L	100	1854	R 436 312	R 468 940
200	995	355M/L	100	1912	R 482 528	R 510 830
220	994	355M/L	100	1970	R 637 698	R 701 055

Note: Prices Exclude VAT.

THREE PHASE CAST IRON MOTOR IE4 SUPER PREMIUM EFFICIENCY W22

Class H Insulation

380V / 400V / 415V or 525V / 550V

IP66

6 Pole															
			Current			Torque			Allowed locked rotor time (s) Hot	Efficiency			Power Factor		
kW	Frame Size	r/min	400V In(A)	525V In(A)	Lock Rotor Current I _L /I _n	Full Load Torque Nm	Lock Rotor Torque T _L /T _n	Break-down Torque T _b /T _n		50%	75%	100%	50%	75%	100%
30	225S/M	988	54,7	41,7	7,4	290	3	3	27	93.7	94.1	94.2	0.69	0.79	0.84
37	250S/M	988	66,5	50,7	7,5	358	2,7	3	30	94.3	94.7	94.5	0.7	0.81	0.85
45	L250S/M	990	85,6	65,2	7,0	434	2.3	2.8	38	94.4	95	94.8	0.65	0.75	0.8
55	280S/M	990	104	79,2	7,2	531	2.6	3	30	94.6	95.1	95.1	0.64	0.74	0.8
75	315S/M	992	138	105	7,3	722	2	2.5	30	94.9	95.4	95.4	0.67	0.77	0.82
90	315S/M	991	164	125	6,7	867	2.1	2.4	30	95.2	95.6	95.6	0.69	0.79	0.83
110	315S/M	991	202	154	6,9	1060	2.1	2	30	95	95.8	95.8	0.67	0.77	0.82
132	315S/M	993	245	187	7,2	1269	2.4	2.6	30	95	95.9	96	0.66	0.77	0.81
160	355M/L	994	307	234	6,6	1537	2	2.4	36	94.9	95.6	96.2	0.61	0.72	0.78
185	355M/L	994	342	261	6,6	1777	2.1	2.4	30	95.6	96.2	96.3	0.64	0.75	0.81
200	355M/L	995	379	289	6,6	1920	2.3	2.6	72	95	96	96.3	0.64	0.74	0.79
220	355M/L	994	407	310	6,5	2114	2.0	2.4	30	95.6	96.2	96.3	0.65	0.76	0.81

All values rated at 400V

The highlighted frame sizes are bigger than the frames of IE3 motors



THREE PHASE CAST IRON MOTOR

IE3 Top Premium Efficiency

W22



Minimum info required for orders and enquiries.

W22 IE3

kW	
Speed	
Voltage	
Mounting	

Reduces your energy costs

5 Year Warranty on W22 Range

IP66

Class H Insulation

Δ 220-240V or Y 380-415V 50Hz (63 to 100 frame)

Δ 380-415V or Y 660-690V 50Hz (112 to 355 frame)

Δ 460V – 60Hz (112 to 355 frame)

or

Δ 525-550V (63 to 132 frame)

Δ 525-550-575V/1000V (160 to 355 frame)

Suitable for VSD

Electrically Insulated non-drive end bearing via end shield (\geq 315 frame)

Thermistors 01/ phase (225 to 355 frame)

Please refer to the Optional Features and Parts section for information on Optional Features.

Efficiency values are given according to IEC 60034-2-1, they are calculated according to indirect method with stray load losses determined by measurement.

Paint finish RAL 6002

Regreasable end shields (225 to 355 frame)

Removable gland plate (355 frame)

All prices and values are subject to change without prior notice.

THREE PHASE CAST IRON MOTOR IE3 TOP PREMIUM EFFICIENCY W22

Class H Insulation

380V / 400V / 415V or 525V / 550V / 1000V

IP66

2 Pole					Excl. VAT	
kW	r/min	Frame Size	Shaft (mm)	Weight (kg)	Foot Mounted	Flange Mounted
0.18	2860	63	11	7.6	R 3 610	R 4 573
0.25	2805	63	11	7.8	R 3 742	R 4 673
0.37	2820	71	14	10.1	R 4 530	R 5 657
0.55	2770	71	14	11	R 4 556	R 5 682
0.75	2850	80	19	14	R 5 900	R 7 393
1.1	2830	80	19	14.8	R 6 268	R 7 796
1.5	2875	90S	24	21.5	R 6 635	R 8 032
2.2	2865	90L	24	25	R 8 408	R 10 148
3	2910	100L	28	32.8	R 10 030	R 11 927
4	2900	112M	28	42.5	R 11 351	R 13 149
5.5	2940	132S	38	61	R 13 804	R 15 926
7.5	2935	132S	38	68.6	R 16 255	R 18 622
9.2	2935	132M	38	83.2	R 22 648	R 26 366
11	2950	160M	42	113	R 28 999	R 33 042
15	2945	160M	42	120	R 35 795	R 40 715
18.5	2945	160L	42	135	R 43 656	R 48 433
22	2950	180M	48	166	R 54 270	R 59 907
30	2965	200L	55	230	R 67 094	R 74 978
37	2960	200L	55	246	R 79 134	R 88 287
45	2960	225S/M	55	396	R 107 811	R 118 859
55	2965	250S/M	60	466	R 134 042	R 145 450
75	2965	250S/M	60	500	R 178 461	R 196 857
90	2975	280S/M	65	717	R 204 191	R 222 364
110	2975	280S/M	65	790	R 241 930	R 260 468
132	2980	315S/M	65	950	R 281 889	R 303 966
160	2980	315S/M	65	1079	R 322 113	R 351 789
185	2980	315S/M	70	1123	R 382 955	R 398 896
200	2975	315S/M	70	1200	R 397 060	R 419 157
220	2985	355M/L	90	1600	R 524 030	R 544 823
220	2980	315L	70	1320	R 486 721	R 511 619
250	2985	355M/L	90	1750	R 600 405	R 624 696
250	2980	315L	70	1350	R 516 951	R 540 207
280	2980	315L	70	1550	R 633 431	R 665 431
300	2985	355M/L	90	1850	R 695 578	R 730 358
315	2983	355M/L	90	1950	R 719 238	R 748 520
355	2988	355M/L	90	1950	R 816 934	R 850 191
400	2985	355A/B	90	2250	R 936 951	R 975 271
450	2985	355A/B	90	2400	R 1 009 542	R 1 050 421

Note: Prices Exclude VAT.

THREE PHASE CAST IRON MOTOR IE3 TOP PREMIUM EFFICIENCY W22

Class H Insulation

380V / 400V / 415V or 525V / 550V / 1000V

IP66

kW	Frame Size	r/min	Current			Torque			Allowed locked rotor time (s) Hot	Efficiency			Power Factor		
			400V In(A)	525V In(A)	Lock Rotor Current I/In	Full Load Torque Nm	Lock Rotor Torque Tl/Tn	Break-down Torque Tb/Tn		50%	75%	100%	50%	75%	100%
			0.18	63	2860	0.53	0.41	5.2		0.60	3	3.2	22	61.0	65.9
0.25	63	2805	0.67	0.51	5.5	0.85	3.2	3.2	17	63.0	68.0	69.7	0.54	0.68	0.77
0.37	71	2820	0.85	0.65	6	1.25	2.5	2.5	12	73.0	73.8	73.8	0.66	0.79	0.85
0.55	71	2770	1.19	0.91	5.9	1.90	3	3	18	75.0	76.0	77.8	0.68	0.81	0.86
0.75	80	2850	1.63	1.24	7.5	2.51	3.9	3.5	25	80.0	82.0	81.0	0.63	0.75	0.82
1.1	80	2830	2.33	1.78	7.4	3.71	3.6	3.6	23	81.0	83.5	83.0	0.63	0.76	0.82
1.5	90S	2875	5.37	2.35	7.6	4.98	3.3	3.3	15	83.0	85.0	84.5	0.64	0.76	0.83
2.2	90L	2865	4.43	3.38	7.5	7.33	3.1	3.4	12	85.5	86.0	86.3	0.65	0.77	0.83
3	100L	2910	5.77	4.40	8.5	9.85	3.4	3.4	15	85.5	87.3	87.3	0.69	0.81	0.86
4	112M	2900	7.59	5.78	7.7	13.2	2.9	3.5	22	88.0	88.4	88.4	0.69	0.80	0.86
5.5	132S	2940	10.6	8.08	7.9	17.9	2.4	3.5	12	86.9	88.7	89.4	0.66	0.78	0.84
7.5	132S	2935	14.1	10.7	8.5	24.4	3	3.6	10	88.5	89.8	90.3	0.68	0.80	0.85
9.2	132M	2935	16.6	12.6	8.5	29.9	2.8	3.1	16	90.4	91.1	90.7	0.75	0.84	0.88
11	160M	2950	20.0	15.2	8	35.6	2.8	3.4	12	90.3	91.4	91.4	0.71	0.82	0.87
15	160M	2945	27.7	21.1	8.3	48.6	2.8	3.5	8	90.9	91.8	92.1	0.67	0.79	0.85
18.5	160L	2945	33.9	25.8	8.6	60.0	3.1	3.7	6	91.5	92.3	92.6	0.69	0.80	0.85
22	180M	2950	39.7	30.2	8.3	71.2	2.7	3.6	6	92.3	93.0	92.9	0.69	0.80	0.86
30	200L	2965	54.5	41.5	7.7	96.6	3	3	16	92.2	93.2	93.5	0.69	0.80	0.85
37	200L	2960	67.8	51.7	7.7	119	3.1	3	13	92.6	93.4	93.8	0.69	0.79	0.84
45	225S/M	2960	77.5	59.0	7.7	145	2.4	3.1	13	94.2	94.5	94.2	0.78	0.86	0.86
55	250S/M	2965	96.7	73.7	8	177	2.8	3.3	19	93.5	94.0	94.4	0.77	0.84	0.87
75	250S/M	2965	128	97.5	8.5	242	3	3.2	11	94.0	94.6	94.9	0.82	0.87	0.89
90	280S/M	2975	153	117	7.6	289	2.1	3.1	27	94.3	95.2	95.2	0.81	0.87	0.89
110	280S/M	2975	187	142	7.5	353	2.1	3	20	95.0	95.5	95.4	0.80	0.87	0.89
132	315S/M	2980	224	171	7.6	423	2.1	3.1	34	94.5	95.4	95.6	0.78	0.86	0.89
160	315S/M	2980	271	206	7.4	513	2	2.9	28	95.1	95.8	95.8	0.79	0.86	0.89
185	315S/M	2980	313	238	7.6	593	2.3	3.1	22	95.4	95.8	95.8	0.79	0.86	0.89
200	315L	2975	334	254	7.6	642	2.3	2.9	23	95.7	96.2	96.0	0.82	0.88	0.90
220	355M/L	2985	363	277	7.3	704	1.9	2.6	35	95.0	95.6	96.0	0.85	0.89	0.91
220	315L	2980	368	280	8.5	705	2.7	3.3	23	95.9	96.0	96.0	0.81	0.88	0.90
250	355M/L	2985	413	315	7.7	800	2.4	2.7	30	95.0	95.6	96.0	0.85	0.89	0.91
250	315L	2980	413	315	7.8	801	2.7	2.9	21	96.3	96.0	96.0	0.85	0.90	0.91
280	315L	2980	463	353	7.5	897	2.5	2.7	22	95.4	95.8	96.0	0.84	0.89	0.91
300	355M/L	2985	496	378	8	960	2.3	2.9	22	95.4	95.8	96.0	0.84	0.89	0.91
**315	355M/L	2983	520	396	7.7	1008	2.6	2.7	23	95.5	96.0	96.0	0.87	0.90	0.91
**355	355M/L	2988	594	453	9.5	1135	2.6	3.2	14	95.3	95.6	95.8	0.82	0.88	0.90
**400	355A/B	2985	658	501	7.6	1280	2.4	2.8	31	95.8	96.2	96.4	0.85	0.89	0.91
**450	355A/B	2985	740	564	7.5	1440	2.5	2.7	31	95.8	96.2	96.4	0.85	0.90	0.91

(**) Fitted with air deflector on drive end shield
All values rated at 400V

THREE PHASE CAST IRON MOTOR IE3 TOP PREMIUM EFFICIENCY W22

Class H Insulation

IP66

380V / 400V / 415V or 525V / 550V / 1000V

4 Pole					Excl. VAT	
kW	r/min	Frame Size	Shaft (mm)	Weight (kg)	Foot Mounted	Flange Mounted
0.18	1370	63	11	14	R 3 610	R 4 573
0.25	1410	71	14	11.2	R 4 162	R 5 284
0.37	1385	71	14	11.4	R 4 285	R 5 410
0.55	1420	80	19	14.7	R 4 656	R 5 784
0.75	1430	80	19	15.9	R 5 332	R 6 665
1.1	1450	90S	24	21.1	R 5 884	R 7 146
1.5	1445	90L	24	24.6	R 7 393	R 8 621
2.2	1435	100L	28	32.5	R 8 639	R 10 350
3	1440	*L100L	28	38	R 9 979	R 11 824
4	1450	112M	28	45.7	R 11 452	R 13 149
5.5	1460	132S	38	66.3	R 13 928	R 15 926
7.5	1460	132M	38	75.1	R 17 055	R 19 680
9.2	1465	132M/L	38	85	R 23 514	R 27 500
11	1470	160M	42	125	R 26 854	R 30 401
15	1465	160L	42	147	R 34 840	R 39 101
18.5	1470	180M	48	171	R 42 777	R 48 010
22	1470	180L	48	193	R 51 681	R 57 565
30	1480	200L	55	245	R 61 825	R 69 265
37	1480	225S/M	60	389	R 85 587	R 94 427
45	1475	225S/M	60	417	R 98 682	R 109 943
55	1480	250S/M	70	507	R 127 020	R 135 604
75	1480	250S/M	70	530	R 151 731	R 165 039
90	1485	280S/M	80	788	R 174 719	R 187 721
110	1485	280S/M	80	800	R 209 549	R 227 264
132	1490	315S/M	85	1066	R 244 129	R 273 200
160	1490	315S/M	85	1171	R 271 540	R 295 788
185	1490	315S/M	90	1234	R 323 923	R 340 460
200	1485	315S/M	90	1332	R 336 485	R 352 722
220	1490	355M/L	100	1510	R 443 480	R 463 541
250	1490	355M/L	100	1550	R 503 097	R 552 736
260	1490	355M/L	100	1550	R 512 372	R 557 813
280	1490	355M/L	100	1600	R 554 970	R 582 668
300	1490	355M/L	100	1650	R 572 340	R 609 120
315	1491	355M/L	100	1750	R 605 104	R 635 596
330	1490	355M/L	100	1810	R 628 766	R 676 612
355	1490	355M/L	100	1878	R 675 604	R 702 940
400	1490	355A/B	100	2089	R 781 116	R 812 911
450	1490	355A/B	110*	2400	R 926 544	R 963 918
500 (a)	1490	355A/B	125*	2600	R 1 019 913	R 1 061 199

Motors from Frame Size 280S/M fitted with bearing shaft locking device for transport and should be removed only during installation.

(a) Temperature Rise 105K

Note: Prices Exclude VAT.

*** Oversized shaft for pulley belt applications**



THREE PHASE CAST IRON MOTOR IE3 TOP PREMIUM EFFICIENCY W22

Class H Insulation

380V / 400V / 415V or 525V / 550V / 1000V

IP66

kW	Frame Size	r/min	Current			Torque			Allowed locked rotor time (s) Hot	Efficiency			Power Factor		
			400V In(A)	525V In(A)	Lock Rotor Current I/In	Full Load Torque Nm	Lock Rotor Torque Tl/Tn	Break-down Torque Tb/Tn		50%	75%	100%	50%	75%	100%
			0.18	63	1370	0.52	0.39	4.7		1.25	2.1	2.4	30	65.0	67.0
0.25	71	1410	0.68	0.52	4.8	1.69	2.4	2.4	30	69.0	72.0	73.5	0.52	0.62	0.72
0.37	71	1385	0.99	0.75	4.8	2.55	2.8	2.9	30	73.0	75.0	77.3	0.50	0.62	0.70
0.55	80	1420	1.23	0.94	6.6	3.70	2.8	3	20	77.0	79.0	80.8	0.61	0.74	0.80
0.75	80	1430	1.64	1.25	7	5.01	3.2	3.4	18	80.0	82.0	82.5	0.59	0.71	0.80
1.1	90S	1450	2.35	1.79	7.6	7.24	2.5	2.9	15	83.0	84.5	84.5	0.59	0.72	0.80
1.5	90L	1445	3.17	2.42	7.4	9.91	2.6	3.0	13	84.0	86.0	85.5	0.58	0.72	0.80
2.2	100L	1435	4.56	3.47	7.4	14.6	3.2	3.5	18	86.5	87.0	87.0	0.60	0.73	0.80
3	*L100L	1440	6.15	4.69	7.8	19.9	3.9	3.2	15	87.0	88.0	88.0	0.60	0.73	0.80
4	112M	1450	8.23	6.27	7	26.3	2.3	3.1	15	88.7	89.1	88.8	0.60	0.72	0.79
5.5	132S	1460	10.4	7.92	8.3	36.0	2.1	3.3	12	89.0	89.6	89.7	0.69	0.80	0.85
7.5	132M	1460	14.2	10.8	8.3	49.1	2.4	3.5	7	90.5	90.8	90.6	0.63	0.76	0.84
9.2	132M/L	1465	17.4	13.3	8.6	60.0	2.8	3.5	10	90.3	91.0	91.0	0.64	0.76	0.82
11	160M	1470	20.9	15.9	7.5	71.5	2.8	3.2	11	91.1	91.8	91.6	0.65	0.77	0.83
15	160L	1465	27.9	21.3	7.2	97.8	2.8	3.1	8	92.2	92.5	92.3	0.67	0.78	0.84
18.5	180M	1470	35.1	26.7	7.4	120	3	3.2	13	92.2	92.8	92.8	0.64	0.76	0.82
22	180L	1470	41.0	31.2	7.3	143	3.4	3.4	11	92.3	93.0	93.2	0.66	0.77	0.83
30	200L	1480	57.1	43.5	7.5	194	2.8	3.1	12	92.9	93.6	93.7	0.63	0.75	0.81
37	225S/M	1480	66.8	50.9	7.7	239	2.8	3.3	13	93.4	94.0	94.1	0.70	0.80	0.85
45	225S/M	1475	80.9	61.6	7.5	291	2.8	3.1	14	93.7	94.1	94.4	0.71	0.81	0.85
55	250S/M	1480	98.6	75.1	7.5	355	2.8	3	14	94.3	94.7	94.7	0.69	0.80	0.85
75	250S/M	1480	131	99.8	7.8	484	2.8	3.3	8	94.5	94.8	95.0	0.73	0.83	0.87
90	280S/M	1485	158	120	7	579	2.2	2.5	30	94.9	95.4	95.4	0.75	0.83	0.86
110	280S/M	1485	193	147	7.7	707	2.5	2.9	19	95.3	95.6	95.6	0.73	0.82	0.86
132	315S/M	1490	231	176	7.5	846	2.5	2.7	30	95.1	95.7	95.8	0.74	0.82	0.86
160	315S/M	1490	280	213	7.7	1026	2.6	2.7	28	95.2	95.9	96.0	0.74	0.82	0.86
185	315S/M	1490	327	249	7.8	1186	2.7	2.9	25	95.5	96.1	96.0	0.71	0.80	0.85
200	315S/M	1485	346	264	6.7	1286	2.4	2.4	21	95.8	96.0	96.0	0.78	0.85	0.87
220	355M/L	1490	388	296	7.4	1410	2.2	2.5	20	96.0	96.6	96.2	0.72	0.80	0.85
250	355M/L	1490	436	332	7.3	1602	2.3	2.5	26	95.9	96.6	96.2	0.74	0.82	0.86
260	355M/L	1490	454	346	7.3	1666	2.3	2.5	26	95.9	96.6	96.2	0.74	0.82	0.86
280	355M/L	1490	488	372	7.3	1795	2.4	2.6	20	95.9	96.0	96.2	0.74	0.83	0.86
300	355M/L	1490	530	404	7.6	1923	2.3	2.5	19	95.8	96.0	96.2	0.71	0.80	0.85
315	355M/L	1491	562	428	7.9	2018	2.9	2.8	17	96.1	96.3	96.3	0.71	0.80	0.84
330	355M/L	1490	583	444	7.1	2115	2.5	2.5	20	95.8	96.0	96.2	0.71	0.82	0.85
**355	355M/L	1490	618	471	7.2	2275	2.4	2.5	15	95.9	96.5	96.4	0.74	0.83	0.86
**400	355A/B	1490	714	544	7.6	2564	2.6	2.9	20	95.7	96.1	96.2	0.68	0.79	0.84
**450	355A/B	1490	804	613	7	2884	2.8	2.8	20	95.8	96.1	96.2	0.69	0.80	0.84
**500	355A/B	1490	882	672	8.3	3205	2.8	2.8	22	95.9	96.3	96.3	0.72	0.81	0.85

(*) Letter "L" means in accordance with IE3 efficiency levels and increase in total length of motor.

(**) Fitted with air deflector on drive end shield

All values rated at 400V

THREE PHASE CAST IRON MOTOR IE3 TOP PREMIUM EFFICIENCY W22 Class H Insulation

IP66

380V / 400V / 415V or 525V / 550V / 1000V

6 Pole					Excl. VAT	
kW	r/min	Frame Size	Shaft (mm)	Weight (kg)	Foot Mounted	Flange Mounted
0.25	955	80	19	12	R 5 369	R 6 742
0.37	925	80	19	14.3	R 5 507	R 6 840
0.55	945	*L80	19	18.8	R 7 037	R 8 831
0.75	950	*L90S	24	24.2	R 7 549	R 9 099
1.1	945	*L90L	24	28.5	R 9 340	R 11 254
1.5	955	100L	28	33.5	R 10 180	R 12 345
2.2	960	112M	28	46	R 12 218	R 14 101
3	970	132S	38	61.5	R 15 203	R 17 734
4	965	132M	38	69.8	R 18 329	R 21 267
5.5	965	132M/L	38	78	R 21 222	R 24 840
7.5	975	160M	42	118	R 31 063	R 35 161
11	975	160L	42	143	R 46 464	R 52 396
15	975	180L	48	181	R 60 593	R 70 084
18.5	980	200L	55	222	R 68 211	R 77 152
22	980	200L	55	242	R 78 913	R 88 518
30	980	225S/M	60	404	R 112 124	R 126 159
37	985	250S/M	70	497	R 140 291	R 153 966
45	985	250S/M	70	490	R 171 162	R 188 373
55	990	280S/M	80	721	R 189 878	R 204 868
75	990	280S/M	80	725	R 225 391	R 243 820
90	990	315S/M	85	990	R 272 828	R 297 228
110	990	315S/M	85	1040	R 327 616	R 353 684
132	990	315S/M	85	1100	R 378 112	R 389 458
160	993	355M/L	100	1500	R 435 683	R 450 505
185	994	355M/L	100	1550	R 436 312	R 468 940
200	993	355M/L	100	1676	R 482 528	R 510 830
220	995	355M/L	100	1857	R 637 698	R 701 055
250	993	355M/L	100	1830	R 659 204	R 719 445
280	994	355M/L	100	1970	R 694 306	R 729 935
300	992	355M/L	100	2493	R 757 226	R 795 036
315	990	355M/L	100	2493	R 791 575	R 831 100
355	990	355A/B	100	2200	R 827 478	R 868 850
400(a)	990	355A/B	100	2346	R 865 013	R 908 260

Motors from Frame Size 280S/M fitted with bearing shaft locking device for transport and should be removed only during installation.

(a) Temperature Rise 105K

Note: Prices Exclude VAT.



THREE PHASE CAST IRON MOTOR IE3 TOP PREMIUM EFFICIENCY W22

Class H Insulation

380V / 400V / 415V or 525V / 550V / 1000V

kW	Frame	r/min	Current			Torque				Allowed locked rotor time (s) Hot	Efficiency			Power Factor		
			400V In(A)	525V In(A)	Lock Rotor Current I _L /I _n	Full Load Torque Nm	Lock Rotor Torque T _L /T _n	Break-down Torque T _b /T _n	50%		75%	100%	50%	75%	100%	
			0.25	80	955	0.74	0.56	4.3	2.50		1.7	2.4	25	63.6	68.5	68.8
0.37	80	925	0.97	0.74	4.5	3.82	1.9	2.1	25	66.0	69.5	73.5	0.51	0.65	0.75	
0.55	*L80	945	1.49	1.14	5.1	5.56	2.9	3.1	20	70.5	75.2	77.2	0.45	0.58	0.69	
0.75	*L90S	950	1.93	1.47	5.2	7.54	2.5	2.8	31	76.5	79.0	79.0	0.49	0.62	0.71	
1.1	*L90L	945	2.69	2.05	5.5	11.1	2.5	2.8	20	79.3	81.4	81.0	0.50	0.64	0.73	
1.5	100L	955	3.70	2.82	5.5	15.0	2.7	2.7	31	81.5	82.5	82.5	0.49	0.62	0.71	
2.2	112M	960	5.22	3.98	6	21.9	2.5	2.6	26	83.0	84.5	84.5	0.53	0.64	0.72	
3	132S	970	6.91	5.26	5.8	29.5	1.8	2.6	40	85.0	85.6	85.8	0.53	0.66	0.73	
4	132M	965	9.11	6.94	6.1	39.6	1.9	2.7	20	86.0	86.8	86.8	0.53	0.66	0.73	
5.5	132M/L	965	12.9	9.83	7	54.4	2.5	2.8	26	86.5	88.0	88.0	0.50	0.64	0.70	
7.5	160M	975	14.8	11.3	6.3	73.5	2.2	2.7	16	88.5	89.3	89.3	0.64	0.76	0.82	
11	160L	975	21.9	16.7	7.1	108	2.7	2.9	12	89.0	90.1	90.5	0.60	0.73	0.80	
15	180L	975	28.2	21.5	7.7	147	2.6	3.2	8	91.5	91.5	91.4	0.68	0.79	0.84	
18.5	200L	980	35.9	27.4	6.3	180	2.4	2.8	16	91.0	91.7	91.9	0.63	0.75	0.81	
22	200L	980	42.4	32.3	6.4	214	2.4	2.8	15	91.4	92.0	92.4	0.64	0.76	0.81	
30	225S/M	980	56.0	42.7	7.5	292	2.4	2.7	15	93.0	93.4	93.1	0.67	0.78	0.83	
37	250S/M	985	67.2	51.2	7.2	359	2.4	2.7	20	93.3	93.5	93.5	0.72	0.81	0.85	
45	250S/M	985	79.5	60.6	7.7	436	2.8	2.8	18	92.4	93.9	93.9	0.76	0.84	0.87	
55	280S/M	990	103	78.5	6.8	531	2.3	2.8	24	94.0	94.2	94.3	0.66	0.77	0.82	
75	280S/M	990	141	107	7.9	723	2.7	3.2	17	94.1	94.7	94.7	0.63	0.75	0.81	
90	315S/M	990	165	126	6.4	868	2.2	2.5	35	95.1	95.5	95.1	0.68	0.78	0.83	
110	315S/M	990	201	153	6.2	1061	2.1	2.4	31	95.4	95.6	95.3	0.70	0.80	0.83	
132	315S/M	990	243	185	7.2	1273	2.6	2.7	25	95.4	95.8	95.6	0.67	0.77	0.82	
160	355M/L	993	305	232	5.5	1539	1.8	2.1	33	94.9	95.6	95.8	0.63	0.74	0.79	
185	355M/L	994	362	276	6.6	1777	2.1	2.4	34	94.9	95.6	95.8	0.62	0.72	0.77	
200	355M/L	993	376	286	6.1	1923	2.1	2.3	39	95.5	96.0	95.9	0.66	0.76	0.80	
220	355M/L	995	419	319	6.5	2112	2	2.2	36	95.5	96.1	96.0	0.63	0.74	0.79	
250	355M/L	993	476	363	6.4	2404	2.2	2.3	38	95.7	95.9	95.9	0.64	0.75	0.79	
280	355M/L	994	526	401	6.5	2690	2.3	2.5	38	95.1	95.1	96.0	0.64	0.75	0.80	
300	355M/L	992	564	430	5.8	2888	1.9	2	25	95.8	96.0	96.0	0.63	0.74	0.80	
**315	355M/L	990	593	452	6.1	3039	2.1	2.1	25	95.2	95.8	95.8	0.66	0.76	0.80	
**355	355A/B	990	677	516	6.2	3424	2	2.3	29	95.3	95.7	95.8	0.63	0.74	0.79	
**400	355A/B	990	762	581	6.1	3859	2	2.3	29	95.4	95.8	95.9	0.63	0.74	0.79	

(*) Letter "L" means in accordance with IE3 efficiency levels and increase in total length of motor.

(**) Fitted with air deflector on drive end shield

All values rated at 400V

THREE PHASE CAST IRON MOTOR IE3 TOP PREMIUM EFFICIENCY W22 Class H Insulation

380V / 400V / 415V or 525V / 550V / 1000V

IP66

8 Pole					Excl. VAT	
kW	r/min	Frame Size	Shaft (mm)	Weight (kg)	Foot Mounted	Flange Mounted
0.37	700	90S	24	19	R 7 188	R 9 241
0.55	690	90L	24	23	R 7 818	R 9 550
0.75	710	100L	28	30.5	R 11 560	R 14 094
1.1	710	100L	28	33	R 12 286	R 15 024
1.5	705	112M	28	43	R 16 043	R 18 617
2.2	710	132S	38	69	R 19 111	R 22 378
3	710	132M	38	75	R 22 859	R 26 976
4	730	160M	42	114	R 31 815	R 36 999
5.5	725	160M	42	123	R 38 022	R 42 778
7.5	731	160L	42	145	R 46 347	R 52 429
11	730	180L	48	185	R 65 043	R 74 751
15	730	200L	55	220	R 70 700	R 83 661
18.5	735	225S/M	60	377	R 96 716	R 110 616
22	735	225S/M	60	402	R 115 956	R 132 908
30	730	250S/M	70	490	R 150 021	R 168 412
37	730	250S/M	70	550	R 185 256	R 205 728
45	740	280S/M	80	720	R 200 990	R 223 976
55	740	280S/M	80	812	R 230 780	R 259 701
75	740	315S/M	85	1025	R 286 027	R 316 864
90	740	315S/M	85	1100	R 330 642	R 360 118
110	740	315S/M	85	1360	R 373 832	R 414 017
132	745	355M/L	100	1587	R 411 963	R 445 101
160	745	355M/L	100	1747	R 650 860	R 730 202
185	745	355M/L	100	1819	R 678 005	R 760 760
200	745	355M/L	100	1891	R 706 162	R 770 420
220	744	355M/L	100	2020	R 729 626	R 818 199
250	744	355A/B	100	2092	R 754 229	R 839 664
280	745	355A/B	100	2279	R 857 276	R 954 382

Motors from Frame Size 280S/M fitted with bearing shaft locking device for transport and should be removed only during installation.

Note: Prices Exclude VAT.



THREE PHASE CAST IRON MOTOR IE3 TOP PREMIUM EFFICIENCY W22

Class H Insulation

380V / 400V / 415V or 525V / 550V / 1000V

kW	Frame	r/min	Current			Torque			Allowed locked rotor time (s) Hot	Efficiency			Power Factor		
			400V In(A)	525V In(A)	Lock Rotor Current I/In	Full Load Torque Nm	Lock Rotor Torque Tl/Tn	Break-down Torque Tb/Tn		50%	75%	100%	50%	75%	100%
			0.37	90S	700	1.24	0.95	3.7		5.05	2	2.3	30	61.0	66.0
0.55	90L	690	1.62	1.23	3.8	7.61	1.9	2.2	29	65.0	70.0	73.0	0.44	0.57	0.67
0.75	100L	710	2.31	1.76	4.6	10.1	1.9	2.3	30	72.5	75.5	75.5	0.41	0.53	0.62
1.1	100L	710	3.30	2.51	4.6	14.8	1.9	2	30	73.0	76.0	77.7	0.41	0.53	0.62
1.5	112M	705	3.98	3.03	5	20.3	2.5	2.8	28	79.0	79.5	79.9	0.45	0.59	0.68
2.2	132S	710	5.37	4.09	6.2	29.6	2.3	2.5	27	81.5	82.0	82.1	0.51	0.65	0.72
3	132M	710	7.20	5.49	6.4	40.4	2.4	2.6	21	82.5	83.5	83.5	0.51	0.64	0.72
4	160M	730	9.87	7.52	5	52.3	2.1	2.3	34	85.0	86.0	86.0	0.47	0.61	0.68
5.5	160M	725	12.5	9.52	5	72.4	2.1	2.3	28	86.0	87.3	87.3	0.52	0.65	0.73
7.5	160L	731	18.0	13.7	5.5	98.0	2.2	2.5	22	86.5	88.0	88.4	0.46	0.59	0.68
11	180L	730	23.3	17.8	6.5	144	2.3	2.7	12	88.7	89.2	89.7	0.55	0.68	0.76
15	200L	730	32.6	24.8	4.8	196	1.9	2.1	34	89.0	89.6	89.8	0.56	0.68	0.74
18.5	225S/M	735	36.5	27.8	6.5	240	1.7	2.5	28	89.8	90.3	90.3	0.63	0.75	0.81
22	225S/M	735	44.3	33.8	7	286	2.1	2.7	20	90.3	90.8	90.8	0.61	0.73	0.79
30	250S/M	730	57.0	43.4	7.4	392	1.9	2.8	18	91.0	91.5	91.5	0.66	0.77	0.83
37	250S/M	730	73.5	56.0	8	484	2.3	3	12	91.5	92.0	92.0	0.60	0.72	0.79
45	280S/M	740	89.0	67.8	6	581	1.8	2.2	30	92.2	92.4	92.4	0.63	0.73	0.79
55	280S/M	740	111	84.6	5.8	710	2	2.1	26	92.2	92.7	92.7	0.60	0.71	0.77
75	315S/M	740	145	110	6	968	1.8	2.2	40	92.8	93.3	93.3	0.65	0.75	0.80
90	315S/M	740	173	132	6	1161	1.9	2.2	40	93.1	93.6	93.6	0.65	0.75	0.80
110	315S/M	740	214	163	6	1420	1.9	2.2	35	93.4	93.9	93.9	0.64	0.74	0.79
132	355M/L	745	256	195	6.5	1692	1.3	2.3	48	93.7	94.2	94.2	0.64	0.74	0.79
160	355M/L	745	305	232	6.4	2051	1.3	2.3	56	94.0	94.5	94.5	0.64	0.75	0.80
185	355M/L	745	361	275	6.9	2371	2	2.9	56	93.4	94.7	94.7	0.63	0.73	0.78
200	355M/L	745	381	290	6.2	2564	1.3	2.3	56	94.3	94.8	94.8	0.65	0.76	0.80
220	355M/L	744	428	326	7	2824	1.8	2.8	30	94.8	95.1	95.2	0.60	0.72	0.78
**250	355A/B	744	479	365	6.2	3209	1.6	2.5	47	94.8	95.3	95.3	0.62	0.73	0.79
**280	355A/B	745	551	420	7.8	3589	2.2	3.1	30	94.1	95.1	95.3	0.61	0.71	0.77

(**) Fitted with air deflector on drive end shield

All values rated at 400V

IS YOUR MOTOR VSD COMPATIBLE? ABSOLUTELY!



WISE® - WEG INSULATION SYSTEM EVOLUTION

The WEG, WISE® insulation system (WEG Insulation System Evolution) has resulted from using enhanced insulation materials during the production of the electric motor insulation.

Variable Speed Drive (VSD) compatible wire, insulation film, impregnation material and suitable cables are used during the insulation process.

During the enamelling process, the 99.9% pure copper wire is covered by layers of LackTherm varnishes, which have been especially developed by WEG for the insulation systems of electric motors.

The LackTherm varnishes have excellent dielectric strength, flexibility, hardness, and chemical resistance with brilliant adhesion properties. During the impregnation process, the stator coils receive layers of high solid resins and water-based coatings which are environmentally friendly and free from harmful solvents as per (ISO 14000 Guidelines).

The use of motors with VSDs is permitted because the WISE® insulation system ensures that the motor windings are protected against voltage peaks and voltage variations that continuously occur during the operation with VSDs. The WISE® insulation system is capable of withstanding dV/dt and voltage impulse conditions described in the table below:

Motor rated voltage	Voltage Spikes at motor terminals (phase-phase)	dV/dt(*) at motor terminals (phase-phase)	Rise time*	Time between pulses
$V_n < 460 \text{ V}$	$\leq 1.600 \text{ V}$	$\leq 5.200 \text{ V}/\mu\text{s}$	$\geq 0,1 \mu\text{s}$	$\geq 6 \mu\text{s}$
$460 \text{ V} \leq V_n < 575 \text{ V}$	$\leq 2.000 \text{ V}$	$\leq 6.500 \text{ V}/\mu\text{s}$		
$575 \text{ V} \leq V_n \leq 1000 \text{ V}$	$\leq 2.400 \text{ V}$	$\leq 7.800 \text{ V}/\mu\text{s}$		

(*) dV/dt and Rise time definition according to Nema Std. MG1 - Part 30.

With the introduction of the WISE® insulation system to all WEG motor lines, our customers have full assurance that all our WEG motors are VSD compatible. This is an important consideration to be made when selecting a motor to be controlled by a VSD.



THREE PHASE CAST IRON MOTOR

IE1 Standard Efficiency

W22



Minimum info required for orders and enquiries.

W22 IE1

kW	
Speed	
Voltage	
Mounting	

5 Year Warranty on W22 range

IP55

Class H Insulation

Δ 220-240V or Y 380-415V 50Hz (63 to 100 frame)

Δ 380-415V or Y 660-690V 50Hz (112 to 355 frame)

Δ 460V – 60Hz (112 to 355 frame)

or

Δ 525-550V (63 to 132 frame)

Δ 525-550-575V/1000V (160 to 355 frame)

Suitable for VSD

Electrically Insulated non-drive end bearing via end shield (≥ 315 frame)

Thermistors 01/ phase (225 to 355 frame)

Please refer to the Optional Features and Parts section for information on Optional Features.

Efficiency values are given according to IEC 60034-2-1 they are calculated according to indirect method with stray load losses determined by measurement.

Paint finish RAL 5009

Regreasable end shields (225 to 355 frame)

Removable gland plate (355 frame)

All prices and values are subject to change without prior notice.

THREE PHASE CAST IRON MOTOR IE1 STANDARD EFFICIENCY W22

Class H Insulation

380V / 400V / 415V or 525V / 550V / 1000V

IP55

2 Pole					Excl. VAT	
KW	r/min	Frame Size	Shaft (mm)	Weight (kg)	Foot Mounted	Flange Mounted
0.18	2790	63	11	4.7	R 3 140	R 3 978
0.25	2750	63	11	7.3	R 3 251	R 4 063
0.37	2835	71	14	9.1	R 3 938	R 4 916
0.55	2800	71	14	9.8	R 3 961	R 4 938
0.75	2825	80	19	12.3	R 5 130	R 6 426
1.1	2800	80	19	13.7	R 5 449	R 6 779
1.5	2860	90S	24	19.4	R 5 765	R 6 976
2.2 (a)	2860	90L	24	23.3	R 7 312	R 8 821
3	2900	100L	28	29.6	R 8 718	R 10 368
4	2900	112M	28	39.1	R 9 866	R 11 428
5.5	2920	132S	38	57.4	R 12 001	R 13 847
7.5	2920	132S	38	64.7	R 14 132	R 16 190
9.2	2925	132M	38	71.8	R 19 688	R 22 922
11	2930	160M	42	104	R 25 211	R 28 729
15	2930	160M	42	116	R 31 118	R 35 400
18.5	2940	160L	42	132	R 37 956	R 42 108
22	2950	180M	48	167	R 47 189	R 52 085
30	2955	200L	55	220	R 58 331	R 65 190
37	2955	200L	55	245	R 68 803	R 76 759
45	2960	225S/M	55	381	R 93 734	R 103 346
55	2960	250S/M	60	465	R 116 542	R 126 452
75	2965	250S/M	60	457	R 155 163	R 171 154
90	2975	280S/M	65	664	R 177 528	R 193 329
110	2975	280S/M	65	702	R 210 342	R 226 462
132	2980	315S/M	65	937	R 245 080	R 264 281
160	2980	315S/M	65	1022	R 280 053	R 305 855
185	2980	315S/M	70	993	R 332 946	R 346 809
200	2980	315S/M	70	1135	R 345 215	R 364 430
220	2985	355M/L	90	1496	R 456 223	R 473 684
220	2980	315L	70	1224	R 409 969	R 434 543
250	2986	355M/L	90	1592	R 523 439	R 543 216
250	2980	315L	70	1316	R 450 081	R 469 745
280 (a)	2980	315L	70	1443	R 550 807	R 578 633
300 (a)	2980	315L	70	1500	R 596 781	R 626 959
315	2985	355M/L	90	1770	R 625 835	R 650 885
355	2985	355M/L	90	1830	R 710 254	R 739 184

(a) Temperature Rise 105K

Note: Prices Exclude VAT.



THREE PHASE CAST IRON MOTOR IE1 STANDARD EFFICIENCY W22

Class H Insulation

380V / 400V / 415V or 525V / 550V / 1000V

IP55

kW	Frame	r/min	Current			Torque			Allowed locked rotor time (s) Hot	Efficiency			Power Factor		
			400V In(A)	525V In(A)	Lock Rotor Current I/In	Full Load Torque Nm	Lock Rotor Torque Tl/Tn	Break-down Torque Tb/Tn		50%	75%	100%	50%	75%	100%
			0.18	63	2790	0.57	0.43	5.0		0.62	2.4	2.4	10	52.0	57.0
0.25	63	2750	0.75	0.57	4.3	0.87	2.3	2.3	25	52.0	57.0	60.0	0.50	0.68	0.80
0.37	71	2835	0.98	0.75	4.9	1.25	2.3	2.6	16	62.0	66.5	67.0	0.57	0.71	0.81
0.55	71	2800	1.38	1.05	5.0	1.88	2.3	2.5	7	64.0	70.0	70.0	0.56	0.71	0.82
0.75	80	2825	1.79	1.36	5.1	2.54	2.5	2.6	14	68.5	72.0	72.1	0.62	0.76	0.84
1.1	80	2800	2.47	1.88	6.3	3.75	2.6	2.6	7	74.0	76.5	76.5	0.64	0.77	0.84
1.5	90S	2860	3.32	2.53	6.3	5.01	2.7	2.6	7	77.5	78.0	78.5	0.63	0.76	0.83
2.2	90L	2860	4.58	3.49	6.8	7.35	2.6	2.9	7	81.0	81.5	81.5	0.63	0.77	0.85
3	100L	2900	6.07	4.62	6.9	9.9	2.3	3.0	9	81.5	82.0	82.0	0.69	0.81	0.87
4	112M	2900	7.81	5.95	6.8	13.2	2.4	3.0	9	82.0	84.0	85.0	0.71	0.82	0.87
5.5	132S	2920	10.6	8.08	6.5	18.0	2.1	3.0	11	85.0	86.0	86.0	0.71	0.81	0.87
7.5	132S	2920	14.4	11.0	6.9	24.5	2.3	2.6	11	85.5	86.5	86.5	0.72	0.82	0.87
9.2	132M	2925	17.6	13.4	7.5	30.0	2.7	3.1	7	87.0	87.5	87.5	0.70	0.81	0.86
11	160M	2930	20.9	15.9	6.8	35.9	2.0	2.7	11	87.8	88.6	88.4	0.70	0.81	0.86
15	160M	2930	28.1	21.4	7.2	48.9	2.6	3.1	9	89.5	89.8	89.5	0.71	0.81	0.86
18.5	160L	2940	34.4	26.2	7.8	60.1	2.6	3.1	7	90.3	90.7	90.3	0.70	0.80	0.86
22	180M	2950	39.7	30.2	7.3	71.2	2.2	3.1	7	90.7	91.0	90.8	0.76	0.84	0.88
30	200L	2955	54.3	41.4	6.9	97.0	2.5	2.7	18	91.6	92.0	91.6	0.76	0.84	0.87
37	200L	2955	66.7	50.8	6.7	120	2.6	2.6	16	92.0	92.5	92.0	0.76	0.84	0.87
45	225S/M	2960	80.8	61.6	6.9	145	2.5	2.8	10	91.8	92.6	92.4	0.76	0.84	0.87
55	250S/M	2960	96.1	73.2	6.7	177	2.2	2.7	12	92.2	93.0	92.8	0.79	0.86	0.89
75	250S/M	2965	130	99.0	7.8	242	2.6	3.0	9	93.0	93.5	93.3	0.78	0.86	0.89
90	280S/M	2975	156	119	7.0	289	2.0	2.8	20	93.0	93.8	93.7	0.80	0.87	0.89
110	280S/M	2975	190	145	7.0	353	2.0	2.8	20	93.5	94.2	94.0	0.79	0.86	0.89
132	315S/M	2980	227	173	6.7	423	1.8	2.6	24	93.5	94.3	94.3	0.79	0.86	0.89
160	315S/M	2980	272	207	7.6	513	2.0	2.8	21	94.0	94.5	94.5	0.80	0.87	0.90
185	315S/M	2980	321	245	7.7	593	2.0	2.8	14	94.4	94.6	94.6	0.77	0.84	0.88
200	315S/M	2980	339	258	7.7	641	2.1	2.8	17	94.4	94.7	94.6	0.80	0.87	0.90
220	355M/L	2985	373	284	7.7	704	1.8	2.8	20	94.5	94.8	94.7	0.83	0.88	0.90
220	315L	2980	373	284	8.0	705	2.3	2.8	14	94.5	94.8	94.7	0.82	0.88	0.90
250	355M/L	2986	423	322	8.3	800	2.7	2.8	20	94.5	94.8	94.7	0.86	0.88	0.90
250	315L	2980	419	319	7.9	801	2.4	2.8	14	94.5	94.8	94.7	0.83	0.88	0.91
280	315L	2980	474	361	8.5	897	2.8	2.8	14	94.5	94.9	94.8	0.84	0.88	0.90
300	315L	2980	506	386	7.5	961	2.5	2.5	12	94.8	95.0	95.0	0.84	0.88	0.90
**315	355M/L	2985	527	402	7.8	1,008	2.1	2.6	22	94.6	94.9	94.8	0.87	0.90	0.91
**355	355M/L	2985	594	453	9.3	1,136	2.5	3.1	14	94.6	95.0	94.8	0.86	0.90	0.91

(**) Fitted with air deflector on drive end shield
All values rated at 400V

THREE PHASE CAST IRON MOTOR IE1 STANDARD EFFICIENCY W22

Class H Insulation

380V / 400V / 415V or 525V / 550V / 1000V

IP55

4 Pole					Excl. VAT	
kW	r/min	Frame Size	Shaft (mm)	Weight (kg)	Foot Mounted	Flange Mounted
0.18	1390	63	11	7.6	R 3 140	R 3 978
0.25	1390	71	14	9.2	R 3 620	R 4 595
0.37	1370	71	14	10	R 3 728	R 4 703
0.55	1440	80	19	13.2	R 4 048	R 5 023
0.75	1435	80	19	14.9	R 4 638	R 5 793
1.1	1450	90S	24	19.2	R 5 118	R 6 216
1.5	1445	90L	24	23.3	R 6 427	R 7 496
2.2	1430	100L	28	30.6	R 7 511	R 9 000
3	1420	100L	28	31	R 8 679	R 10 283
4	1440	112M	28	43	R 9 866	R 11 428
5.5	1470	132S	38	60.4	R 12 001	R 13 847
7.5	1460	132M	38	73.4	R 14 702	R 17 112
9.2	1455	132M	38	70	R 20 450	R 23 911
11	1460	160M	42	109	R 23 332	R 26 432
15	1470	160L	42	136	R 30 292	R 33 993
18.5	1470	180M	48	159	R 37 188	R 41 742
22	1465	180L	48	172	R 44 930	R 50 047
30	1470	200L	55	231	R 53 750	R 60 223
37	1478	225S/M	60	355	R 74 075	R 82 093
45	1475	225S/M	60	389	R 85 799	R 95 583
55	1475	250S/M	70	457	R 110 436	R 117 895
75	1479	250S/M	70	496	R 131 924	R 143 488
90	1485	280S/M	80	702	R 151 906	R 163 214
110	1485	280S/M	80	735	R 182 184	R 197 591
132	1490	315S/M	85	953	R 212 252	R 237 530
160	1490	315S/M	85	1012	R 236 085	R 257 169
185	1490	315S/M	90	1071	R 279 863	R 296 005
200	1490	315S/M	90	1216	R 292 545	R 306 666
220	1490	355M/L	100	1414	R 382 041	R 403 013
220	1490	315L	90	1330	R 382 041	R 403 013
250	1490	355M/L	100	1470	R 437 408	R 480 558
250	1490	315L	90	1399	R 437 408	R 480 558
260	1490	355M/L	100	1571	R 445 553	R 485 054
280	1490	355M/L	100	1510	R 482 505	R 506 593
280	1490	315L	90	1496	R 482 505	R 506 593
300	1490	355M/L	100	1560	R 497 609	R 529 580
300	1490	315L	90	1540	R 497 609	R 529 580
315	1490	355M/L	100	1670	R 526 094	R 552 604
315	1490	315L	90	1540	R 526 094	R 552 604
330	1490	355M/L	100	1769	R 546 666	R 588 266
355	1490	355M/L	100	1888	R 567 407	R 605 915
370	1490	355M/L	100	1971	R 612 700	R 650 264
400	1490	355M/L	100	1971	R 657 461	R 700 711

Motors from Frame Size 280S/M fitted with bearing shaft locking device for transport and should be removed only during installation.

Note: Prices Exclude VAT.

THREE PHASE CAST IRON MOTOR IE1 STANDARD EFFICIENCY W22

Class H Insulation

380V / 400V / 415V or 525V / 550V / 1000V

IP55

kW	Frame	r/min	Current			Torque			Allowed locked rotor time (s) Hot	Efficiency			Power Factor		
			400V In(A)	525V In(A)	Lock Rotor Current I _L /In	Full Load Torque Nm	Lock Rotor Torque T _L /T _n	Break-down Torque T _b /T _n		50%	75%	100%	50%	75%	100%
			0.18	63	1390	0.62	0.469	3.8		1.24	1.9	1.9	16	51.0	55.0
0.25	71	1390	0.80	0.613	3.7	1.72	1.8	1.9	28	60.0	61.0	61.5	0.50	0.62	0.73
0.37	71	1370	1.11	0.846	3.6	2.58	2.0	2.2	28	58.0	62.0	66.0	0.50	0.64	0.73
0.55	80	1440	1.43	1.09	5.3	3.65	2.0	2.8	8	65.0	70.0	71.0	0.54	0.68	0.78
0.75	80	1435	1.90	1.45	5.1	4.99	2.1	2.3	7	67.0	72.0	72.3	0.58	0.70	0.79
1.1	90S	1450	2.56	1.95	5.8	7.24	1.8	2.4	7	72.5	75.5	75.5	0.60	0.74	0.82
1.5	90L	1445	3.41	2.6	5.8	9.9	1.9	2.2	8	74.5	77.5	77.5	0.58	0.73	0.82
2.2	100L	1430	4.84	3.69	5.6	14.7	2.4	2.6	9	79.0	80.0	80.0	0.60	0.74	0.82
3	100L	1420	6.56	5	6.5	20.2	2.8	2.8	8	79.0	81.5	81.5	0.57	0.72	0.81
4	112M	1440	8.64	6.58	6.2	26.5	2.1	2.5	9	82.5	83.5	83.5	0.61	0.73	0.80
5.5	132S	1470	11.1	8.46	7.2	35.7	2.0	2.8	7	84.0	85.5	85.5	0.63	0.77	0.84
7.5	132M	1460	15.2	11.6	6.4	49.1	2.0	2.5	8	85.5	87.0	87.0	0.63	0.75	0.82
9.2	132M	1455	17.8	13.6	7.5	60.4	2.2	2.8	6	86.5	87.7	87.7	0.64	0.78	0.85
11	160M	1460	22.0	16.8	6.0	72.0	2.1	2.5	9	87.0	88.0	88.0	0.64	0.76	0.82
15	160L	1470	29.2	22.2	7.1	97.4	2.6	3.1	8	89.0	89.7	89.3	0.66	0.76	0.83
18.5	180M	1470	36.1	27.5	7.5	120	2.7	3.1	12	88.0	89.5	90.2	0.65	0.75	0.82
22	180L	1465	41.7	31.8	6.6	143	2.4	2.9	10	90.0	90.8	90.7	0.66	0.77	0.84
30	200L	1470	56.3	42.9	6.6	195	2.3	2.6	13	91.3	91.7	91.5	0.68	0.78	0.84
37	225S/M	1478	68.1	51.9	7.0	239	2.3	2.7	10	92.0	92.4	92.2	0.71	0.81	0.85
45	225S/M	1475	81.6	62.2	7.5	291	2.5	2.7	10	92.2	92.4	92.6	0.72	0.82	0.86
55	250S/M	1475	100	76.2	6.7	356	2.4	2.6	12	92.9	93.2	93.1	0.73	0.82	0.85
75	250S/M	1479	135	103	7.6	484	2.4	3.0	8	93.1	93.4	93.5	0.73	0.82	0.86
90	280S/M	1485	163	124	6.8	579	2.1	2.5	20	93.2	93.8	93.8	0.75	0.83	0.85
110	280S/M	1485	201	153	6.8	707	2.1	2.6	16	93.5	94.2	94.1	0.73	0.82	0.84
132	315S/M	1490	235	179	6.9	846	2.3	2.4	22	93.9	94.5	94.3	0.74	0.83	0.86
160	315S/M	1490	284	216	7.3	1026	2.4	2.5	18	94.1	94.6	94.5	0.73	0.82	0.86
185	315S/M	1490	328	250	6.9	1186	2.4	2.3	17	94.3	94.7	94.6	0.74	0.82	0.86
200	315S/M	1490	350	267	6.9	1282	2.3	2.4	16	94.4	94.8	94.7	0.76	0.84	0.87
220	355M/L	1490	394	300	6.4	1410	2.0	2.2	18	94.6	94.9	94.8	0.73	0.81	0.85
220	315L	1490	389	296	7.7	1410	2.6	2.4	14	94.5	94.9	94.8	0.74	0.83	0.86
250	355M/L	1490	447	341	6.5	1602	2.1	2.4	18	94.6	94.9	94.9	0.73	0.82	0.85
250	315L	1490	443	338	7.8	1602	2.7	2.5	12	94.6	94.9	94.8	0.75	0.83	0.86
260	355M/L	1490	465	354	6.4	1666	2.4	2.4	14	94.6	95.0	94.9	0.73	0.82	0.85
280	355M/L	1490	501	382	6.6	1795	2.1	2.4	14	94.6	95.0	94.9	0.74	0.82	0.85
280	315L	1490	495	377	7.9	1795	2.7	2.5	12	94.6	95.0	94.9	0.74	0.82	0.86
300	355M/L	1490	537	409	7.2	1923	2.2	2.4	18	94.6	95.0	94.9	0.74	0.82	0.85
300	315L	1490	537	409	7.6	1923	2.5	2.5	11	94.0	94.9	94.9	0.72	0.80	0.85
315	355M/L	1490	557	424	7.2	2019	2.4	2.4	14	94.6	95.0	94.9	0.74	0.82	0.86
315	315L	1490	570	434	7.9	2019	3.0	3.2	11	94.6	95.0	95.0	0.68	0.79	0.84
330	355M/L	1490	584	445	6.8	2115	2.2	2.4	17	94.6	95.0	94.9	0.75	0.83	0.86
**355	355M/L	1490	628	478	6.9	2275	2.4	2.3	15	94.6	95.0	94.9	0.75	0.83	0.86
**370	355M/L	1490	654	498	7.3	2371	2.6	2.4	11	94.9	95.1	94.9	0.75	0.83	0.86
**400	355M/L	1490	707	539	7.3	2564	2.6	2.4	11	94.7	95.1	94.9	0.74	0.82	0.86

(**) Fitted with air deflector on drive end shield. All values rated at 400V

THREE PHASE CAST IRON MOTOR IE1 STANDARD EFFICIENCY W22

Class H Insulation

380V / 400V / 415V or 525V / 550V / 1000V

IP55

6 Pole					Excl. VAT	
kW	r/min	Frame Size	Shaft (mm)	Weight (kg)	Foot Mounted	Flange Mounted
0.25	950	80	19	8.5	R 4 669	R 5 863
0.37	905	80	19	13.5	R 4 787	R 5 944
0.55	930	80	19	15.4	R 6 116	R 7 678
0.75	945	90S	24	18	R 6 565	R 7 911
1.1	940	90L	24	24.6	R 8 121	R 9 784
1.5	945	100L	28	27.6	R 8 847	R 10 731
2.2	950	112M	28	37.5	R 10 621	R 12 261
3	955	132S	38	55.8	R 13 222	R 15 419
4	960	132M	38	65.4	R 15 933	R 18 493
5.5	960	132M	38	77.1	R 18 449	R 21 597
7.5	965	160M	42	104	R 27 010	R 30 571
11	965	160L	42	126	R 40 398	R 45 551
15	970	180L	48	166	R 52 685	R 60 933
18.5	975	200L	55	190	R 59 305	R 67 075
22	975	200L	55	227	R 68 610	R 76 956
30	985	225S/M	60	383	R 97 488	R 109 684
37	985	250S/M	70	461	R 121 971	R 133 863
45	981	250S/M	70	466	R 148 809	R 163 781
55	985	280S/M	80	607	R 165 086	R 178 117
75	985	280S/M	80	682	R 195 961	R 211 981
90	990	315S/M	85	883	R 237 201	R 258 421
110	990	315S/M	85	941	R 284 837	R 307 505
132	990	315S/M	85	1103	R 328 742	R 338 603
160	992	355M/L	100	1416	R 378 795	R 391 679
160	990	315L	90	1203	R 378 795	R 391 679
185	990	355M/L	100	1530	R 379 484	R 407 706
185	990	315L	90	1346	R 379 484	R 407 706
200	990	355M/L	100	1600	R 418 368	R 444 127
200	990	315L	90	1488	R 418 368	R 444 127
220	990	355M/L	100	1678	R 554 429	R 609 512
220	990	315L	90	1563	R 554 429	R 609 512
250	990	355M/L	100	1752	R 573 131	R 625 506
250 (a)	990	315L	90	1399	R 573 131	R 625 506
280	990	355M/L	100	1839	R 603 649	R 634 624
300	990	355M/L	100	1900	R 658 353	R 691 227
315	995	355M/L	100	1979	R 688 325	R 722 693

Motors from Frame Size 280S/M fitted with bearing shaft locking device for transport and should be removed only during installation.

(a) Temperature Rise 105K

Note: Prices Exclude VAT.



THREE PHASE CAST IRON MOTOR IE1 STANDARD EFFICIENCY W22

Class H Insulation

380V / 400V / 415V or 525V / 550V / 1000V

IP55

kW	Frame	r/min	Current			Torque			Allowed locked rotor time (s) Hot	Efficiency			Power Factor		
			400V In(A)	525V In(A)	Lock Rotor Current I/In	Full Load Torque Nm	Lock Rotor Torque Tl/Tn	Break-down Torque Tb/Tn		50%	75%	100%	50%	75%	100%
			0.25	80	950	0.97	0.74	4.1		2.51	2.1	2.7	26	51.0	58.0
0.37	80	905	1.13	0.86	3.6	3.90	1.7	1.7	16	55.0	60.0	63.0	0.50	0.64	0.75
0.55	80	930	1.62	1.23	4.5	5.65	2.3	2.3	10	60.0	65.0	67.0	0.50	0.63	0.73
0.75	90S	945	2.06	1.57	5.0	7.58	2.0	2.1	17	68.0	70.0	70.0	0.51	0.65	0.75
1.1	90L	940	3.02	2.30	5.0	11.2	2.7	2.6	9	70.0	72.0	73.0	0.47	0.60	0.72
1.5	100L	945	3.90	2.97	4.4	15.2	1.9	2.2	14	76.0	77.0	76.0	0.52	0.66	0.73
2.2	112M	950	5.50	4.19	5.1	22.1	2.3	2.5	10	78.0	78.5	78.0	0.53	0.66	0.74
3	132S	955	6.94	5.29	5.3	30.0	2.0	2.2	20	81.0	82.0	81.0	0.58	0.70	0.77
4	132M	960	9.46	7.21	5.8	39.8	2.1	2.2	19	81.0	82.5	82.5	0.54	0.66	0.74
5.5	132M	960	13.0	9.90	6.2	54.7	2.3	2.9	19	82.5	84.5	84.5	0.51	0.64	0.72
7.5	160M	965	15.3	11.7	5.4	74.2	1.9	2.3	12	85.3	85.5	85.3	0.64	0.76	0.83
11	160L	965	21.9	16.7	5.8	109	2.1	2.4	11	87.0	87.5	87.2	0.65	0.77	0.83
15	180L	970	28.2	21.5	6.8	148	2.3	2.7	6	88.0	88.5	88.2	0.72	0.82	0.87
18.5	200L	975	36.6	27.9	5.7	181	2.1	2.4	12	88.3	89.3	88.9	0.64	0.76	0.82
22	200L	975	42.7	32.5	6.0	215	2.2	2.4	13	89.5	90.0	89.7	0.67	0.77	0.83
30	225S/M	985	55.2	42.1	7.2	291	2.6	2.7	12	91.0	91.5	91.2	0.73	0.82	0.86
37	250S/M	985	67.7	51.6	6.7	359	2.1	2.4	14	91.7	91.9	91.7	0.74	0.83	0.86
45	250S/M	981	81.9	62.4	6.5	438	2.1	2.3	15	92.2	92.4	92.2	0.75	0.83	0.86
55	280S/M	985	106	80.8	6.0	533	2.2	2.5	20	92.7	92.7	92.6	0.64	0.75	0.81
75	280S/M	985	140	107	6.5	727	2.0	2.5	14	93.0	93.1	93.0	0.68	0.79	0.83
90	315S/M	990	168	128	6.2	868	2.0	2.2	18	93.4	93.6	93.4	0.70	0.80	0.83
110	315S/M	990	204	155	6.2	1,061	2.0	2.2	20	93.7	94.0	93.8	0.70	0.80	0.83
132	315S/M	990	238	181	6.2	1,273	2.1	2.2	18	94.0	94.2	94.1	0.73	0.82	0.85
160	355M/L	992	309	235	5.6	1,540	1.8	2.0	32	94.0	94.5	94.5	0.64	0.74	0.79
160	315L	990	295	225	6.5	1,543	2.2	2.3	14	94.1	94.4	94.4	0.69	0.79	0.83
185	355M/L	990	357	272	6.0	1,785	2.0	2.2	30	94.3	94.6	94.6	0.63	0.74	0.79
185	315L	990	340	259	7.1	1,785	2.3	2.4	12	94.2	94.5	94.6	0.70	0.79	0.83
200	355M/L	990	381	290	6.0	1,929	2.0	2.1	32	94.4	94.7	94.7	0.64	0.75	0.80
200	315L	990	368	280	7.3	1,929	2.4	2.5	12	94.3	94.6	94.6	0.70	0.80	0.83
220	355M/L	990	419	319	6.4	2,122	2.1	2.2	30	94.4	94.8	94.7	0.64	0.74	0.80
220	315L	990	404	308	6.8	2,122	2.3	2.3	15	94.4	94.7	94.7	0.70	0.80	0.83
250	355M/L	990	476	363	6.0	2,412	2.1	2.1	32	94.4	94.7	94.7	0.65	0.75	0.80
250	315L	990	469	357	7.0	2,412	2.5	2.5	11	94.8	94.8	94.9	0.65	0.77	0.81
280	355M/L	990	533	406	6.2	2,701	2.1	2.1	28	94.5	94.8	94.8	0.64	0.75	0.80
300	355M/L	990	579	441	6.2	2,894	2.2	2.2	30	94.4	94.7	94.6	0.63	0.74	0.79
**315	355M/L	995	592	451	6.2	3,023	2.2	2.2	28	94.5	94.8	94.8	0.66	0.76	0.81

(**) Fitted with air deflector on drive end shield

All values rated at 400V

THREE PHASE CAST IRON MOTOR IE1

THREE PHASE CAST IRON MOTOR IE1 STANDARD EFFICIENCY W22

Class H Insulation

380V / 400V / 415V or 525V / 550V / 1000V

IP55

8 Pole					Excl. VAT	
kW	r/min	Frame Size	Shaft (mm)	Weight (kg)	Foot Mounted	Flange Mounted
0.37	685	90S	24	17.7	R 6 248	R 7 878
0.55	675	90L	24	23.1	R 6 797	R 8 141
0.75	705	100L	28	25.3	R 10 050	R 12 013
1.1	700	100L	28	29.7	R 10 683	R 12 812
1.5	700	112M	28	37.7	R 13 948	R 15 866
2.2	710	132S	38	55.3	R 16 612	R 19 078
3	710	132M	38	65	R 19 868	R 22 994
4	720	160M	42	101	R 27 660	R 31 538
5.5	720	160M	42	110	R 33 057	R 36 816
7.5	720	160L	42	125	R 40 298	R 44 691
11	730	180L	48	175	R 56 549	R 63 714
15	725	200L	55	205	R 61 473	R 71 312
18.5	735	225S/M	60	339	R 84 084	R 94 287
22	730	225S/M	60	358	R 100 816	R 113 289
30	735	250S/M	70	433	R 130 433	R 143 551
37	730	250S/M	70	475	R 161 067	R 175 357
45	740	280S/M	80	617	R 174 740	R 190 911
55	740	280S/M	80	826	R 200 646	R 221 364
75	740	315S/M	85	998	R 248 683	R 270 089
90	740	315S/M	85	982	R 287 467	R 306 957
110	740	315S/M	85	1180	R 325 018	R 352 893
132	745	355M/L	100	1448	R 356 768	R 379 400
132	740	315L	90	1290	R 356 768	R 379 400
160	745	355M/L	100	1448	R 565 874	R 622 414
160	740	315L	90	1350	R 565 874	R 622 414
185	743	355M/L	100	1653	R 589 477	R 648 458
185 (a)	740	315L	90	1520	R 589 477	R 648 458
200	745	355M/L	100	1725	R 613 957	R 656 691
220	745	355M/L	100	1839	R 634 353	R 697 418

Motors from Frame Size 280S/M fitted with bearing shaft locking device for transport and should be removed only during installation.

(a) Temperature Rise 105K

Note: Prices Exclude VAT.



THREE PHASE CAST IRON MOTOR IE1 STANDARD EFFICIENCY W22

Class H Insulation

IP55

380V / 400V / 415V or 525V / 550V / 1000V

kW	Frame	r/min	Current			Torque			Allowed locked rotor time (s) Hot	Efficiency			Power Factor		
			400V In(A)	525V In(A)	Lock Rotor Current I _L /I _n	Full Load Torque Nm	Lock Rotor Torque T _L /T _n	Break-down Torque T _b /T _n		50%	75%	100%	50%	75%	100%
			0.37	90S	685	1.50	1.14	3.0		5.16	1.9	1.8	32	50.6	55.0
0.55	90L	675	2.00	1.52	3.3	7.78	1.9	2.0	25	58.0	60.0	60.0	0.43	0.56	0.66
0.75	100L	705	2.71	2.06	3.5	10.16	1.8	2.4	33	63.5	64.0	64.5	0.42	0.53	0.62
1.1	100L	700	3.44	2.62	4.0	15.01	1.7	2.3	27	65.0	65.5	70.0	0.45	0.57	0.66
1.5	112M	700	4.21	3.21	4.2	20.46	2.2	2.2	26	73.7	75.4	73.5	0.48	0.61	0.70
2.2	132S	710	5.35	4.08	6.1	29.59	2.5	2.8	22	75.8	78.0	77.1	0.55	0.68	0.77
3	132M	710	7.41	5.65	6.5	40.35	2.4	2.9	18	78.5	80.1	79.0	0.55	0.67	0.74
4	160M	720	9.84	7.50	4.7	53.06	2.0	2.1	17	79.5	82.0	81.5	0.52	0.65	0.72
5.5	160M	720	13.1	9.98	4.7	72.95	2.0	2.1	16	82.0	83.2	83.0	0.52	0.65	0.73
7.5	160L	720	17.4	13.3	4.9	99.48	2.2	2.2	16	84.0	85.5	85.0	0.52	0.65	0.73
11	180L	730	23.4	17.8	7.2	143.90	2.5	2.9	10	85.0	85.8	86.0	0.63	0.73	0.79
15	200L	725	32.6	24.8	4.6	197.59	1.9	2.0	22	86.5	87.0	87.5	0.58	0.70	0.76
18.5	225S/M	735	36.8	28.0	6.4	240.37	1.8	2.4	18	87.4	87.9	88.4	0.66	0.77	0.82
22	225S/M	730	44.6	34.0	6.4	287.81	1.8	2.4	16	87.9	88.4	88.9	0.66	0.76	0.80
30	250S/M	735	58.2	44.3	6.9	389.80	1.9	2.4	13	88.7	89.2	89.7	0.67	0.78	0.83
37	250S/M	730	71.4	54.4	6.9	484.04	1.9	2.7	12	89.1	89.6	90.1	0.67	0.78	0.83
45	280S/M	740	90.8	69.2	5.4	580.74	1.7	2.0	21	89.5	90.0	90.5	0.64	0.75	0.79
55	280S/M	740	111	84.6	5.4	709.80	1.7	2.0	20	89.8	90.3	90.8	0.64	0.75	0.79
75	315S/M	740	149	114	5.3	967.91	1.6	2.0	30	90.0	90.5	91.0	0.66	0.76	0.80
90	315S/M	740	177	135	5.8	1,161.49	1.8	2.1	26	90.7	91.2	91.7	0.66	0.76	0.80
110	315S/M	740	215	164	5.8	1,419.59	1.8	2.1	24	91.1	91.6	92.1	0.64	0.75	0.80
132	355M/L	745	261	199	6.0	1,692.08	1.2	2.1	48	91.4	91.9	92.4	0.62	0.74	0.79
132	315L	740	255	199	6.2	1,703.51	2.0	2.2	23	94.0	94.5	94.6	0.63	0.74	0.79
160	355M/L	745	261	240	6.0	2,051.01	1.2	2.1	48	91.4	91.9	92.4	0.62	0.74	0.79
160	315L	740	316	241	6.4	2,064.86	2.2	2.2	20	91.6	92.3	92.6	0.63	0.74	0.79
185	355M/L	743	362	276	6.5	2,377.86	1.6	2.1	46	91.9	92.3	92.3	0.64	0.75	0.80
185	315L	740	368	280	7.0	2,387.50	2.4	2.4	12	92.0	92.5	93.0	0.62	0.72	0.78
200	355M/L	745	392	299	6.2	2,563.76	1.5	2.2	44	92.3	92.8	93.3	0.63	0.74	0.79
220	355M/L	745	425	324	6.3	2,820.13	1.4	2.1	42	92.3	92.8	93.3	0.64	0.75	0.80

(**) Fitted with air deflector on drive end shield
All values rated at 400V

THREE PHASE ALUMINIUM MOTOR

IE1 Standard Efficiency

W21



Minimum info required for orders and enquiries.

WEG Aluminium

kW	
Speed	
Voltage	
Mounting	

2 Year Warranty on W21 Range

IP55

Class F Insulation

Δ 220-240V or Y 380-415V 50Hz (63 to 100 frame)

Δ 380-415V or Y 660-690V 50Hz (112 to 132 frame)

Δ 460V – 60Hz (112 to 132 frame)

or

Δ 525-550V - 50Hz (63 to 132 frame)

Suitable for VSD

Paint finish RAL 5009 or Brushed Aluminium

All prices and values are subject to change without prior notice.



ALUMINIUM THREE PHASE MOTOR IE1 STANDARD EFFICIENCY W21

Class F Insulation

380V / 400V / 415V or 525V / 550V

IP55

2 Pole				Mounting		
kW	r/min	Frame	Shaft	Weight	Foot	Flange
		Size	Dia.(mm)	(kg)	Excl. VAT	Excl. VAT
0.18	2790	63	11	5,5	R 2 197	R 2 305
0.25	2720	63	11	5,8	R 2 279	R 2 393
0.37	2770	71	14	7	R 2 495	R 2 617
0.55	2780	71	14	7,8	R 2 564	R 2 692
0.75	2770	80	19	9,6	R 3 128	R 3 286
1.1	2800	80	19	12,5	R 3 463	R 3 635
1.5	2860	90S	24	15,5	R 4 238	R 4 450
2.2	2850	90L	24	17,8	R 4 464	R 4 685
3	2905	100L	28	23,5	R 5 901	R 6 196
4	2875	112M	28	33,2	R 8 615	R 9 047
5.5	2910	132S	38	43,6	R 10 444	R 10 964
7.5	2900	132M	38	53	R 12 008	R 12 609
9.2	2925	132M	38	58	R 20 245	R 21 259

4 Pole				Mounting		
kW	r/min	Frame	Shaft	Weight	Foot	Flange
		Size	Dia.(mm)	(kg)	Excl. VAT	Excl. VAT
0.18	1400	63	11	5,7	R 2 197	R 2 305
0.25	1385	71	14	8,4	R 2 314	R 2 428
0.37	1370	71	14	8,9	R 2 668	R 2 803
0.55	1415	80	19	10,2	R 3 141	R 3 299
0.75	1410	80	19	11	R 3 263	R 3 427
1.1	1430	90S	24	15,3	R 3 795	R 3 983
1.5	1420	90L	24	16,6	R 4 238	R 4 450
2.2	1410	100L	28	21,2	R 5 675	R 5 959
3	1420	100L	28	24,2	R 6 499	R 6 824
4	1440	112M	28	35,8	R 7 981	R 8 379
5.5	1450	132S	38	43,9	R 10 693	R 11 227
7.5	1465	132M	38	50	R 12 698	R 13 335
9.2	1455	132M	38	70	R 21 884	R 22 980

6 Pole				Mounting		
kW	r/min	Frame	Shaft	Weight	Foot	Flange
		Size	Dia.(mm)	(kg)	Excl. VAT	Excl. VAT
0.37	920	80	19	10,2	R 3 314	R 3 480
0.55	930	80	19	12,3	R 3 520	R 3 697
0.75	910	90S	24	15,9	R 3 842	R 4 033
1.1	940	90L	24	18,9	R 4 967	R 5 214
1.5	945	100L	28	21,1	R 5 513	R 5 788
2.2	955	112M	28	36	R 7 622	R 8 004
3	965	132S	38	40,2	R 10 338	R 10 856
4	960	132M	38	48,9	R 11 252	R 11 813
5.5	960	132M	38	58,2	R 15 807	R 16 596

Note: Prices Exclude VAT.

SINGLE PHASE ALUMINIUM MOTOR

IE1 Standard Efficiency

W21

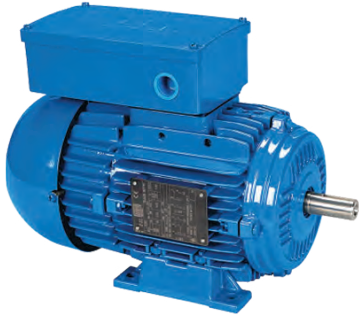

Minimum info required for orders and enquiries.

WEG Single Phase Aluminium Motor

kW	
Speed	
Voltage	
Mounting	

IP55

Class F Insulation

Single-Phase 220V or 440V 50 Hz

High Torque Motor (capacitor start and run)

Paint finish RAL 5009

2 Year Warranty on W21 Range

W21 IE1 STANDARD EFFICIENCY ALUMINIUM SINGLE PHASE MOTOR

Class F Insulation

220V High Torque

IP55

2 Pole					Mounting	
kW	r/min	Frame Size	Shaft Dia.(mm)	Weight (kg)	Foot Excl. VAT	Flange Excl. VAT
0.37	2910	71	14	10,5	R 5 704	R 6 113
0.55	2880	71	14	10,4	R 5 890	R 6 318
0.75	2900	80	19	13,8	R 6 097	R 6 512
1.1	2850	80	19	14,2	R 6 998	R 7 482
1.5	2900	90S	24	17,5	R 8 093	R 8 657
2.2	2890	90L	24	19,8	R 11 176	R 11 951
3	2910	100L	28	30,4	R 12 384	R 13 251
3.7	2900	112M	28	39,1	R 14 380	R 15 388
5.5	2910	132M	38	57,4	R 19 250	R 20 597
7.5	2930	132M	38	68,1	R 21 835	R 23 363

4 Pole					Mounting	
kW	r/min	Frame Size	Shaft Dia.(mm)	Weight (kg)	Foot Excl. VAT	Flange Excl. VAT
0.25	1440	71	14	10	R 5 430	R 5 814
0.37	1420	71	14	11	R 6 017	R 6 429
0.55	1450	80	19	14,4	R 6 351	R 6 851
0.75	1450	80	19	14,5	R 7 148	R 7 683
1.1	1435	90L	24	18,9	R 7 934	R 8 481
1.5	1430	90L	24	20,9	R 9 345	R 10 010
2.2	1450	100L	28	30,1	R 11 411	R 12 868
3	1440	112M	28	42,1	R 13 041	R 13 953
3.7	1430	112M	28	44,5	R 16 445	R 17 597
5.5	1440	132M	38	60,4	R 21 430	R 22 930
7.5	1460	132M	38	73,4	R 24 772	R 26 504

Note: Prices Exclude VAT.

All prices and values are subject to change without prior notice.



WEG ELECTRONICALLY COMMUTATED MOTOR

IE5 Single Phase

WECM

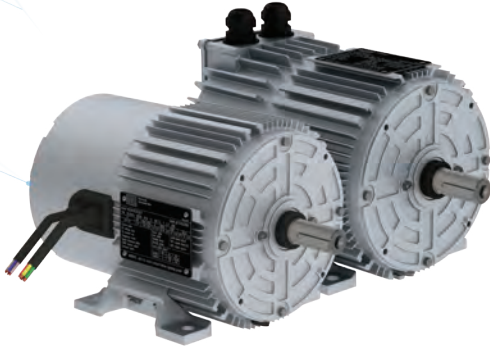

Minimum info required for orders and enquiries.

WEG EC Motor

kW	
Speed	
Voltage	
Mounting	

Motor with integrated VSD

Local or remotely controlled

Single Phase 220 to 277VAC, 50/60Hz or

Three Phase 380 to 480VAC, 50/60Hz

Overload, Over Temperature & Locked rotor Protection

Fire Mode (Override & Maximum Speed Mode)

Available in B14 mount

Stand alone speed controller	List Price
	R 3 450

WECM IE5 ALUMINIUM SINGLE PHASE MOTOR & DRIVE

220V

Please specify the required speed

IP55

Description		Frame Size	Weight(kg)	Mounting		
kW	Speed r/min			Foot Excl. VAT	Flange Excl. VAT	PAD Excl. VAT
0.12	1500 or 3000	80	5,2	R 5 051	R 5 051	R 5 051
0.18	1500 or 3000	80	6,4	R 5 177	R 5 177	R 5 177
0.25	1500 or 3000	80	7,7	R 5 296	R 5 296	R 5 296
0.37	1500 or 3000	80	9,2	R 5 855	R 5 855	R 5 855
0.55	1500 or 3000	80	9,9	R 6 240	R 6 240	R 6 240
0.75	1500 or 3000	80	11,7	R 6 998	R 6 998	R 6 998
1.1	1500 or 3000	80	11,7	R 7 723	R 7 723	R 7 723

IE5 Three Phase

WECM

WECM IE5 ALUMINIUM THREE PHASE MOTOR & DRIVE

400V

Please specify the required speed

IP55

Description		Size	Weight(kg)	Mounting		
kW	Speed r/min			Foot Excl. VAT	Flange Excl. VAT	PAD Excl. VAT
1.5	1500 or 3000	100L	11,7	R 22 380	R 22 380	R 22 380
2.2	1500 or 3000	100L	21	R 24 090	R 24 090	R 24 090
3	1500 or 3000	100L	22,5	R 26 605	R 26 605	R 26 605
4	1500 or 3000	100L	26	R 28 582	R 28 582	R 28 582

Note: Prices Exclude VAT.

All prices and values are subject to change without prior notice.



INTEGRATED ELECTRICAL SOLUTIONS

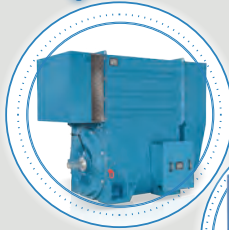
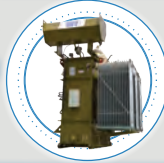
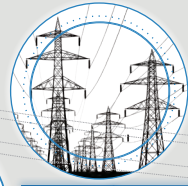

ZEST

WEG Group

240 kV

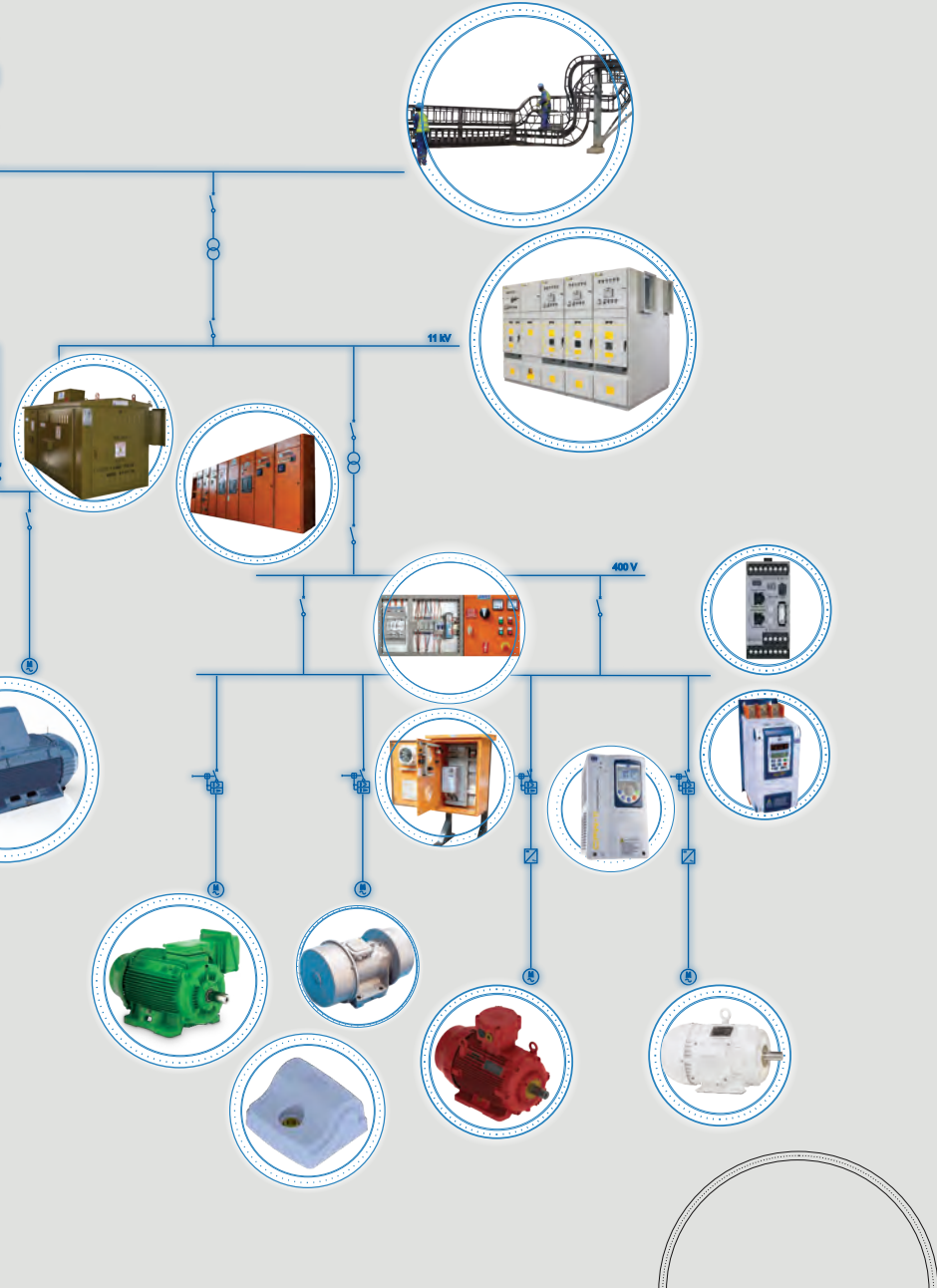



W22 (IE1 to IE4)



WEEM



W22 WQuatro



W22 Brake Motor



W22 WWash



Slipring



W21 Aluminium



W22 Cooling Tower



W21 (Ex db)



W22X (Ex db)



W22 (Ex nA) or (Ex tb)



W22 Smokex Pad Mount



WGP



W40 (ODP)



WMagnet



Direct Drive



W51 Squirrel Cage Motor



W60 Squirrel Cage Motor



M Line Slip Ring Motor





W12 Single Phase



Vibrator Motor



W22 2-Speed



W22 Roller Table



Saw Arbor



Gas Pump



W22 Smokex



W22 Pad Mount



W21 Pad Mount
Aluminium



MW500



W50



W51



MGF
Squirrel Cage Motor



S Line
Synchronous Motor



M Mining
Slip Ring Motor

BRAKE MOTOR

IE3 Three Phase

W22



IP55

Class H insulation

Δ 220-240V or Y 380-415V 50Hz (63 to 100 frame) Δ380-415V or Y 660-690V-50Hz(112 to 160 frame)

Δ 460V – 60Hz (63 to 160 frame)

or

Δ 525-550V - 50Hz (63 to 160 frame)

Rated output: available up to 75kW

Suitable for VSD

Brake power supply voltage same as supply to stator: 380-415V or 525-525V

Micro switch optional

Motor seals rated for IP66

Paint finish RAL 6002

Minimum info required for orders and enquiries.

Brake Motor

kW	
Speed	
Voltage	
Mounting	

HIGH TORQUE BRAKES

5 Year Warranty on W22 Range

W22 BRAKE CAST IRON THREE PHASE MOTOR

Class H Insulation

380V / 400V / 415V or 525V / 550V

IP55

4 Pole		Frame	Brake Power	Brake Torque	Weight	Mounting	
kW	r/min					Size	(W)
						Excl. VAT	Excl. VAT
0.18	1370	63	20	4	8,2	R 10 762	R 11 329
0.25	1390	71	25	8	9,5	R 11 915	R 12 542
0.37	1385	71	25	8	11	R 17 756	R 18 693
0.55	1420	80	25	12	14	R 18 117	R 19 070
0.75	1420	80	25	12	16	R 19 288	R 20 302
1.1	1455	90S	33	23	22	R 19 757	R 20 796
1.5	1450	90L	33	23	25,5	R 20 315	R 21 385
2.2	1435	100L	40	46	35,5	R 23 285	R 24 510
3	1455	100L	40	60	49	R 25 824	R 27 185
4	1450	112M	53	60	50	R 31 858	R 33 535
5.5	1460	132S	56	125	75	R 40 041	R 42 149
7.5	1460	132M	85	125	83	R 46 809	R 49 272
9.2	1465	132M	85	125	91	R 62 150	R 65 420
11	1470	160M	85	235	132	R 68 361	R 71 960
15	1465	160L	85	235	154	R 73 894	R 77 784
Bridge Rectifier						R 2 465	

Note: Prices Exclude VAT.

All prices and values are subject to change without prior notice.

FLAME PROOF MOTOR

W21Xd W22Xd



Minimum info required for orders and enquiries.

Flame Proof Motor

kW	
Speed	
Voltage	
Mounting	



5 Year Warranty on W22 Range

IP55 for W21Xd and IP66 for W22Xd

Class H insulation for 550V

Class **F** insulation for 400V

Δ 220-240V or Y 380-415V 50Hz (71 to 100 frame)

Δ 380-415V or Y 660-690V 50Hz (112 to 355 frame)

or

Y 550V (71 to 100 frame)

Δ 550V or Y 950V (112 to 355 frame)

Temperature class T4

Ex db I T4 Mb

Ex db IIB T4 Gb

Suitable for surface and underground

High voltage motors available on request

Certification: IECEX and local certification

Paint finish Dark Admiralty Grey RAL 7012 for W21Xd

Paint finish Red Munsell 7.5R 4/14 for W22Xd

All prices and values are subject to change without prior notice.

FLAME PROOF

380V / 400V / 415V or 550V / 950V

IP55/IP66

2 Pole					Mounting	
kW	r/min	Frame Size	Shaft Dia.(mm)	Weight (kg)	Foot Excl. VAT	Flange Excl. VAT
0.37	2805	71	14	18,1	R 12 879	R 13 557
0.55	2750	71	14	18,8	R 13 100	R 13 790
0.75	2850	80	19	22	R 13 992	R 14 728
1.1	2870	80	19	24	R 16 043	R 16 888
1.5	2840	90S/L	24	27,6	R 16 055	R 16 899
2.2	2840	90S/L	24	31,2	R 18 057	R 19 008
3	2880	100L	28	42,7	R 20 555	R 21 637
4	2890	112M	28	57,1	R 26 417	R 27 808
5.5	2935	132S/M	38	81,6	R 31 279	R 32 925
7.5	2920	132S/M	38	84,6	R 33 908	R 35 692
11	2945	160M/L	42	138	R 47 863	R 50 383
15	2945	160M/L	42	145	R 54 777	R 57 661
18.5	2945	160M/L	42	163	R 55 609	R 58 535
22	2950	180M/L	48	211	R 78 494	R 82 626
30	2965	200M/L	55	239	R 99 840	R 105 096
37	2965	200M/L	55	307	R 113 763	R 119 751
45	2965	225S/M	55	459	R 164 462	R 173 118
55	2965	250S/M	60	533	R 182 736	R 192 355
75	2965	250S/M	60	560	R 232 379	R 244 609
90	2975	280S/M	65	829	R 312 293	R 328 730
110	2975	280S/M	65	874	R 346 992	R 365 254
132	2970	315S/M	65	1025	R 414 219	R 436 020
160	2970	315S/M	65	1160	R 464 681	R 489 137

The motor highlighted in black is a W21Xd.

4 Pole					Mounting	
kW	r/min	Frame Size	Shaft Dia.(mm)	Weight (kg)	Foot Excl. VAT	Flange Excl. VAT
0,25	1380	71	14	18,4	R 13 404	R 14 110
0,37	1360	71	14	19,5	R 14 099	R 14 841
0,55	1410	80	19	23	R 14 798	R 15 578
0,75	1430	80	19	24,5	R 15 826	R 16 660
0,75	1425	90S/L	24	40,3	R 15 850	R 16 684
1,1	1415	80	19	25	R 16 115	R 16 963
1,1	1400	90S/L	24	28,2	R 16 360	R 17 221
1,5	1410	90S/L	24	31,8	R 17 125	R 18 027
2,2	1420	100L	28	42,7	R 19 855	R 20 901
3	1405	100L	28	44,1	R 20 555	R 21 637
4	1430	112M	28	59,6	R 23 746	R 24 995
5,5	1465	132S/M	38	92	R 36 189	R 38 093
7,5	1465	132S/M	38	91,4	R 39 738	R 41 829
11	1455	160M/L	42	137	R 51 582	R 54 298
15	1455	160M/L	42	156	R 58 804	R 61 899
18,5	1470	180M/L	48	205	R 77 965	R 82 069
22	1470	180M/L	48	229	R 83 502	R 87 897
30	1475	200M/L	55	291	R 105 946	R 111 521
37	1480	225S/M	60	401	R 142 439	R 149 937
45	1475	225S/M	60	433	R 155 721	R 163 916
55	1475	250S/M	70	516	R 182 066	R 191 648
75	1475	250S/M	70	550	R 205 099	R 215 893
90	1485	280S/M	80	884	R 285 324	R 300 339
110	1485	280S/M	80	944	R 287 698	R 302 841
132	1485	315S/M	85	1135	R 408 671	R 430 179
160	1480	315S/M	85	1197	R 436 638	R 459 618

Note: Prices Exclude VAT.

FLAME PROOF MOTOR

380V / 400V / 415V or 550V / 950 V

IP55/IP66

6 Pole					Mounting	
kW	r/min	Frame Size	Shaft Dia.(mm)	Weight(kg)	Foot Excl. VAT	Flange Excl. VAT
0.18	845	71	14	19,8	R 13 360	R 14 064
0.25	845	71	14	20	R 14 312	R 15 063
0.37	895	80	19	22	R 14 594	R 15 363
0.55	910	80	19	24,5	R 15 533	R 16 350
0.75	920	90S/L	24	30,5	R 16 236	R 17 092
1.1	915	90S/L	24	32	R 19 493	R 20 520
1.5	940	100L	28	40,3	R 19 562	R 20 593
2.2	940	112M	28	53,7	R 22 833	R 24 034
3	960	132S/M	38	73,8	R 30 918	R 32 546
4	960	132S/M	38	87,7	R 34 132	R 35 929
5.5	960	132S/M	38	95,8	R 40 068	R 42 176
7.5	970	160M/L	42	139	R 51 714	R 54 436
11	970	160M/L	42	164	R 59 461	R 62 591
15	965	180M/L	48	217	R 81 794	R 86 098
18.5	975	200M/L	55	272	R 102 280	R 107 663
22	975	200M/L	55	281	R 107 438	R 113 094
30	985	225S/M	60	425	R 152 339	R 160 356
37	980	250S/M	70	497	R 177 694	R 187 045
45	980	250S/M	70	552	R 193 877	R 204 082
55	985	280S/M	80	770	R 274 394	R 288 835
75	985	280S/M	80	795	R 267 159	R 281 220
90	985	315S/M	85	993	R 345 067	R 363 227
110	985	315S/M	85	1165	R 405 124	R 426 446

Note: Prices Exclude VAT.

FLAME PROOF W21Xd OR W22Xd - SPARE PARTS

List Prices (Rands)														
Description	Frame Size													
	71	80	90	100	112	132	160	180	200	225	250	280	315	355
Terminal Box with Lid	-	-	-	-	-	-	13 363	13 363	13 521	26 609	26 609	35 477	35 477	35 477
Terminal Box Lid	944	944	1 198	1 817	2 053	2 053	5 087	5 087	5 087	7 740	7 740	10 754	11 904	11 904
Terminal Block	484	484	484	484	1 169	1 169	1 176	1 176	2 081	8 400	8 400	9 012	9 012	13 475
Fan Cowl	1 169	1 169	1 169	1 540	1 623	1 838	2 402	2 610	3 926	8 751	9 266	10 762	16 437	20 991
Fan 2 pole Cast Iron	2 587	2 778	2 778	2 778	3 017	3 693	3 693	5 506	5 506	7 638	7 638	9 365	10 642	10 642
Fan 4 pole Cast Iron	2 587	2 778	4 166	6 466	8 233	10 900	10 067	10 067	12 459	15 409	15 409	19 144	19 144	28 258
B5 Flange	3 172	3 172	4 775	4 775	5 264	8 248	8 644	9 323	13 801	25 188	28 381	29 979	41 567	47 657
B14 Flange	2 216	2 941	3 409	7 445	7 573	7 825	-	-	-	-	-	-	-	-
Drive Endshield	2 063	2 223	2 409	3 052	3 052	3 381	6 760	6 857	7 231	17 146	27 611	24 894	30 804	42 926
Non - drive Endshield	3 808	3 808	4 329	5 979	5 979	5 979	7 551	7 852	8 574	18 331	22 469	25 424	32 520	44 405
DE Bearing Cap	-	-	1 606	2 871	2 871	2 871	3 676	3 676	3 676	13 303	14 012	14 012	16 910	25 544
NDE Bearing Cap	-	-	2 920	2 920	2 920	2 920	6 431	6 431	6 431	12 534	12 534	15 847	15 847	17 146

Note: Prices Exclude VAT.

When placing orders, please specify if the parts are for W21Xd or W22Xd Flame Proof Motors.

SLIDE RAILS

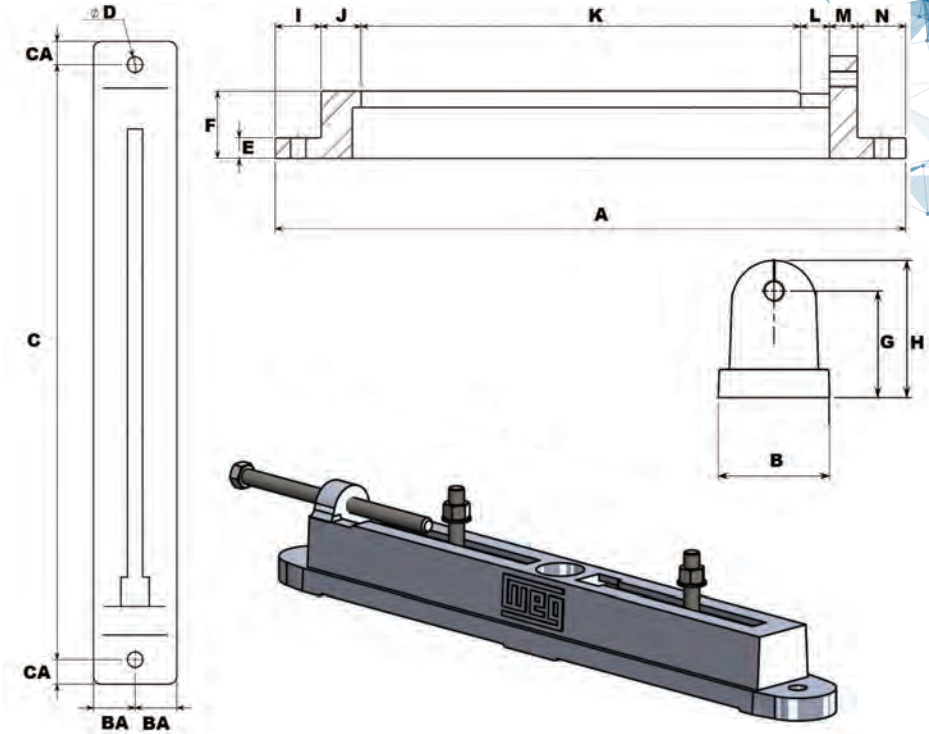

SLIDE RAILS

Frame Size	A	B	BA	C	CA	D	E	F	G	H	I	J	K	L	M	N	List Price (per pair)
80/90	355	35	18	325	10	10	12	30	36	55	38	14	235	148	19	38	R 6 205
100/112/132	470	52	25	430	20	12	16	44	50	70	38	17	325	24	20	38	R 7 364
160/180	615	78	38	565	25	15	19	64	74	100	50	21	435	32	28	50	R 11 752
200/225	785	104	50	725	30	19	25	82	94	125	56	48	550	56	35	58	R 17 240
250/280	985	100	50	885	40	24	30	100	111	145	77	25	710	40	37	68	R 27 294
315/355	1215	120	60	1115	50	26	40	125	145	180	65	20	925	50	42	68	R 36 261

Slide rails for motors with frame sizes 225 and above come with a mounting hole in the centre.

Note: Prices Exclude VAT.





INVICTA

Vibrator Motor



Minimum info required for orders and enquiries.

Invicta Vibrator Motor

Footprint	
kW	
Speed	
Voltage	
Kgf	



Winston Olivier

+27 11 723 6210

+27 82 889 5756

WOlivier@zestweg.com

2 YEAR WARRANTY ON INVICTA RANGE

IP66

Class F Insulation

Group 28 (Δ 380-415V or Y 660-690V)

Group 03 (Y 525-550V)

Centrifugal force 50kgf - 31 500kgf

Output Range 70W-12500W

S1 Duty

Zone 21/22

Mounting Options

B3 (foot/base) Vertical and Horizontal

B5 (flange) Vertical

Pneumatic B3 (foot/base) Vertical and Horizontal

Hydraulic B3 (foot/base) Vertical and Horizontal

All prices and values are subject to change without prior notice.

INVICTA VIBRATOR MOTOR

Class F Insulation

380V/400V/415V/690V

IP66

525V/550V

	Model No.	Mounting	Output Rating Watt	Centrifugal Force kgf	Working Moment (x2) kg.cm.	
2 Pole 2880 r/min						
IVBLZ03-1/2...	BLz03-1/2	Base	120	100	2.16	
IVBLZ05-2/2	BLz05-2/2	Base	200	200	4.3	
IVBLZ15-3.5/2	BLz15-3.5/2	Base	300	350	7.6	
IVBLZ20-5/2	BLz20-5/2	Base	400	500	10.8	
IVBLz22-5/2	BLZ22-5/2	Base	400	500	10.8	
IVBLZ24-8/2	BLz24-8/2	Base	500	800	17.2	
IVBLZ24-10/2	BLz24-10/2	Base	500	1000	21.6	
IVBLz24-13/2	BLz24-13/2	Base	500	1300	28	
IVBLz25-8/2	BLz25-8/2	Base	500	800	17.2	
IVBLZ25-10/2	BLz25-10/2	Base	500	1000	21.6	
IVBLZ25-13/2	BLz25-13/2	Base	500	1300	28	
IVBLZ30-16/2	BLz30-16/2	Base	1100	1600	34.5	
IVBLZ30-20/2	BLz30-20/2	Base	1100	2000	43.2	
IVBLZ40-30/2	BLz30-40/2	Base	1500	3000	64.7	
IVBLZ40-40/2	BLz40-40/2	Base	1500	4000	86.3	
IVBLZ45-50/2	BLz45-50/2	Base	4000	5000	108	
4 Pole 1440 r/min						
IVBLZ03-0.5/4	BLz03-0.5/4	Base	100	50	4.3	
IVBLZ05-1/4	BLz05-1/4	Base	175	100	8.6	
IVBLZ05-2/4	BLz05-2/4	Base	175	200	17.2	
IVBLZ15-3/4	BLz15-3/4	Base	300	300	26	
IVBLZ20-5/4	BLz20-5/4	Base	350	500	43.1	
IVBLZ22-5/4	BLz22-5/4	Base	350	500	43.1	
IVBLZ24-7.5/4	BLz24-7.5/4	Base	500	750	64.7	
IVBLZ24-11/4	BLz24-11/4	Base	500	1100	94.9	
IVBLZ24-14/4	BLz24-14/4	Base	500	1400	121	
IVBLZ25-7.5/4	BLz25-7.5/4	Base	500	750	64.7	
IVBLZ25-11/4	BLz25-11/4	Base	500	1100	94.9	
IVBLZ25-14/4	BLz25-14/4	Base	500	1400	121	
IVBLZ30-18/4	BLz30-18/4	Base	1150	1800	155	
IVBLZ30-25/4	BLz30-25/4	Base	1150	2500	216	
IVBLZ40-35/4	BLz40-35/4	Base	1800	3500	302	
IVBLZ45-45/4	BLz45-45/4	Base	2685	4500	388	
IVBLZ50-55/4	BLz50-55/4	Base	3350	5500	474	
IVBLZ50-65/4	BLz50-65/4	Base	4800	6500	560	
IVBLZ50-75/4	BLz50-75/4	Base	4800	7500	647	
IVBLZ60-95/4	BLz60-95/4	Base	7750	9500	820	
IVBLZ60-105/4	BLz60-105/4	Base	7750	10500	906	
IVBLZ75-130/4	BLz75-130/4	Base	10250	13000	1122	



INVICTA VIBRATOR MOTOR

Class F Insulation

380V/400V/415V/690V

IP66

525V/550V

	Model No.	Mounting	Output Rating Watt	Centrifugal Force kgf	Working Moment (x2) kg.cm.
6 Pole 960 r/min					
IVBLZ03-0.2/6	BLz03-0.2/6	Base	70	22	4.3
IVBLZ05-0.4/6	BLz05-0.4/6	Base	90	40	7.8
IVBLZ05-0.9/6	BLz05-0.9/6	Base	90	90	17.5
IVBLZ15-1.3/6	BLz15-1.3/6	Base	110	130	25.2
IVBLZ20-2.2/6	BLz20-2.2/6	Base	150	220	42.7
IVBLZ22-2.2/6	BLz22-2.2/6	Base	150	220	42.7
IVBLZ24-4/6	BLz24-4/6	Base	510	400	77.6
IVBLZ24-8/6	BLz24-8/6	Base	510	800	155
IVBLZ24-11/6	BLz24-11/6	Base	510	1100	213
IVBLZ25-4/6	BLz25-4/6	Base	510	400	77.6
IVBLZ25-8/6	BLz25-8/6	Base	510	800	155
IVBLZ25-11/6	BLz25-11/6	Base	510	1100	213
IVBLZ30-14/6	BLz30-16/4	Base	900	1600	1122
IVBLZ30-18/6	BLz30-18/6	Base	900	1800	349
IVBLZ30-23/6	BLz30-23/6	Base	900	2300	446
IVBLZ40-27/6	BLz40-27/6	Base	1800	2700	524
IVBLZ40-35/6	BLz40-35/6	Base	1800	3500	680
IVBLZ45-42/6	BLz45-42/6	Base	2310	4200	815
IVBLZ45-50/6	BLz45-50/6	Base	2310	5000	970
IVBLZ50-60/6	BLz50-60/6	Base	4000	6000	1164
IVBLZ50-75/6	BLz50-75/6	Base	4000	7500	1455
IVBLZ60-90/6	BLz60-90/6	Base	6200	9000	1746
IVBLZ60-105/6	BLz60-105/6	Base	6200	10500	2037
IVBLZ60-125/6	BLz60-125/6	Base	10000	12500	2425
IVBLZ75-150/6	BLz75-150/6	Base	10000	15000	2910
IVBLZ75-185/6	BLz75-185/6	Base	10000	18500	3589
IVBLZ78-165/6	BLz78-165/6	Base	10000	16500	3201
IVBLZ78-185/6	BLz78-185/6	Base	10000	18500	3589
IVBLZ80-230/6	BLz80-230/6	Base	12500	23000	4462
IVBLZ80-270/6	BLz80-270/6	Base	12500	27000	5238
IVBLZ80-315/6	BLz80-315/6	Base	12500	31500	6111
8 Pole 720 r/min					
IVBLZ30-7.5/8	BLz30-7.5/8	Base	500	750	259
IVBLZ30-10/8	BLz30-10/8	Base	500	1000	345
IVBLZ40-15/8	BLz40-15/8	Base	1100	1500	517
IVBLZ45-24/8	BLz45-24/8	Base	2000	2400	838
IVBLZ50-35/8	BLz50-35/8	Base	3300	3500	1207
IVBLZ50-45/8	Blz50-45/8	Base	3300	4500	1552
IVBLZ50-55/8	Blz50-55/8	Base	3300	5500	1897
IVBLZ60-65/8	BLz60-65/8	Base	4900	6500	2242
IVBLZ60-90/8	BLz60-90/8	Base	4900	9000	3105
IVBLZ75-124/8	BLz75-124/8	Base	7750	12400	4279
IVBLZ75-135/8	BLz75-135/8	Base	7750	13500	4658
IVBLZ75-150/8	BLz75-150	Base	7750	15000	5174
4 Pole 1440 r/min					
IVSWL25-9.6/4	SWL25-9.6/4	Flange	500	960	82.8
IVSWL40-35/4	SWL40-35/4	Flange	1800	3500	302
IVSFL20-5/4	SFL20-5/4	Flange	450	500	43.1

OPTIONAL FEATURES

List Prices (Rands) Including Fitment															
Frame Size															
Description	Code	63 - 71	80	90	100	112	132	160	180	200	225	250	280	315	355
PT100 1/Bearing c/w auxiliary box	B	-	-	-	-	-	7855	7855	7855	7855	7855	7855	7855	7855	7855
PT100 2/Bearing c/w auxiliary box	BB	-	-	-	-	-	-	15710	15710	15710	15710	15710	15710	15710	15710
Colour Change	C	1371	1371	1371	1371	1371	1371	1371	1371	1371	2397	2397	2397	2397	2397
Rain Canopy	D	1877	1877	1877	2029	2304	2304	2798	3013	3285	5937	6789	8495	8723	11276
Epoxy Paint	E	2741	2741	2741	2741	2741	2741	2741	2741	2741	4794	4794	4794	4794	4794
Cast Iron Fan	F	4042	4184	4367	4367	4367	9610	11367	11367	12163	13664	16523	16523	20117	20117
Heater c/w auxiliary box	H	6401	6401	6401	6401	6401	6401	7538	7538	7538	8674	8674	8674	8674	8674
IP56 (Pad Mount Only)	IP56	2000	2031	2031	2074	2074	2074	2082	2206	2332	8984	8984	-	-	-
IP65 (Pad Mount Only)	IP65	2000	2031	2031	2074	2074	2074	2082	2206	2332	8984	8984	-	-	-
Provision for Vibration Sensor 1/Bearing	L	2437	2437	2437	2437	2437	2437	2437	2437	2437	2437	2437	2437	2437	2437
Provision for Vibration Sensor 2/Bearing	LL	4873	4873	4873	4873	4873	4873	4873	4873	4873	4873	4873	4873	4873	4873
Routine Test	R	3297	3297	3297	3297	3297	5156	5156	5156	5156	5156	5948	5948	5948	5948
Thermistor c/w auxiliary box	T	5181	5181	5181	5181	5181	5181	5466	5466	5466	6602	6602	6602	6602	6602
2 x Thermistors c/w auxiliary box	TT	8371	8371	8371	8371	8371	8371	8655	8655	8655	9162	9162	9162	9162	9162
Vibration Test	V	3297	3297	3297	3297	3297	5156	5156	5156	5156	5156	5948	5948	5948	5948
PT100 1/Winding c/w auxiliary box	W	-	-	-	-	-	-	7795	7795	7795	8933	8933	8933	8933	8933
PT100 2/Winding c/w auxiliary box	WW	-	-	-	-	-	-	15593	15593	15593	17867	17867	17867	17867	17867
Tropicalization & Heater	X	6583	6583	6583	6583	6583	6583	6867	6867	6867	10055	10055	10055	10055	10055
Zone 21/22 & Zone 2 *	Z	2427	2468	2485	2531	2860	3059	3816	4458	5442	19412	22079	22523	25758	33405
Solid Earthing - for shaft grounding	O	-	-	-	-	-	-	-	-	-	12012	12012	12012	12012	12012

Note: Prices Exclude VAT.

*** Zone 21/22 & Zone 2 prices are for IE3 and IE4 motors only.**

Earthrings



W Seal



W3 Seal



SPARE PARTS FOR CAST IRON MOTORS

List Prices (Rands)															
Frame Size															
Description	63	71	80	90	100	112	132	160	180	200	225	250	280	315	355
Earth Stud	246	246	246	246	246	360	360	612	612	950	2743	2743	2743	2743	2743
Rain Canopy	867	867	867	867	995	1226	1226	1644	1828	2055	4301	5023	6466	6658	8817
Shaft Slinger	65	65	65	95	95	121	138	213	225	288	334	334	334	358	358
Auxiliary box	1053	1053	1053	1053	1053	1053	1053	1203	1203	1203	1803	1803	1803	1803	1803
Terminal box with Cover	699	699	699	931	931	1314	1314	1902	1902	2832	4707	4707	8637	13138	22233
Terminal block	437	437	437	437	650	650	650	1070	1070	1887	3497	3497	6670	6670	12920
Terminal box Adaptor	-	-	-	-	-	-	-	-	-	-	4341	4341	5113	7106	8378
Fan cowl	308	308	308	336	435	504	694	1606	1968	3002	8860	8860	13614	13614	21162
Brake motor fan cowl	2164	2164	2164	2164	2164	2598	2598	4760	4760	7167	7167	-	-	-	-
Fan 2 pole (plastic)	81	87	99	99	151	151	151	151	151	225	749	749	899	899	-
Fan 4 pole (plastic)	81	87	99	99	225	245	308	308	308	336	926	926	1111	1111	-
Fan 2 pole (aluminium)	616	616	702	702	893	893	926	1062	1062	1062	1915	1915	2325	2750	-
Fan 4 pole (aluminium)	616	778	980	1297	1297	1650	1650	1699	1699	1699	2335	2750	5407	8822	8822
Fan 2 pole (cast iron)	2330	2587	2778	4166	6466	3017	4766	3693	3313	5517	6962	6962	8534	9696	10668
Fan 4 pole (cast iron)	2330	2587	2778	4166	6466	8233	10900	10067	10067	12459	14034	14034	17438	17438	28258
Fan 2 pole (Non-conductive plastic)	110	110	110	194	243	353	476	838	1464	1716	5077	5077	5077	5077	5077
Fan 4 pole (Non-conductive plastic)	110	110	110	194	243	338	472	819	1269	1885	5077	5077	5077	5077	-
B5 flange	1144	1306	1730	1730	2444	2444	3454	6975	6975	9507	14915	18738	18738	25044	32244
B14 flange	1198	1198	1580	1838	2122	2148	2835	-	-	-	-	-	-	-	-
Drive endshield	368	407	491	543	750	997	1374	2281	3189	4294	6768	7983	10591	44053	53973
Non - drive endshield	368	407	491	543	750	997	1374	2281	3189	4294	6768	7983	10591	44053	53973
Bearing cap sets for oil seal	-	166	166	302	423	569	650	665	818	780	4950	4950	4883	6056	8310
Bearing cap sets for W seal	-	-	-	-	-	-	-	-	-	-	2819	2819	3273	4209	6001
Bearing cap sets for W3 seal	-	-	-	-	-	-	-	-	-	-	7735	7735	11165	11165	11165

Prices exclude VAT.

Shaft Seal Prices						
Frame Size	Bearing Size		W Seal		W3 Seal	
	DE	NDE	DE	NDE	DE	NDE
225	6314 C3	6314 C3	1160	1160	3497	3497
250	6314 C3*	6314 C3	1160	1160	3497	3497
250	6316 C3	6314 C3	1241	1160	4883	3497
280	6314 C3*	6314 C3*	1160	1160	3497	3497
280	NU-319 C3	6316 C3	1241	1241	4883	4883
315	6314 C3*	6314 C3*	1160	1160	3497	3497
315	NU-319 C3	6316 C3	1241	1241	4883	4883
315	6316 C3*	6316 C3	1241	1241	4883	4883
355	6319 C3*	6316 C3*	1323	1241	7095	4883
355	NU-322 C3	6319 C3	1323	1323	7095	7095

* For 2 pole motors

Please specify motor model: W20, W21 or W22.

DIMENSIONS FOR W22 RANGE

Foot Mount

FRAMES 63 TO 132M/L

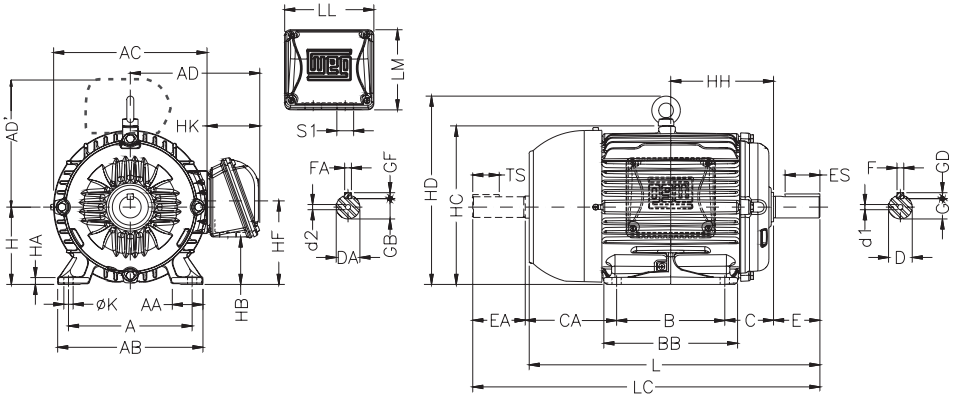

FRAMES 160M TO 200L

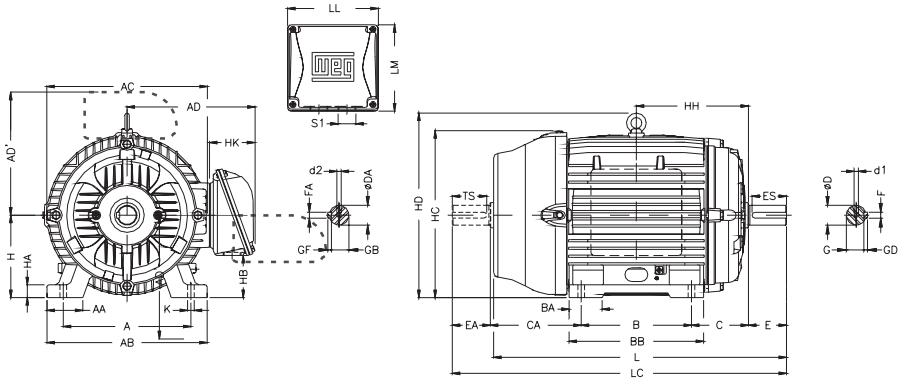

Frame	A	AA	AB	AC	AD	AD' (**)	B	BA	BB	BD	C	CA	Shaft																			
													D	DA	E	EA	ES	F	FA	G	GB	GD	GF	TS								
63	100	25.5	116	125	123	123	80		95		40	78	11j6	9j6	23	20	14	4	3	8.5	7.2	4	3	12								
71	112	28.5	132	141	131	131	90		113.5		45	88	14j6	11j6	30	23	18	5	4	11	8.5	5	4	14								
80	125	30.5	149	159	140	140	100	125.5	131	156	56	104	24j6	16j6	50	40	36	6	5	20	13	6	5	28								
L80																																
90S																																
90L												125	156	104	24j6	16j6	50	40	36	6	5	20	13	6	5	28						
L90S												100	131	104																		
L90L												125	156		104																	
100L	160	40	188	199	169	169	140	173	177	63	118	28j6	22j6	60		50	45	6	6	24	18.5	20	6	6	36							
L100L											162																					
112M											190	40.5	220	222	192	192	178	225	187	70	128	24j6	80	60	63	10	8	33	24	8	7	45
132S											216	45	248	272	220	220	178	225	187	70	128	24j6										
132M											216	45	248	272	220	220	178	225	187	70	128	24j6	80	60	63	10	8	33	24	8	7	45
132M/L																																
160M	254	64	308	329	266	266	210	254	294	108	174	42k6	42k6	110	110	80	12	12	37	37	9	8										
160L							254	298																								
180M	279	78	350	360	281	281	241	294	332	121	200	48k6	48k6	110	110	80	14	14	42.5	42.5	9	80										
180L							279	332																								
200M	318	82	385	402	319	319	267	305	370	133	222	55m6	48k6	110	110	80	16	49	10	10	10	10										
200L							305	370																								

Frame	H	HA	HB	HC	HD	HF	HG	HH	HK	K	L	LC	LL	LM	S1	D1	D2	Bearings				
																		D.E	N.D.E.			
63	63	7	25.5	130	68.5	80	59	7	216	241	108.5	99	1xM20x1.5	EM4	EM3	6201 ZZ						
71	71		33	145													76	90	59	7	248	276
80	80	8	43.5	163	87	100	59	10	276	313	108	98	1xM20x1.5	DM6	DM4	6204 ZZ	6203 ZZ					
L80																		325	362			
90S	90	9	45	182	90	106	59	10	304	350	108	98	1xM20x1.5	DM8	DM6	6205 ZZ	6204 ZZ					
L90S						106												335	381			
90L						118.5	59	10	329	375	108	98	1xM20x1.5	DM8	DM6	6205 ZZ	6204 ZZ					
L90L						106												360	403			
100L						100	10	61.5	205	244	106.4	59	10	376	431	108	98	1xM20x1.5	DM10	DM8	6206 ZZ	6205 ZZ
L100L																						
112M	112	16	54.5	235	280	112	80	12	393	448	140	133	1xM25x1.5	DM12	DM10	6308 ZZ	6207 ZZ					
132S																		159	452	519		
132M	132	16	75	274	319	132	80	12	490	557	140	133	1xM25x1.5	DM12	DM10	6308 ZZ	6207 ZZ					
132M/L																		178	490	557		
160M	160	22	79	331	374	168	101	14.5	515	582	198.5	190	2xM25x1.5	DM16	DM16	6309 C3	6209 Z-C3					
L160L																		213	598	712		
180M	180	28	92	366	413	180	101	14.5	642	756	198.5	190	2xM32x1.5	DM16	DM16	6311 C3	6211 Z-C3					
L180L																		235	664	782		
200M	200	30	119	407	464	218	119.5	18.5	702	820	230	220	2xM32x1.5	DM20	DM20	6312 C3	6212 Z-C3					
200L																		266.5	729	842		
							285.5		767	880												

Note: For IEC frames, the letter "L" means being in accordance with IE3 efficiency levels. This difference occurs due to the increase of the total length of the motor.

DIMENSIONS FOR W22 RANGE

Foot Mount

FRAMES 225S/M TO 355M/L

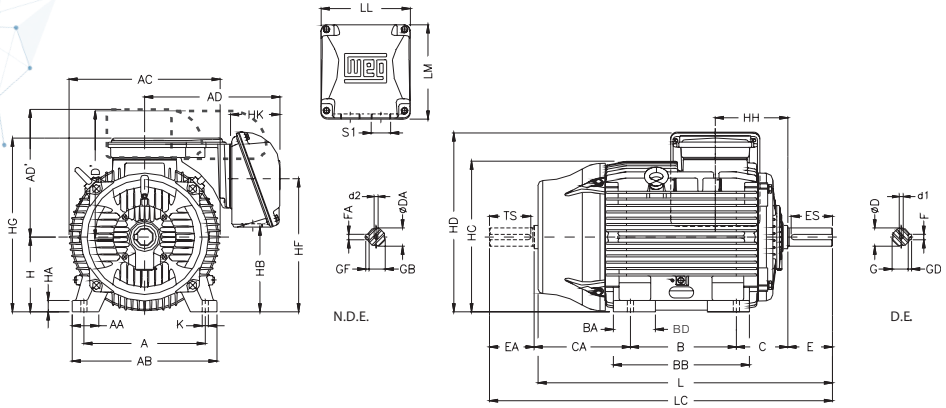

FRAME 355A/B

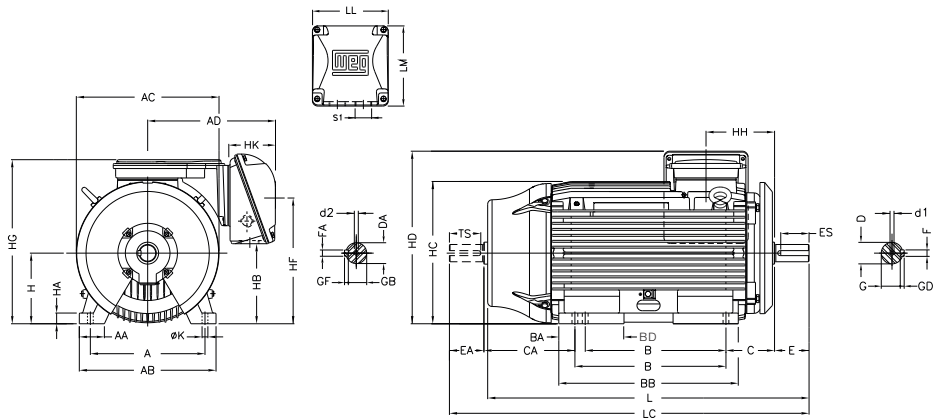

Frame	A	AA	AB	AC	AD	AD' (**)	B	BA	BB	BD	C	CA	Shaft												
													D	DA	E	EA	ES	F	FA	G	GB	GD	GF	TS	
225S/M	356	80	436	455	410	384	286/311	124	412	41	149	319/294	55m6*	55m6*	110*	110*	100*	16*	16*	49*	49*	10*	10*	100*	
													60m6	60m6	140	140	125	18	18	53	53	11	11	125	
250S/M	406	100	506	486	402	311/349	146	467	59	168	354/316	494/443	60m6*	60m6	140	125	18*	20	53*	53	11*	12	11	125	
													70m6												65m6*
280S/M	457	100	557	599	445	472	368/419	151	517	49	190	385/334	494/443	65m6*	60m6*	140*	125*	18*	160	22	71	58	14	11	125
														80m6											
315S/M	508	120	630	657	525	530	406/457	184	621	70	216	494/443	494/443	65m6*	60m6*	140*	125*	18*	160	22	58*	53*	11*	11	125
														70m6*											
315S/M (***)	508	120	630	657	589	575	508	219	752	81	216	502	494/443	90m6	65m6	140*	125*	20*	160	25	81	58	14	11	125
315L														70m6*											
355M/L	610	140	750	736	609	625	560/630	230	760	65	254	483/413	483/413	90m6*	60m6*	170*	140*	160*	25*	18*	81*	53*	14*	11*	125*
					701	725	710/800	325	965	70				281	528/438	100m6	80m6	210	170	200	28	22	90	71	16
355A/B	610	140	750	736	697	763	710/800	325	965	70	286	528/438	528/438	110m6	80m6	210	170	200	28	22	100	71	16	14	160
					609	655	110m6	80m6	210	170				200											

Frame	H	HA	HB	HC	HD	HF	HG	HH	HK	K	L	LC	LL	LM	S1	D1	D2	Bearings	
																		D.E	N.D.E.
225S/M	225	34	254	453	541	421	534	212	153	18.5	856*	974*	269	285	2xM32x1.5	DM20	DM20	6314 C3	
250S/M	250	43	297	493	583	463	577	214			965	1113						2xM40x1.5	
280S/M	280	42	386	580	700	572	686	266	147	24	1071*	1223*	314	312	2xM50x1.5	DM20	DM20	6314 C3*	6314 C3*
											1101	1253						6316 C3	6316 C3
315S/M	315	48	644	768	592	751	264	176	220	28	1244*	1392*	379	382	2xM63x1.5	DM20	DM20	6314 C3*	6314 C3*
											1274	1426						6316 C3*	6316 C3
315S/M (***)	315	48	644	768	592	751	264	176	220	28	1244*	1392*	379	382	2xM63x1.5	DM20	DM20	6314 C3*	6314 C3*
											1274	1426						6316 C3*	6316 C3
315L	315	48	336	774	575	760	284	220	28	28	1353*	1501*	404	436	2xM80x2	DM20	DM20	6316 C3*	6316 C3
											1383	1536						6316 C3*	6316 C3
355M/L	355	50	461	898	700	885	340	290	28	28	1442*	1607*	460	544	2xM80x2	DM20	DM20	6316 C3*	6316 C3
											1482	1677						6316 C3*	6316 C3
355A/B	355	50	411	955	700	898	340	290	28	28	1637*	1802*	460	544	2xM80x2	DM20	DM20	6319 C3*	6319 C3
											1677	1872						6319 C3*	6319 C3
355A/B	355	50	405	895	700	898	372	220	28	28	1704	1899	460	544	2xM80x2	DM20	DM20	6319 C3*	6319 C3
											1709	1904						6319 C3*	6319 C3
355A/B	355	50	461	895	700	898	372	220	28	28	1709	1904	460	544	2xM80x2	DM20	DM20	6319 C3*	6319 C3
											1709	1904						6319 C3*	6319 C3

*Dimension applicable to 2-pole motors

**Dimension applicable to top mounted terminal box

***For 185 kW and larger

Note: For IEC frames, the letter "L" means being in accordance with IE3 efficiency levels. This difference occurs due to the increase of the total length of the motor.

DIMENSIONS FOR W22 RANGE

Pad Mount



FRAMES 80 TO 200L

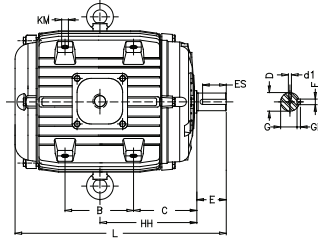
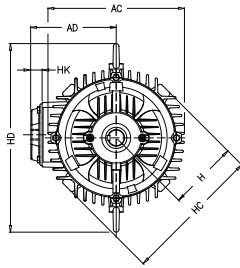

FRAMES 225S/M

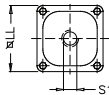
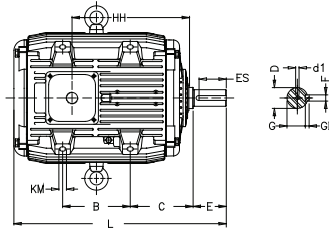
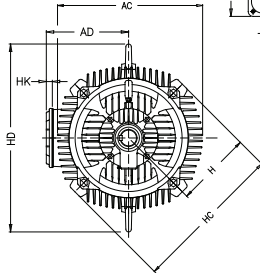

FRAME 250S/M

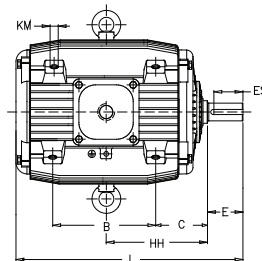
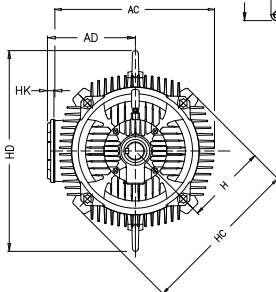

Frame	Front view						Left side view				
	AC	AD	H	HC	HD	HK	B	C	HH	KM	L
63	125	86	75	150	-	20	63	48.5	80	M8x1.25x10	182
71	141	94	75	150	-	20	71	54.5	90	M8x1.25x10	207
80	159	103	85	170	-	20	80	60	100	M12x1.75x18	238
90S	179	113	95	190	-	20	65	73.5	106	M12x1.75x18	258
100L	206	133	105	210	-	30	100	83	133	M12x1.75x18	322
112M	215	160	117	234	316	45	100	90	140	M12x1.75x18	338
132S	260	188	145	290	374	45	125	96.5	159	M16x2x24	393
132M	260	188	145	290	374	45	140	108	178	M16x2x24	430
L132M	260	188	145	290	374	45	140	108	178	M16x2x24	457
160M	319	193	180	360	428	25	156	135	235	M20x2.5x30	574
160L	319	193	180	360	428	25	200	135	235	M20x2.5x30	574
180L	360	208	184.5	369	465	25	200	160.5	260.5	M20x2.5x30	622
200L	380	221	215.5	431	528	18	224	173.5	285.5	M24x3x41	676
225SM*	455	279	255	510	624	20	224	192.5	413	M24x3x45	727
225SM	455	279	255	510	624	20	224	192.5	413	M24x3x45	757
250SM*	486	279	255	510	625	20	224	230.5	343	M24x3x45	824
250SM	486	279	255	510	625	20	224	230.5	343	M24x3x45	824

Frame	Entry plate detail		Shaft end detail						
	LL	S1	D	D1	E	ES	F	GD	G
63	80	M20X1.5	11j6	EM4	23	14	4	4	8.5
71	80	M20X1.5	14j6	DM5	30	18	5	5	11
80	80	M20X1.5	19j6	DM6	40	28	6	6	15.5
90S	80	M20X1.5	24j6	DM8	50	36	8	7	20
90L	80	M20X1.5	24j6	DM8	50	36	8	7	20
100L	80	M25x1.5	28j6	DM10	60	45	8	7	24
112M	104	M25x1.5	28j6	DM10	60	45	8	7	24
132S	104	M25x1.5	38k6	DM12	80	63	10	8	33
132M	104	M25x1.5	38k6	DM12	80	63	10	8	33
L132M	104	M25x1.5	38k6	DM12	80	63	10	8	33
160M	140	M32x1,5	42k6	DM16	110	80	12	8	37
160L	140	M32x1,5	42k6	DM16	110	80	12	8	37
180L	140	M32x1,5	48k6	DM16	110	80	14	9	42.5
200L	155	M50x1.5	55m6	DM20	110	80	16	10	49
225SM*	196	M50x1.5	55m6	DM20	110	100	16	10	49
225SM	196	M50x1.5	60m6	DM20	140	125	18	11	53
250SM*	196	M63x1.5	60m6	DM20	140	125	18	11	53
250SM	196	M63x1.5	65m6	DM20	140	125	18	11	58

*Notes: 1) Dimensions for 2 pole motors.

DIMENSIONS FOR W22 RANGE

Flange Mount

“FF” FLANGE (B5)

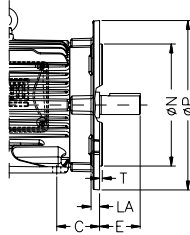
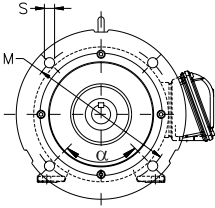

Flange “FF”									
Frame	Flange	LA	M	N	P	S	T	N° of holes	
63	FF-115	9	115	95	140	10	3	45°	4
71	FF-130		130	110	160				
80	FF-165	10	165	130	200	12	3.5		
90									
100	FF-215	11	215	180	250	15	4		
112									
132	FF-265	12	265	230	300	19	5		
160	FF-300	18	300	250	350				
180									
200	FF-350	18	350	300	400	19	5		
225	FF-400		400	350	450				
250	FF-500	18	500	450	550	19	5	22°30'	8
280									
315	FF-600	22	600	550	660	24	6		
355	FF-740		740	680	800				

“C-DIN” Flange (B14)

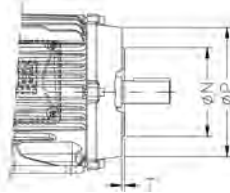
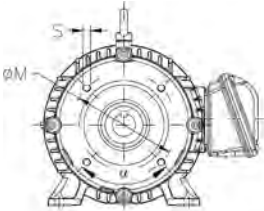

Frame	Flange	B14 Small					T	N° of Holes	B14 Large			
		M	N	P	S	M			N	P	S	
63	C-90	75	60	90	M5	2,5	45°	4	100	80	120	M6
71	C-105	85	70	105	M6				115	95	140	M8
80	C-120	100	80	120		M8			3	130	110	
90	C-140	115	95	140	M8				3,5	165	130	200
100	C-160	130	110	160								
112	C-160	165	130	200	M10	3,5	45°	4	215	180	250	M10
132	C-200											



DIMENSIONS FOR W22 FANS

IE1, IE3 & IE4

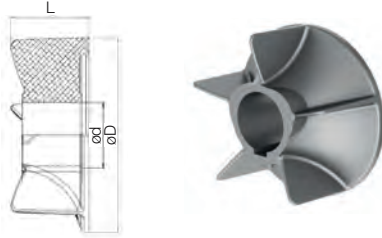

IE1																			
Poles	Frame	63	71	80	90S	100	112	132	160	180	200	Pole	225	250	280	315S/M	315L	355M/L	355A/B
2 Pole	Outside diameter D(mm)	109 - 110	120 - 126	132 - 140	132 - 140	175 - 182	150	170	150 - 156	150 - 156	175	2 Pole	190 - 194	212 - 225	234 - 242			265	
	Hub diameter d (mm)	10	12	15	15	23	28	30	44	50	55		65	65	65			65	
	Width L(mm)	16-17	22-25	23-25	23-25	36-40	37-38	39-40	42-47	47	55-58		66 - 81	66 - 83	66 - 92			102	
4 Pole	Outside diameter D(mm)	109 - 110	120 - 126	132 - 140	132 - 140	175 - 182	190 - 200	230 - 237	230	230	260	4 Pole	395 - 312	312 - 335	312 - 335	420			
	Hub diameter d (mm)	10	12	15	15	23	28	30	44	50	55		65	65	65	65			
	Width L(mm)	16-17	22-25	23-25	23-25	36-40	37-38	40-42	47	47	58		77 - 115	77 - 105	77 - 105	134			
6 - 8 Pole	Outside diameter D(mm)	109 - 110	120 - 126	132 - 140	132 - 140	175 - 182	190 - 200	230 - 237	230	230	260	6 - 8 Pole	395 - 312	312 - 335	312 - 335	420	511		
	Hub diameter D (mm)	10	12	15	15	23	28	30	44	50	55		65	65	65	65	65		
	Width L(mm)	16-17	22-25	23-25	23-25	36-40	37-38	40-42	47	47	58		77 - 115	77 - 105	77 - 105	134	126		

IE3 & IE4																			
Poles	Frame	63	71	80	90S	100	112	132	160	180	200	Pole	225	250	280	315S/M	315L	355M/L	355A/B
2 Pole	Outside diameter D(mm)	109 - 110	120 - 126	132 - 140	132 - 140	175 - 182	110	170	150 - 156	150	175	2 Pole	190 - 194	212 - 225	234 - 242			265	
	Hub diameter d (mm)	10	12	15	15	23	28	28	44	50	55		65	65	65			65	
	Width L(mm)	16-17	22-25	23-25	23-25	36-40	37-38,5	37-38	42-47	45-47	55-58		66 - 81	66 - 83	66 - 92			102	
4 Pole	Outside diameter D(mm)	109 - 110	120 - 126	132 - 140	132 - 140	175 - 182	150	170	150 - 156	150	175	4 Pole	212 - 225	295 - 312			312 - 335	312 - 335	420
	Hub diameter d (mm)	10	12	15	15	23	28	30	44	50	55		65	65	65			65	65
	Width L(mm)	16-17	22-25	23-25	23-25	36-40	37-38	39-40	42-47	45-47	55-58		77 - 115	77 - 105	77 - 105	134			
6 - 8 Pole	Outside diameter D(mm)	109 - 110	120 - 126	132 - 140	132 - 140	175 - 182	190 - 200	230 - 237	230	230	230	6 - 8 Pole	295 - 312	312 - 335	312 - 335	420	511		
	Hub diameter d (mm)	10	12	15	15	23	28	30	44	50	55		65	65	65	65	65		
	Width L(mm)	16-17	22-25	23-25	23-25	36-40	37-38	40-42	42-47	47	58		77 - 115	77 - 105	77 - 105	134	126		

DIMENSIONS FOR W22 TERMINAL BOX

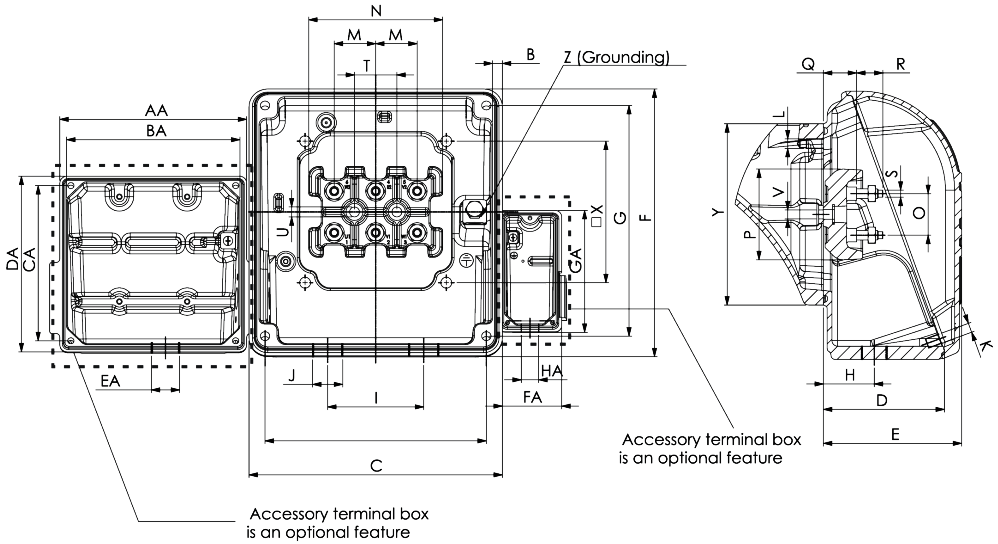

Frame	A	B	C	D	E	F	G	H	I	J	J(*)	K	L	M	N	O	P	Q	R	S	T	U	
63																							
71	90	8	108.5	50	59	99	85	27															
80									42	M20x1.5	M20x1.5	M5x0.8	M5x0.8	16	53	16	35	15.5	12	M4x0.7	20	5.8	
90	98		115	58	67	104	91	31															
100		7																					
112	117		140	69	80	133	117	36	54	M25x1.5		M6x1.0	M6x1.0	23	75	23	52	17	16	M5x0.8	23	6.5	
132										2xM25x1.5	M32x1.5	M8x1.25	M8x1.25	28	90	28	60	21.5	20.5	M6x1.0	28	6.6	
160	175	8.5	198.5	86	101	190	175	46	84	2xM32x1.5				35	112	35	74	24	24	M8x1.25	35	9.5	
180											M40x1.5	M10x1.5	M10x1.5	44	140	44	94	32.5	28	M10x1.5			
200	204	9.5	230	101.5	119.5	220	204	56	94	2xM40x1.5													
225S/M	235	12.5	269	127	153	285	260		110	2xM50x1.5	M50x1.5	M12x1.75	M12x1.75	45	153	45	108	35.5	40	M12x1.75			
250S/M								68		2xM63x1.5											45	10.5	
280S/M	275	13.5	314	130	147	312	275		126	2xM80x2	M63x1.5	M14x2.0	M14x2.0	65	210	65	146	51	45	M16x2.0	65		
315S/M	340		379	156	176	382	345	82	160					80	-	105	-	-	-	M20x2.5	-	-	
315L	365	14.5	404	195.5	220	436	390	97	200														
355M/L																							
355A/B	415		460	250	290	544	480	127	160														

Frame	V	X	Y	Z	AA	BA	CA	DA	EA	FA	GA	HA	Maximum Connector Number			
													Main	Accessories	Space Heater	
63			77													
71			78													
80			81	0.5-6mm ²												
90	M5x0.8		77		108.5	90	85	96						4	16	-
100			81													
112			107	2-10mm ²										6		
160	M6x1.0	110	144	5.2-25mm ²												
180			140													
200	M8x1.25	120	155	5.2-35mm ²												
225S/M			150	25.50mm ²												
250S/M			207		138.5	117	117	130								
280S/M			260	35-70mm ²												
315L	M10x1.5	200	260													
315S/M			260													
355M/L			305	85-120mm ²												
355A/B	-	290														



PACKAGING DIMENSIONS

W22 motors in frames 63 to 132 are packaged in cardboard boxes. The dimensions, weights and volumes are in the tables on the right.



Fig. Cardboard Box

Top mounted terminal box

Frame	External height (m)	External width (m)	External length (m)	Weight (kg)	Volume (m³)
63	0,26	0,21	0,30	0,2	0,02
71	0,26	0,21	0,30	0,2	0,02
80	0,27	0,26	0,36	0,7	0,02
90	0,32	0,27	0,43	0,9	0,04
100	0,33	0,27	0,46	1,4	0,04
112M	0,36	0,30	0,46	1,5	0,05
132	0,42	0,33	0,60	1,7	0,08

Note: Values to be added to the net motor weight

Side mounted terminal box

Frame	External height (m)	External width (m)	External length (m)	Weight (kg)	Volume (m³)
63	19,50	23,50	28,00	0,2	0,01
71	19,50	27,50	30,00	0,2	0,01
80	21,00	28,00	36,00	0,7	0,02
L80	23,50	31,50	39,80	0,8	0,03
90	23,50	31,50	39,80	0,8	0,03
100L	26,50	35,00	45,50	1,6	0,04
L100L	31,50	36,50	49,50	1,4	0,06
112M	31,00	38,00	45,50	1,7	0,05
132	35,00	48,00	59,50	2,1	0,10

Note: Values to be added to the net motor weight

For frames 160 to 355A/B. The motors are packaged in wooden crates. The dimensions, weights and volumes are in tables on the right.



Fig. Wooden Crate

Top mounted terminal box

Frame	External height (m)	External width (m)	External length (m)	Weight (kg)	Volume (m³)
160	40,2	51,2	74	9,8	0,15
180	45,2	57,2	82	13,4	0,21
200	49,2	63,2	88	14,6	0,27
225S/M	78	85	115	47,7	0,76
250S/M	90	85	125	52,2	0,96
280S/M	95	95	140	71,6	1,26
315S/M	113	110	175	88,4	2,18
315L	110,3	112,2	170	138	2,10
355M/L	120	119	172	146	2,46
355A/B	120	119	190	163	2,71

Note: Values to be added to the net motor weight

Top mounted terminal box

Frame	External height (m)	External width (m)	External length (m)	Weight (kg)	Volume (m³)
160	0,50	0,40	0,74	9,2	0,15
180	0,53	0,43	0,82	12,3	0,19
200	0,59	0,51	0,88	13,5	0,27
225S/M	0,90	0,85	1,15	51,9	0,88
250S/M	0,90	0,85	1,25	54,6	0,96
280S/M	1,13	0,85	1,40	67,9	1,34
315S/M	1,13	0,85	1,55	69,9	1,49
315L	1,20	0,90	1,70	111	1,84
355M/L	1,32	1,05	1,73	127	2,40
355A/B	1,32	1,05	1,90	141	2,63

Note: Values to be added to the net motor weight

TECHNICAL INFORMATION

Standard Connection Diagram For Auxiliary Equipment

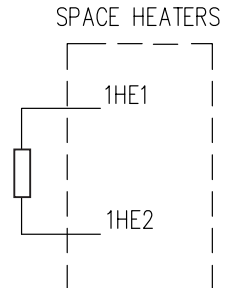
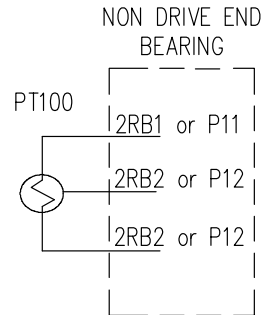
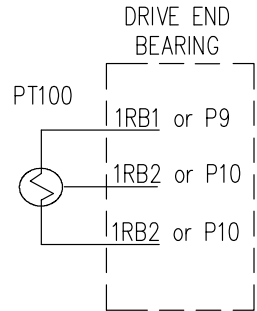
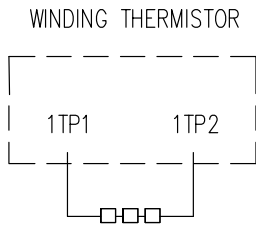
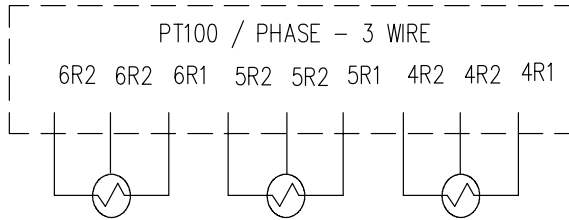
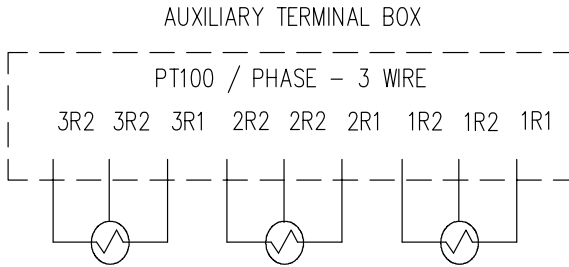

TECHNICAL INFORMATION

Typical WEG terminal Connections

3 Phase Motors

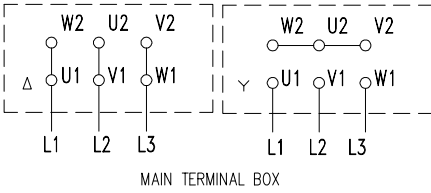

Multivoltage motors	Δ Delta	Y Star
Frame 63 -100	Δ 220 - 240V	Y 380 - 415V
Frame 63 - 132	Δ 525 - 550V	NA
Frame 112 - 355	Δ 380 - 415V	Y 660 - 690V
Frame 160 - 355	Δ 525 - 550V	Y 1000V

Single Phase Motors

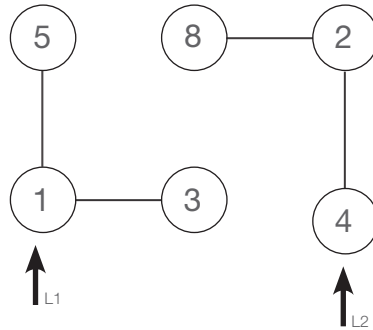

Join leads: 1, 3 and 5 together and supply incoming Line 1 to these three.

Join leads: 2, 4 and 8 together and supply incoming Line 2 to these three.

To reverse direction, interchange leads 5 and 8

BRAKING SYSTEM

The W22 brake motor allows two braking speeds: normal braking or fast braking. Brake power supply connection terminal 1 and 2

Normal braking

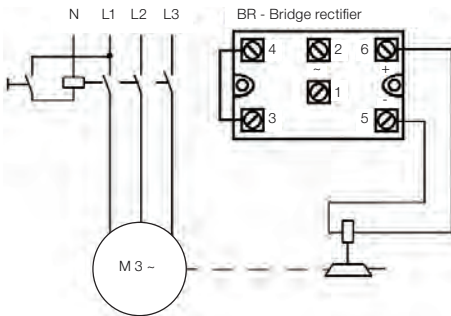

Connection Diagram of the bridge rectifier for normal braking

Fast braking

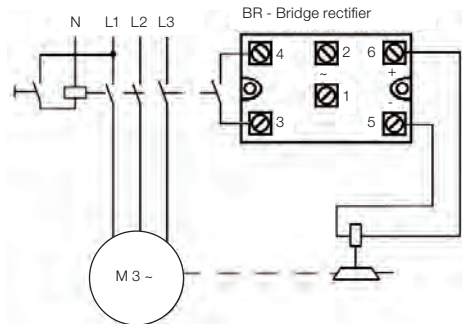

Connection Diagram of the bridge rectifier for fast braking

THERMAL CLASSES

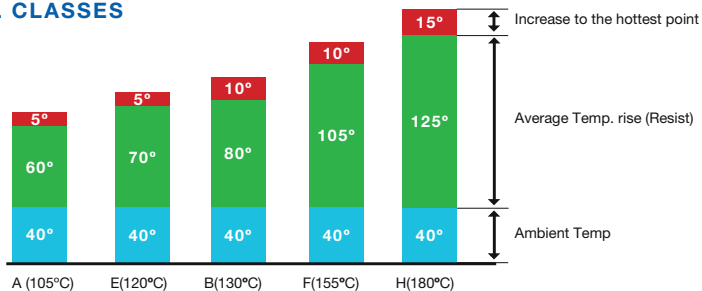

FORMULAE

$$\text{Demand Savings kW} = \frac{\text{Output}_{(\text{Old Motor})}(\text{kW})}{\left(\frac{\text{Efficiency}_{(\text{Old Motor})}(\%)}{100}\right)} - \frac{\text{Output}_{(\text{New Motor})}(\text{kW})}{\left(\frac{\text{Efficiency}_{(\text{New Motor})}(\%)}{100}\right)}$$

$$\text{Annual Energy Savings kWh} = \text{Demand Savings kW} \times \text{Operating days} \times \text{Operating hours}$$

$$\text{Annual Savings (R)} = \text{Annual Energy Savings kWh} \times \text{Energy Cost R/kWh}$$

$$\text{HP to kW: } \text{kW} = \text{HP} \times 0.7457$$

$$\text{Input Power (3 Phase): } P(\text{elec})\text{kW} = \frac{1.732 \times V(\text{line}) \times I(\text{line}) \times \text{COS}\theta}{1000}$$

$$\text{Output Power (3 Phase): } P(\text{mech})\text{kW} = \frac{P(\text{elec}) \times \eta(\text{efficiency})}{100}$$

$$\text{Efficiency: } \eta(\%) = \frac{P(\text{mech})\text{kW}}{P(\text{elec})\text{kW}} \times 100$$

$$\text{Current (3 Phase): } I(\text{rated})\text{A} = \frac{P(\text{elec})\text{kW} \times 1000}{1.732 \times V(\text{line}) \times \text{COS}\theta}$$

$$I(\text{rated})\text{A} = \frac{S(\text{kVA}) \times 1000}{1.732 \times V(\text{line})}$$

$$\text{Synchronous Speed: } \text{Synchronous}(r/\text{min}) = \frac{\text{Frequency}(\text{Hz}) \times 120}{\text{Poles}}$$

$$\text{Rated Slip: } \text{Slip}(\%) = \frac{\text{Synchronous}(r/\text{min}) - \text{Rated}(r/\text{min})}{\text{Synchronous}(r/\text{min})} \times 100$$

$$\text{Torque: } T(\text{rated})\text{Nm} = \frac{P(\text{mech})\text{kW} \times 9550}{\text{Speed}(r/\text{min})}$$

$$P(\text{mech}) = \frac{T(\text{rated})\text{Nm} \times \text{Speed}(r/\text{min})}{9550}$$

$$\text{Torque related to load} = \frac{60 \times P}{2 \times \pi \times n}$$



MOUNTING CONFIGURATIONS

Basic mountings	Other type of mounting				
	V5	V6	B6	B7	B8
B3 IM 1001	IM 1011	IM 1031	IM 1051	IM 1061	IM 1071
B35 IM 2001	V15 IM 2011	V36 IM 2031	* IM 2051	* IM 2061	* IM 2071
B34 IM 2101	V17 IM 2111	V37 IM 2131	* IM 2151	* IM 2161	* IM 2171
B5 IM 3001	V1 IM 3011	V3 IM 3031	B14 IM 3601	V18 IM 3611	V19 IM 3631

*Non-defined mountings by IEC 60034-7.

DERATING TABLE

Unless otherwise specified, the rated power outputs shown in the electrical data tables below refer to continuous duty operation S1, as per IEC 60034-1 and under the following conditions:

*With ambient temperature range -30 °C to +40 °C

*With altitudes up to 1000 metres above sea level

For operating temperatures and altitudes differing from those above, the factors indicated in table below must be used with the below formulas:

- * To calculate the available motor power, multiply the rated motor power by the correction factor.
- * To select the correct motor power, divide the required mechanical power by the correction factor.

T (°C)	Altitude (m)								
	1000	1500	2000	2500	3000	3500	4000	4500	5000
10	1.16	1.13	1.11	1.08	1.04	1.01	0.97	0.92	0.88
15	1.13	1.11	1.08	1.05	1.02	0.98	0.94	0.90	0.86
20	1.11	1.08	1.06	1.03	1.00	0.95	0.91	0.87	0.83
25	1.08	1.06	1.03	1.00	0.95	0.93	0.89	0.85	0.81
30	1.06	1.03	1.00	0.96	0.92	0.90	0.86	0.82	0.78
35	1.03	1.00	0.95	0.93	0.90	0.88	0.84	0.80	0.75
40	1.00	0.97	0.94	0.90	0.86	0.82	0.80	0.76	0.71
45	0.95	0.92	0.90	0.88	0.85	0.81	0.78	0.74	0.69
50	0.92	0.90	0.87	0.85	0.82	0.80	0.77	0.72	0.67
55	0.88	0.85	0.83	0.81	0.78	0.76	0.73	0.70	0.65
60	0.83	0.82	0.80	0.77	0.75	0.73	0.70	0.67	0.62
65	0.79	0.76	0.74	0.72	0.70	0.68	0.66	0.62	0.58
70	0.74	0.71	0.69	0.67	0.66	0.64	0.62	0.58	0.53
75	0.70	0.68	0.66	0.64	0.62	0.60	0.58	0.53	0.49
80	0.65	0.64	0.62	0.60	0.58	0.56	0.55	0.48	0.44

GLOBAL PRODUCT CERTIFICATIONS



GLOBAL

SANS
1804



SOUTH AFRICA



ARGENTINA



AUSTRALIA



BRAZIL



CHINA



COLUMBIA



EUROPE



FRANCE



GERMANY



INDIA



ITALY



KOREA



MEXICO



NIGERIA



NORTH AMERICA



RUSSIA



اللجنة السعودية للمواصفات والمقاييس والجودة
Saudi Standards, Metrology and Quality Org.



SAUDI ARABIA



PRODUCT SOLUTIONS

Contact Details

ELECTRICAL LOW VOLTAGE AND HIGH VOLTAGE RETICULATION

6 Laneshaw Street, Longlake Extension 4

Johannesburg

Tel: +27 (0) 11 723 6000

gensets@zestweg.com

CONVENTIONAL GENERATION

CAPE TOWN

13 Benbow Avenue

Epping Industrial 1

Tel: +27 (0) 21 507 7200

gensets@zestweg.com

JOHANNESBURG

6 Laneshaw Street, Longlake Extension 4

Tel: +27 (0) 11 723 6000

gensets@zestweg.com

INTEGRATED SOLUTIONS

6 Laneshaw Street, Longlake Extension 4

Johannesburg

Tel: +27 (0) 11 723 6000

info@zestweg.com

ELECTRIC MOTORS, DRIVES AND CONTROLS

JOHANNESBURG

LV Motors - lvmotors@zestweg.com

Drives - drivesales@zestweg.com

Switchgear - switchgearsales@zestweg.com

HV Motors & Proposals - zpq@zestweg.com

PACKAGED SWITCHGEAR AND AUTOMATION SOLUTIONS

18 Mount Ida Road, Robertsham

Tel: +27 (0) 11 434 8100

waa@zestweg.com

POWER DISTRIBUTION EQUIPMENT

WADEVILLE

3B Van Deventer Street

Wadeville, Germiston

Tel: +27 (0) 11 827 3458

wta@zestweg.com

HEIDELBERG

11 Marconi Street, Heidelberg

Tel: +27 (0) 16 349 2683/4/5

wta@zestweg.com

SECTOR SPECIALISTS

Contact Details

MINING & INDUSTRIAL SECTOR

JOE MARTINS

JMartins@zestweg.com

Tel: +27 (0) 11 723 6173

PUBLIC SECTOR

DILLON GOVENDER

DGovender@energy.zestweg.com

Tel: +27 (0) 11 723 6250

OIL & GAS SECTOR

LUKAS BARNARD

LBarnard@zestweg.com

Tel: +27 (0) 11 723 6012

MINING AND INDUSTRIAL SECTOR

LUVESHEN NAIDOO

LNaidoo@zestweg.com

Tel: +27 (0) 11 723 6075

NATIONAL DISTRIBUTOR

Contact Details

DURBAN

SUPER ARMATURE WINDERS AFRICA

The Crest Business Park, Unit 1,
Dawood Cl,
Dolphin Coast, 4420
Tel: +27 (0) 81 479 4880

GEORGE

SUPER ARMATURE WINDERS AFRICA

13B Pioneer St,
Pacaltsdorp,
George, 6534
Tel: +27 (0) 44 878 0349

GEORGE

BEARING & ALLIED

Cnr Albert and Foundry Street
George Industria
George, 6536
Tel: +27 (0) 44 874 1318

JOHANNESBURG

SUPER ARMATURE WINDERS AFRICA

Growthpoint Industrial Estate, Block C2
Bell St, Meadowdale,
Germiston, 1614
Tel: +27 (0) 11 392 2217

KIMBERLEY

LECFLO CC

P.O. Box 1408 Kimberley, 8301
2 Faraday Street
Ashburmham
Tel: +27 (0) 53 841 0378

SUPER ARMATURE WINDING AFRICA

P.O. Box 1141 Kimberley 8301
1 Turner Road, Turner Road Industrial Area
Kimberley, 8301
Tel: +27 (0) 53 832 3681

LICHTENBURG

LICHTENBURG TECHNICAL SERVICES CC

P.O. Box 2048 Lichtenburg 2740
31 Melville Street
Lichtenburg
Tel: +27 (0) 18 632 1531

NELSPRUIT

SIZONKE TRADING (PTY) LTD

P.O. Box 1577 Nelspruit, 1200
12 Suikerriet Street
Nebo Park, Extension 12
Tel: +27 (0) 13 755 3188

NEWCASTLE

FORCE ELECTRICAL CC

P.O. Box 16009 Newcastle 2940
7 Edison Street, Newcastle
Tel: +27 (0) 34 375 7150

ROBERTSON

JA IMMELMAN

9 Adreley Street
Robertson, 6705
Tel: +27 23 626 6910

TZANEEN

TZANEEN REWINDERS

Kew Street
Tzaneen 0850
Tel: +27 (0) 15 307 6570

VEREENIGING

NOBLE MOTOR AND CONTROL (PTY) LTD

P.O. Box 1490
Vereeniging 1930
Cnr Harrington and Houtkop Street
Duncanville
Tel: +27 (0) 16 427 4060

VREDENDAL

VREDENDAL IRRIGATION

39 Church Street
Vredendal, 8160
Tel: +27 (0) 27 213 1600

POTCHEFSTROOM

VESCOTECH

P.O. Box 6283
Baillie Park, Potchefstroom 2526
29 Ross Street, Potchefstroom
Tel: +27 (0) 18 297 7193

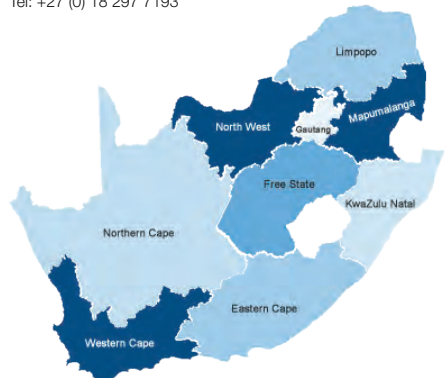

ZEST WEG AFRICAN NETWORK

Contact Details

In addition to its own network of distributors throughout South Africa
ZEST WEG is represented in the following African countries.

AFRICA BUSINESS DEVELOPMENT

6 Laneshaw Street, Longlake
Ext 4, Johannesburg
Tel: +27 (0) 11 723 6000
africa@zestweg.com

ZEST WEG GHANA

15 Third Close Street,
Airport Residential Area,
Accra, Ghana
Tel: +233 30 27 664 90
Fax: +233 30 27 664 93
Cell: +233 540 898 466
ghana@zestweg.com

ANGOLA

NOVA SOTECMA

Luanda
Tel: +244 932 405 507
Tel: +244 912 501 739
ns@novasotecma.com

Lobito

Tel: +244 945 352 526
lobito@novasotecma.com

Viana

Tel: +244 941 454 223
viana@novasotecma.com

BOTSWANA

SEAPRO (PTY) LTD

Gaborone
Tel: +267 71 32 22 01
grant@seaproafrica.com

BURKINA FASO

GEMCO SARL

Ouagadougou
Tel: +226 25 36 36 92
Tel: +226 79 15 29 01
info@gemco.africa
afarhat@gemco.africa

CAMEROON

EQUINOX POWER SOLUTIONS

Tel: + 237 69 92 41 231
Tel: +27 60 385 4625
sales@eps4africa.com

COTE D'IVOIRE

RMS SARL

Abidjan
Tel: +225 07 07 46 13
Tel: +225 20 38 66 35
rms@aviso.ci

DEMOCRATIC REPUBLIC OF THE CONGO

PANACO SARL

Lubumbashi and Kolwezi
Tel: +243 812 404 444
Tel: +243 810 025 720
jbcasokota@panaco-rdc.com
info@panaco-rdc.com

KENYA

REPELECTRIC (K) LTD

Tel: +254 733 612 433
Tel: + 254 734 600 074
jackw@repelectric.net

MALI

SGSIM CORPORATION SARL AGENT

Bamako
Tel: +223 79 02 07 43
sales@sgsimcorporation.com

MADAGASCAR

ARIS TRADING

Antananarivo
Tel: +261 20 22 290 24
jamesdavidson@aris.mg
jean.peuteuil@aris.mg

MALAWI

CHALLENGE POWER TRANSMISSION LTD

Thyolo
Tel: +265 994 665 376
admin@challengemalawi.com

MAURITANIA

INTEQ MAURITANIA

Nouakchott
Tel: + 222 46 41 21 84
Tel: +222 46 85 27 37
dia.amadou@international-equipement.com

MAURITIUS

EMINEO LIMITED

Vacoas-Phoenix
Tel: +230 698 8200
rchow@emineo.mu
ahulkooree@emineo.mu

MOZAMBIQUE

TECNEL

Matola
Tel: +258 21 751 032
info@tecnel.co.mz

NAMIBIA

SWAKOP ELECTRICAL SUPPLIES CC

Swakopmund
Tel: +264 64 462 106
info@ses.com.na

NIGERIA

BEAMCO

Lagos
Tel: +234 803 22 23 999
Tel: +961 13 07 000
hkaidbey@BeamIntl.com

REPUBLIC OF CONGO

TPI CONGO

Pointe-Noire
Tel: +242 05 374 5626
dc-pnr@tpicongo.com

REPUBLIC OF GABON

CODALEC

Libreville
Tel: +241 05 33 53 53
tham@codalecgabon.com

SENEGAL

TOP STRUCTURES SARL (AGENT)

Dakar
Tel: +221 777 320 232
birame.top@topstructures.dz

TANZANIA

MAGARE COMPANY LIMITED

Mwanza and Dar es Salaam
Tel: +255 76 538 7751
Tel: +255 75 421 3418
info@magare.co.tz
md@magare.co.tz
gmaganjala@magare.co.tz

UGANDA

BEAUTIFUL ENGINEERING

Kampala
Tel: +256 78 28 43339
gusterbee@gmail.com

ZAMBIA

INTEGRATED ENGINEERING SERVICES LIMITED

Tel: +260 96 6904516
kansambaandrew@yahoo.com

ZIMBABWE

BLUETEK GENERATORS

Harare
Tel: +263 242747749
admin@bluetek.co.zw

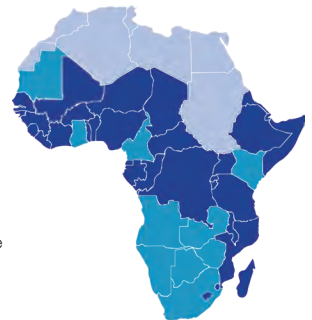

ZEST WEG ELECTRIC (PTY) LTD



ZEST
WEG Group

www.zestweg.com | 0861 00 9378

Driving efficiency and sustainability

