

Rack 2 / Rack 3

CFW-11M / RMW11

Installation Guide Guía de Instalación Guia de Instalação

English / Español / Português

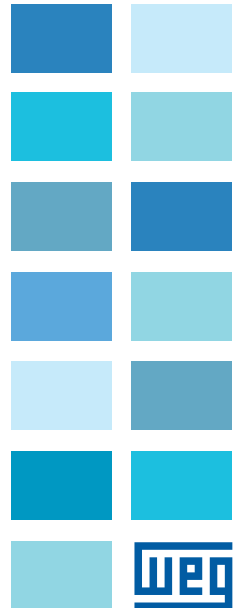

Summary

1. General Information.....	5
2. Mechanical Dimensions.....	5
3. Bill of Materials.....	6
4. Installation.....	7

Índice

1. Informaciones Generales.....	12
2. Dimensiones Mecánicas.....	12
3. Listado de Piezas.....	13
4. Instalación.....	14

Índice

1. Informações Gerais.....	19
2. Dimensões Mecânicas.....	19
3. Lista de Peças.....	20
4. Instalação.....	21

1. GENERAL INFORMATION

This guide orients the installation of the Rack 2 and Rack 3 mechanical accessories, used to facilitate the installation of the modular rectifiers and inverters (book format) RMW11 and CFW-11M in cabinets.

The Rack 2 accessory allows the installation of 1 or 2 modules side by side in 600 mm (23.6 in) wide cabinets.

The Rack 3 accessory allows the installation of 1, 2 or 3 modules side by side in 1000 mm (39.4 in) wide cabinets.

2. MECHANICAL DIMENSIONS

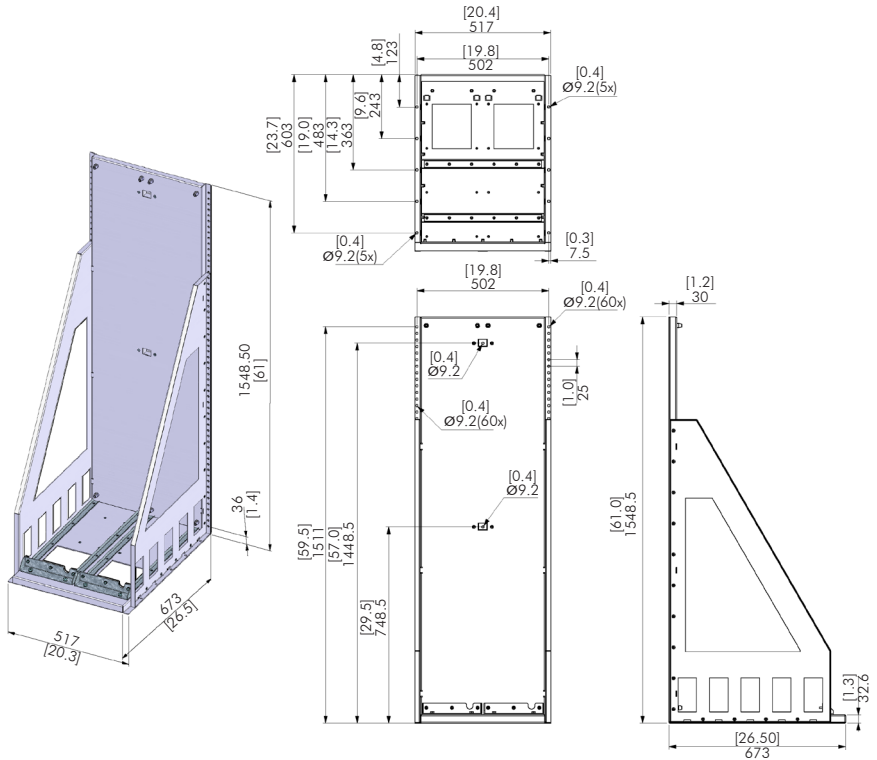

Figure 1 - Rack 2 Dimensions in mm [in]

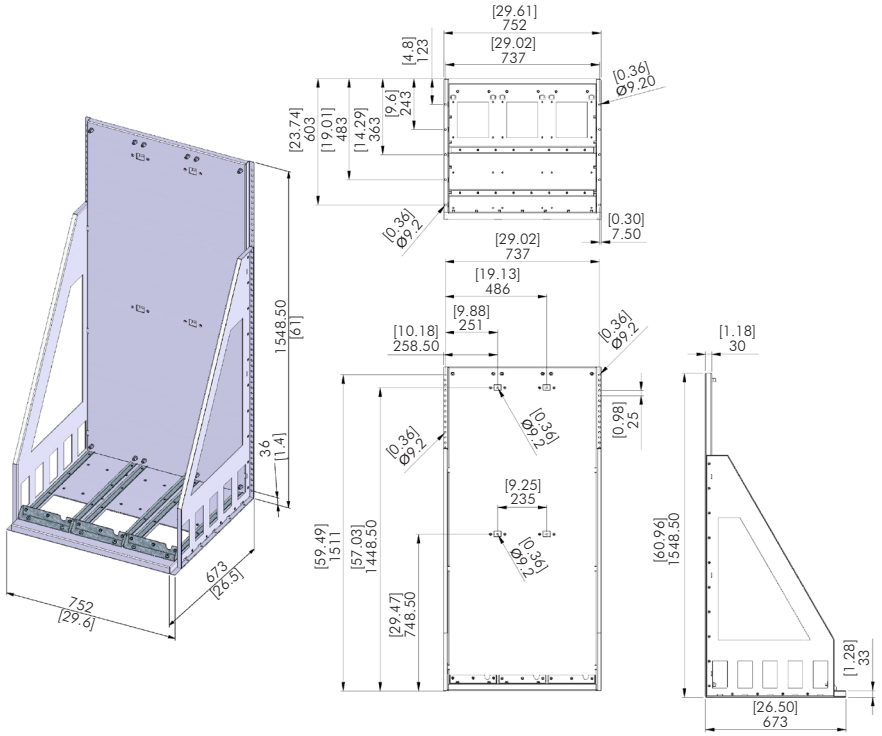

Figure 2 - Rack 3 Dimensions in mm [in]

3. BILL OF MATERIALS

Table 1 - Rack 2 bill of materials

RACK 2			
Position	Material	Description	Quantity
1	10883330	Drive front bracket	2
2	10883645	Bottom base brace	2
3	10881923	Left side cover	1
4	10882019	Right side cover	1
5	10883499	Rear fixing bracket	2
6	10882677	Rear cover	1
7	10883439	Support guide low	4
8	10884139	Base rack fixed	1
9	10888136	Internally threaded guide pin	8
10	10051025	Hex/Phillips with captive washer M8 x 20 mm (0.8 in) screw	12
11	10254506	Slotted/Phillips flat head M5 x 0.8 x 14 mm (0.5 in) screw	16
12	10050963	Slotted/Phillips flat head M6 x 1.0 x 16 mm (0.6 in) screw	49
13	10412546	Hex/Phillips with captive washer M6 x 16 mm (0.6 in) screw	6

Table 2 - Rack 3 bill of materials

RACK 3			
Position	Material	Description	Quantity
1	10883330	Drive front bracket	3
2	10884898	Bottom base brace	2
3	10881923	Left side cover	1
4	10882019	Right side cover	1
5	10883499	Rear fixing bracket	4
6	10884510	Rear cover	1
7	10883439	Support guide low	6
8	10884757	Base rack fixed	1
9	10888136	Internally threaded guide pin	12
10	10051025	Hex/Phillips with captive washer M8 x 20 mm (0.8 in) screw	18
11	10254506	Slotted/Phillips flat head M5 x 0.8 x 14 mm (0.5 in) screw	24
12	10050963	Slotted/Phillips flat head M6 x 1.0 x 16 mm (0.6 in) screw	53
13	10412546	Hex/Phillips with captive washer M6 x 16 mm (0.6 in) screw	9



NOTES!

- M5 screws recommended tightening torque: 5.0 Nm ± 15 %.
- M6 screws recommended tightening torque: 8.5 Nm ± 15 %.
- M8 screws recommended tightening torque: 19.0 Nm ± 15 %.

4. INSTALLATION

- Rack assembling according to figures 3 and 4.
- Installation of the rack inside the cabinet according to figures 7 and 8.

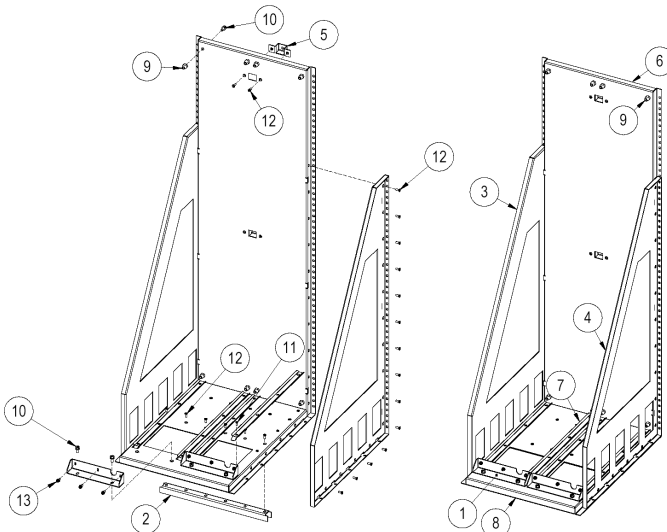

Figure 3 - Assembling of the rack for 2 power modules

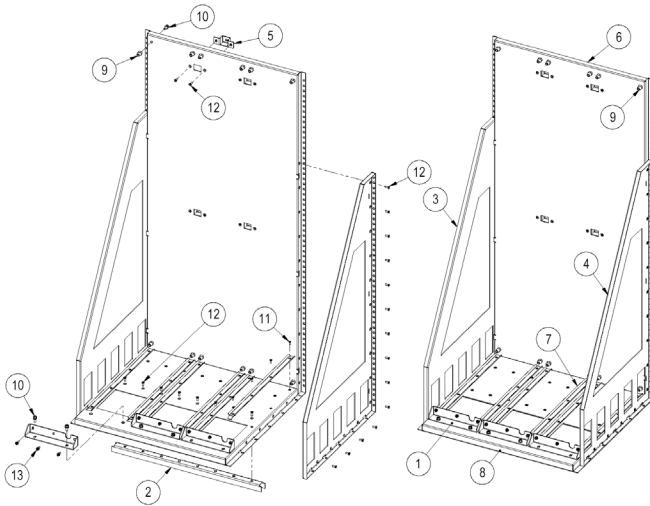

Figure 4 - Assembling of the rack for 3 power modules

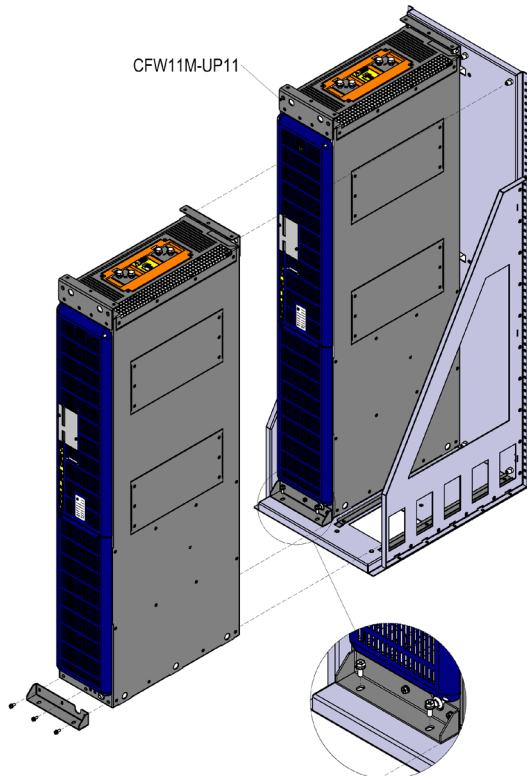

Figure 5 - Insertion of the power modules in the Rack 2

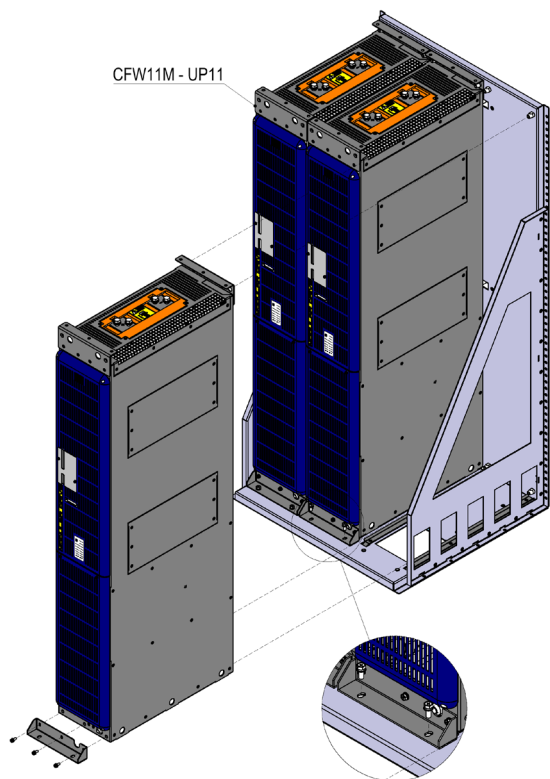

Figure 6 - Insertion of the power modules in the Rack 3

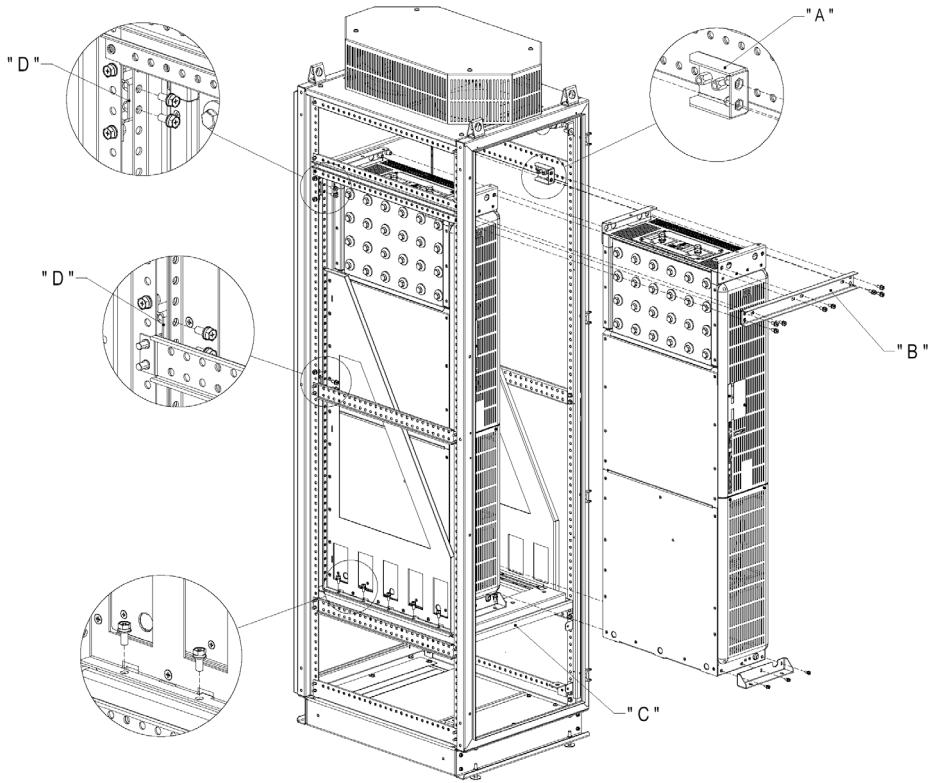

Figure 7 - Details for mounting the Rack 2 in a 600 mm (23.6 in) wide cabinet

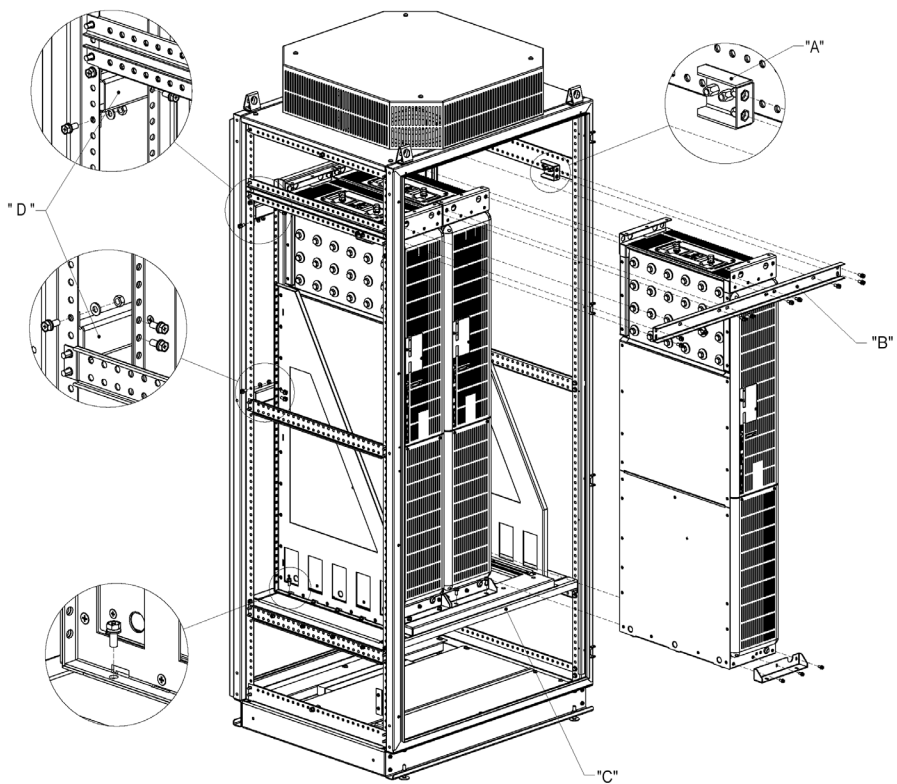

Figure 8 - Details for mounting the Rack 3 in a 1000 mm (39.4 in) wide cabinet

1. INFORMACIONES GENERALES

Este guía orienta la instalación de los accesorios mecánicos Rack 2 y Rack 3, usados para facilitar la fijación en armarios (tableros) de los rectificadores y de los inversores en formato modular (formato "book"), líneas RMW11 y CFW-11M.

El accesorio Rack 2 permite la fijación de 1 o 2 módulos lado a lado, en armarios (tableros) con 600 mm de ancho. El accesorio Rack 3 permite la fijación de 1, 2 o 3 módulos lado a lado, en armarios (tableros) con 1000 mm de ancho.

2. DIMENSIONES MECÁNICAS



Figura 1 - Dimensiones del Rack 2 en mm [pulgada]



Figura 2 - Dimensiones del Rack 3 en mm [pulgada]

3. LISTADO DE PIEZAS

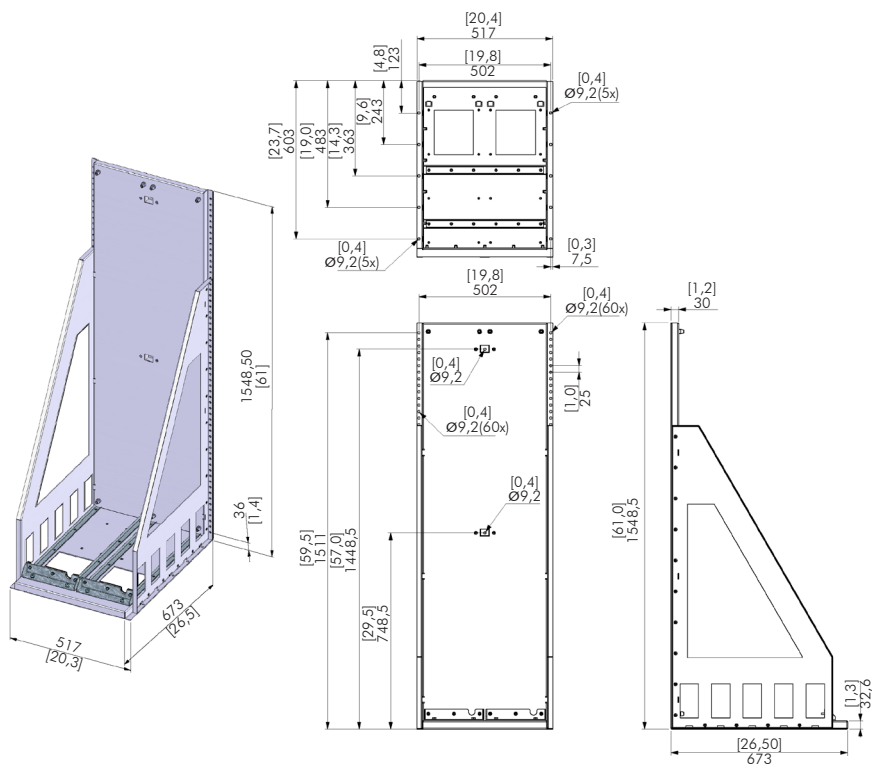
Tabla 1 - Listado de piezas del Rack 2

RACK 2				
Posición	Material	Descripción	Cantidad	
1	10883330	Soporte frontal drive	2	
2	10883645	Refuerza base inferior	2	
3	10881923	Tapa lateral izquierdo	1	
4	10882019	Tapa lateral derecho	1	
5	10883499	Soporte de fijación posterior	2	
6	10882677	Tapa posterior	1	
7	10883439	Soporte guía inferior	4	
8	10884139	Base rack fijo	1	
9	10888136	Pino guía rosca interna	8	
10	10051025	Tornillo con arandela sextavado phillips M8 x 20 mm	12	
11	10254506	Tornillo escariado tipo cruz M5 x 0,8 x 14 mm	16	
12	10050963	Tornillo escariado tipo cruz M6 x 1,0 x 16 mm	49	
13	10412546	Tornillo con arandela sextavado phillips M6 x 16 mm	6	

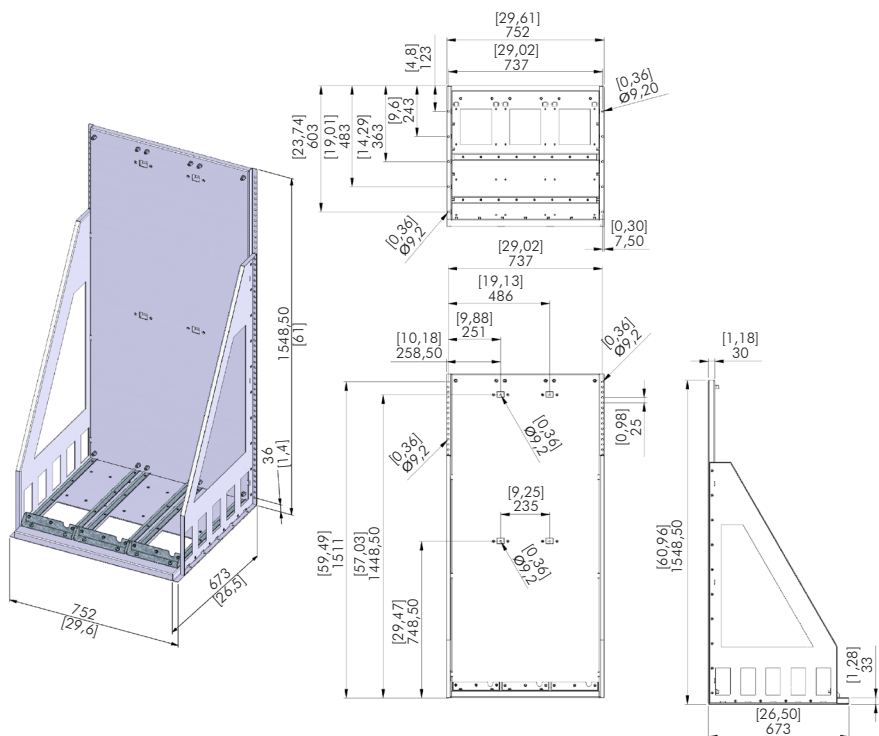
Tabla 2 - Listado de piezas del Rack 3

RACK 3			
Posición	Material	Denominación	Cantidad
1	10883330	Soporte frontal drive	3
2	10884898	Refuerzo base inferior	2
3	10881923	Tapa lateral izquierdo	1
4	10882019	Tapa lateral derecho	1
5	10883499	Soporte de fijación posterior	4
6	10884510	Tapa posterior	1
7	10883439	Soporte guía inferior	6
8	10884757	Base rack fijo	1
9	10888136	Pino guía rosca interna	12
10	10051025	Tornillo con arandela sextavado phillips M8 x 20 mm	18
11	10254506	Tornillo escariado tipo cruz M5 x 0,8 x 14 mm	24
12	10050963	Tornillo escariado tipo cruz M6 x 1,0 x 16 mm	53
13	10412546	Tornillo con arandela sextavado phillips M6 x 16 mm	9



¡NOTAS!

- Par (Torque) de aprieto recomendado para los tornillos M5: 5,0 N.m ± 15 %.
- Par (Torque) de aprieto recomendado para los tornillos M6: 8,5 N.m ± 15 %.
- Par (Torque) de aprieto recomendado para los tornillos M8: 19,0 N.m ± 15 %.

4. INSTALACIÓN

- El montaje del RACK conforme las figuras 3 y 4.
- Instalación del RACK en el armario (tablero) conforme las figuras 7 y 8.



Figura 3 - Montaje del rack para 2 módulos de potencia



Figura 4 - Montaje del rack para 3 módulos de potencia

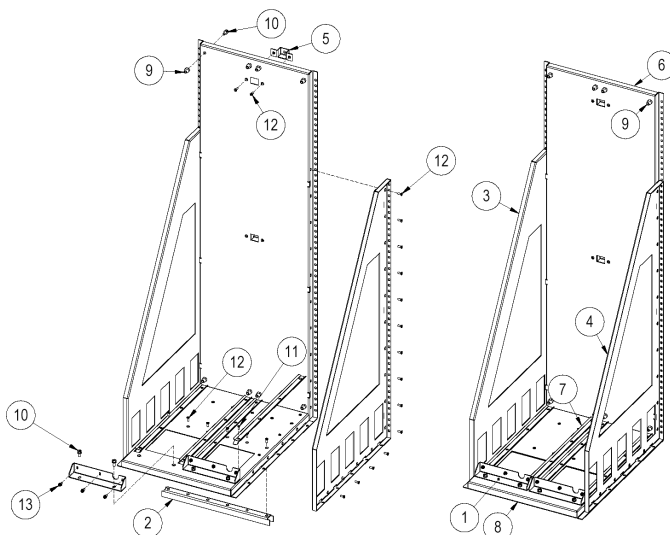

Figura 5 - Inserción de los módulos de potencia en el Rack 2

CFW11M - UP11

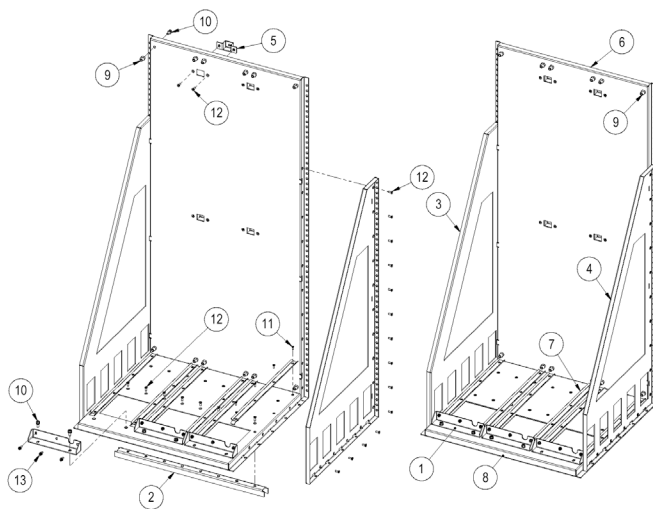

Figura 6 - Inserción de los módulos de potencia en el Rack 3

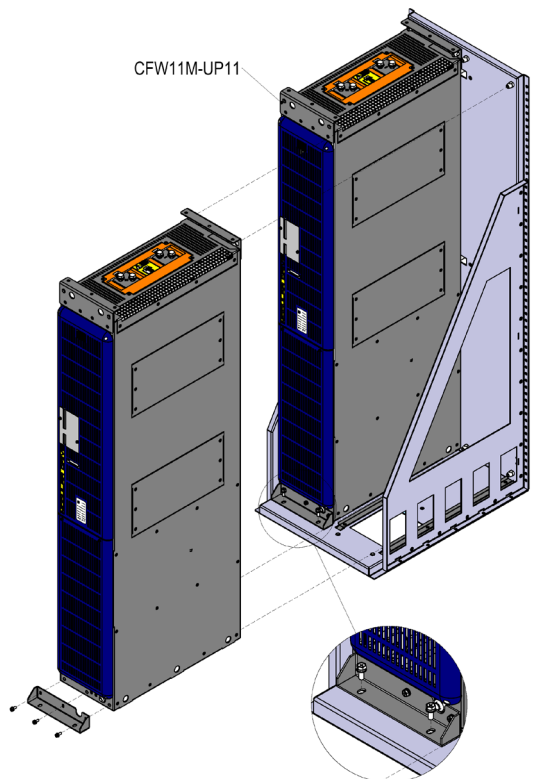

Figura 7 - Detalles de montaje del Rack 2 en armario (tablero) con 600 mm de ancho

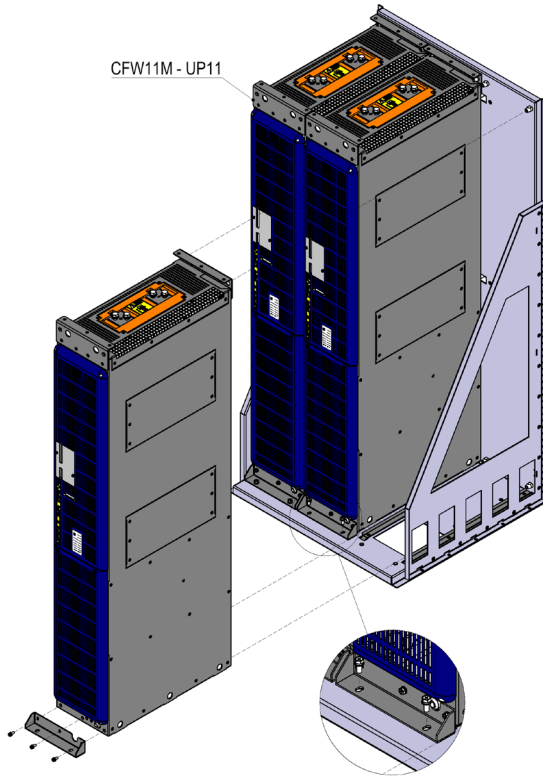

Figura 8 - Detalles de montaje del Rack 3 en armario (tablero) con 1000 mm de ancho

1. INFORMAÇÕES GERAIS

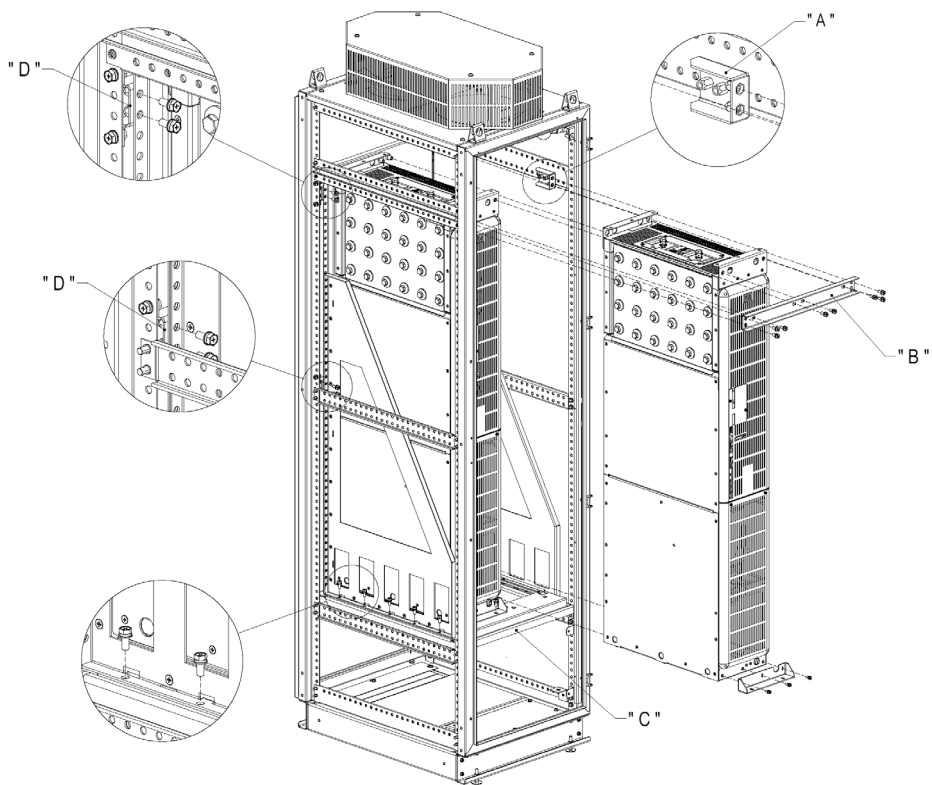
Este guia orienta a fixação dos acessórios mecânicos Rack 2 e Rack 3, usados para facilitar a fixação em painel dos retificadores e inversores em formato modular (formato “book”), linhas RMW11 e CFW-11M.

O acessório Rack 2 permite a fixação de 1 ou 2 módulos lado a lado, em painéis com 600 mm de largura.

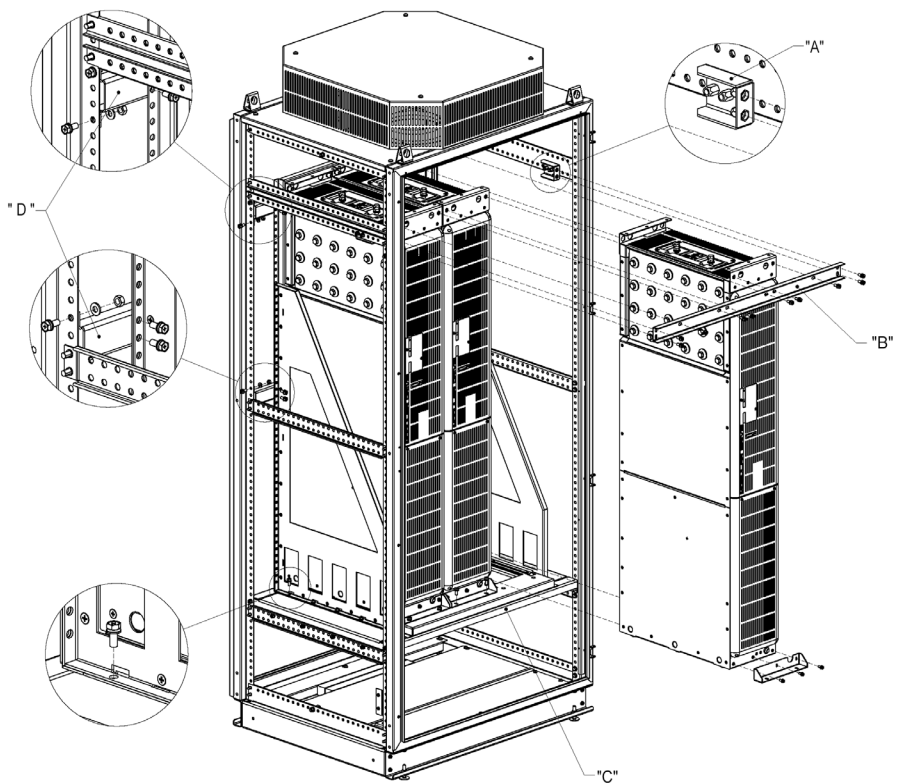
O acessório Rack 3 permite a fixação de 1, 2 ou 3 módulos lado a lado, em painéis com 1000 mm de largura.

2. DIMENSÕES MECÂNICAS



Figura 1 - Dimensões do Rack 2 em mm [pol]



Figura 2 - Dimensões do Rack 3 em mm [pol]

3. LISTA DE PEÇAS

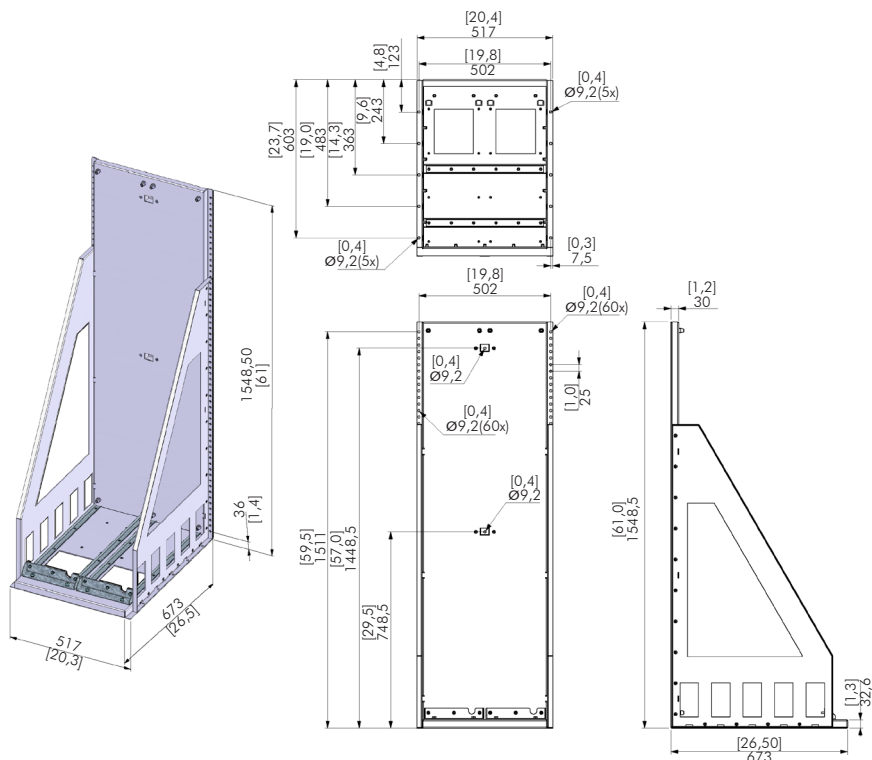
Tabela 1 - Lista de peças do Rack 2

RACK 2			
Posição	Material	Descrição	Quantidade
1	10883330	Suporte frontal drive	2
2	10883645	Reforço base inferior	2
3	10881923	Fechamento lateral esquerdo	1
4	10882019	Fechamento lateral direito	1
5	10883499	Suporte de fixação posterior	2
6	10882677	Fechamento posterior	1
7	10883439	Suporte guia inferior	4
8	10884139	Base rack fixo	1
9	10888136	Pino guia rosca interna	8
10	10051025	Parafuso arruelado sextavado phillips M8 x 20 mm	12
11	10254506	Parafuso escariado fenda cruz M5 x 0,8 x 14 mm	16
12	10050963	Parafuso escariado fenda cruz M6 x 1,0 x 16 mm	49
13	10412546	Parafuso arruelado sextavado phillips M6 x 16 mm	6

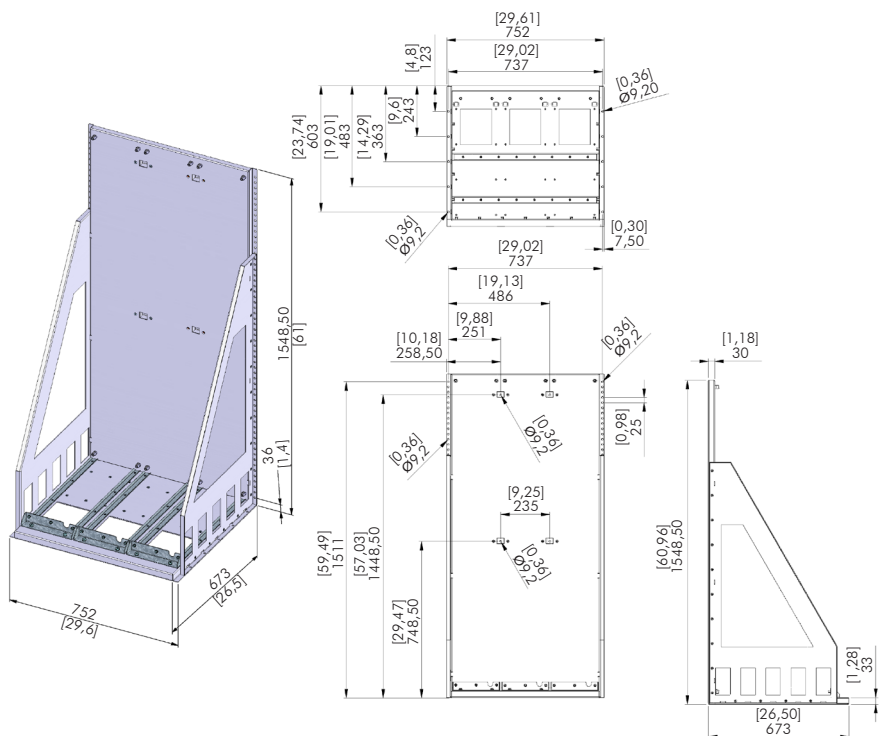
Tabela 2 - Lista de peças do Rack 3

RACK 3			
Posição	Material	Denominação	Quantidade
1	10883330	Suporte frontal drive	3
2	10884898	Reforço base inferior	2
3	10881923	Fechamento lateral esquerdo	1
4	10882019	Fechamento lateral direito	1
5	10883499	Suporte de fixação posterior	4
6	10884510	Fechamento posterior	1
7	10883439	Suporte guia inferior	6
8	10884757	Base rack fixo	1
9	10888136	Pino guia rosca interna	12
10	10051025	Parafuso arruelado sextavado phillips M8 x 20 mm	18
11	10254506	Parafuso escariado fenda cruz M5 x 0,8 x 14 mm	24
12	10050963	Parafuso escariado fenda cruz M6 x 1,0 x 16 mm	53
13	10412546	Parafuso arruelado sextavado phillips M6 x 16 mm	9



NOTAS!

- Torque de aperto recomendado para os parafusos M5: 5,0 N.m ± 15 %.
- Torque de aperto recomendado para os parafusos M6: 8,5 N.m ± 15 %.
- Torque de aperto recomendado para os parafusos M8: 19,0 N.m ± 15 %.

4. INSTALAÇÃO

- Montagem do RACK conforme figuras 3 e 4.
- Instalação do RACK no painel conforme figuras 7 e 8.



Figura 3 - Montagem do rack para 2 módulos de potência



Figura 4 - Montagem do rack para 3 módulos de potência

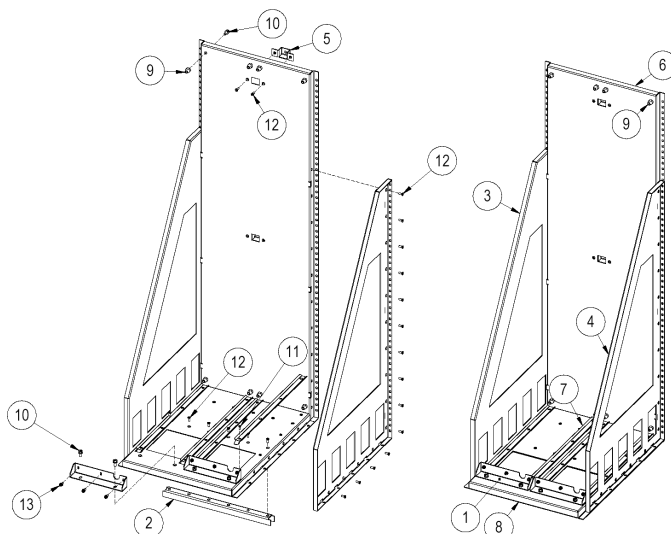

Figura 5 - Inserção dos módulos de potência no Rack 2

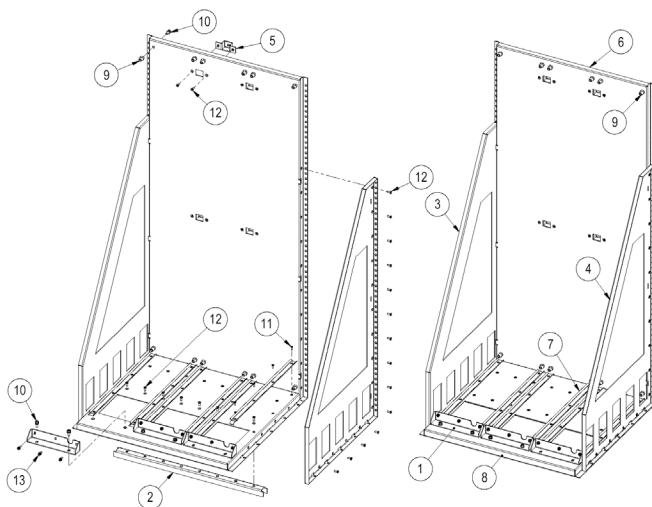

Figura 6 - Inserção dos módulos de potência no Rack 3

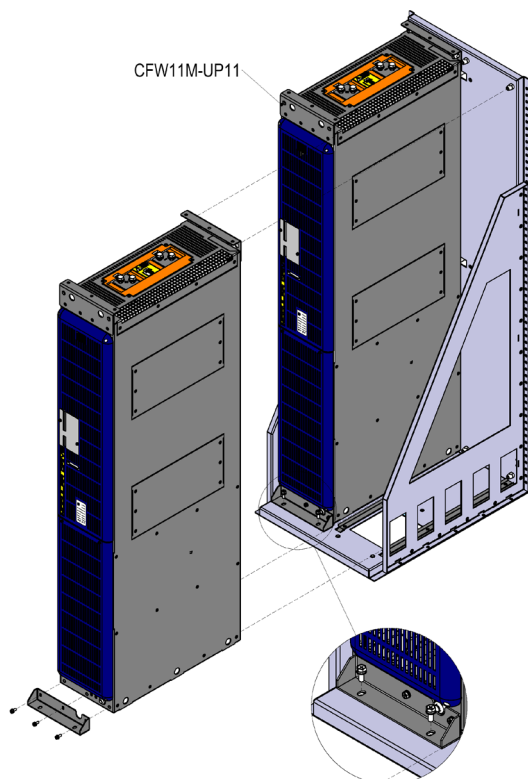

Figura 7 - Detalhes de montagem do Rack 2 em painel com 600 mm de largura

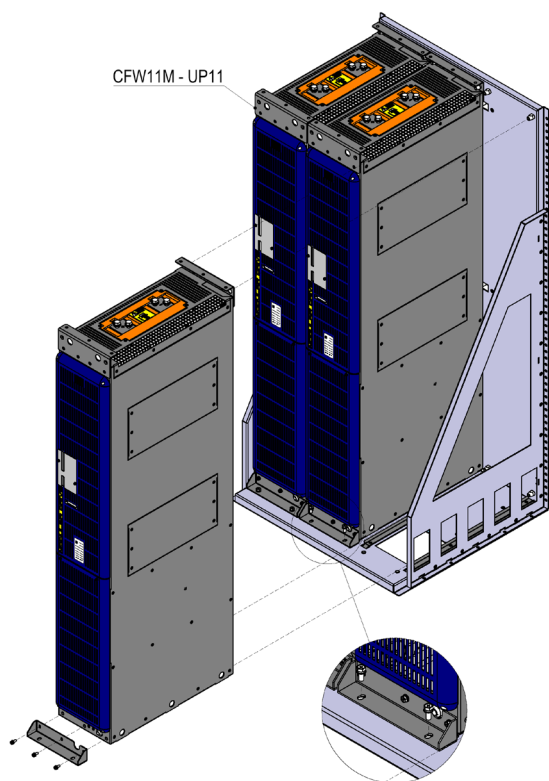

Figura 8 - Detalhes de montagem do Rack 3 em painel com 1000 mm de largura

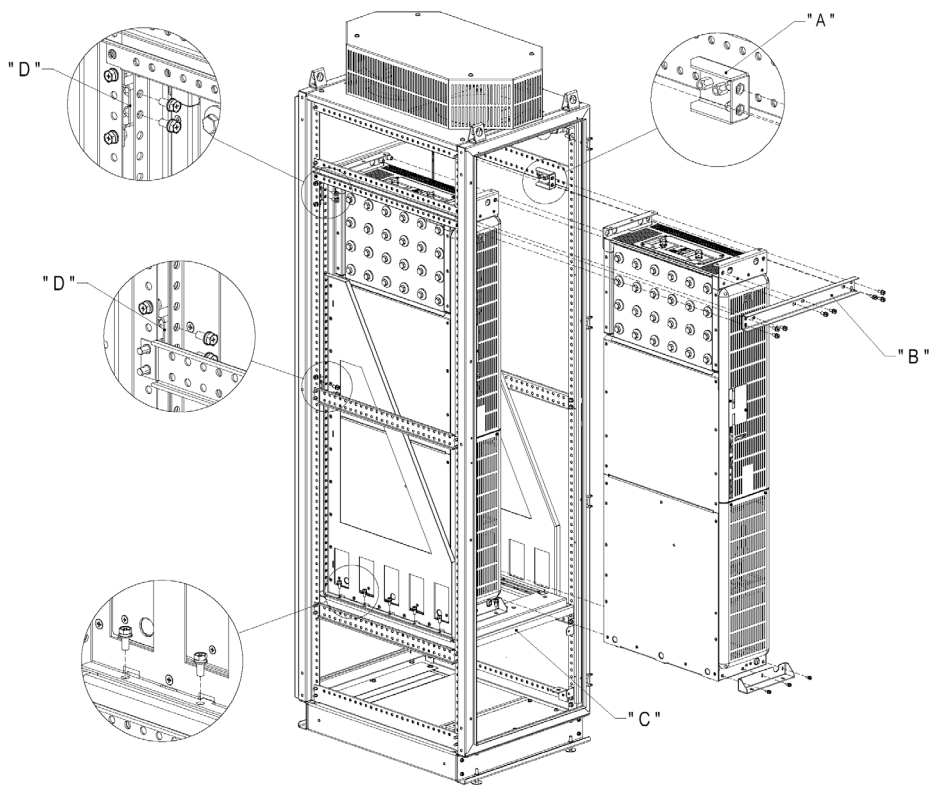

WEG Automação S.A.
Jaraguá do Sul - SC
Phone 55 (47) 3276-4000 - Fax 55 (47) 3276-4020
São Paulo - SP
Phone 55 (11) 5053-2300 - Fax 55 (11) 5052-4212
automacao@weg.net
www.weg.net

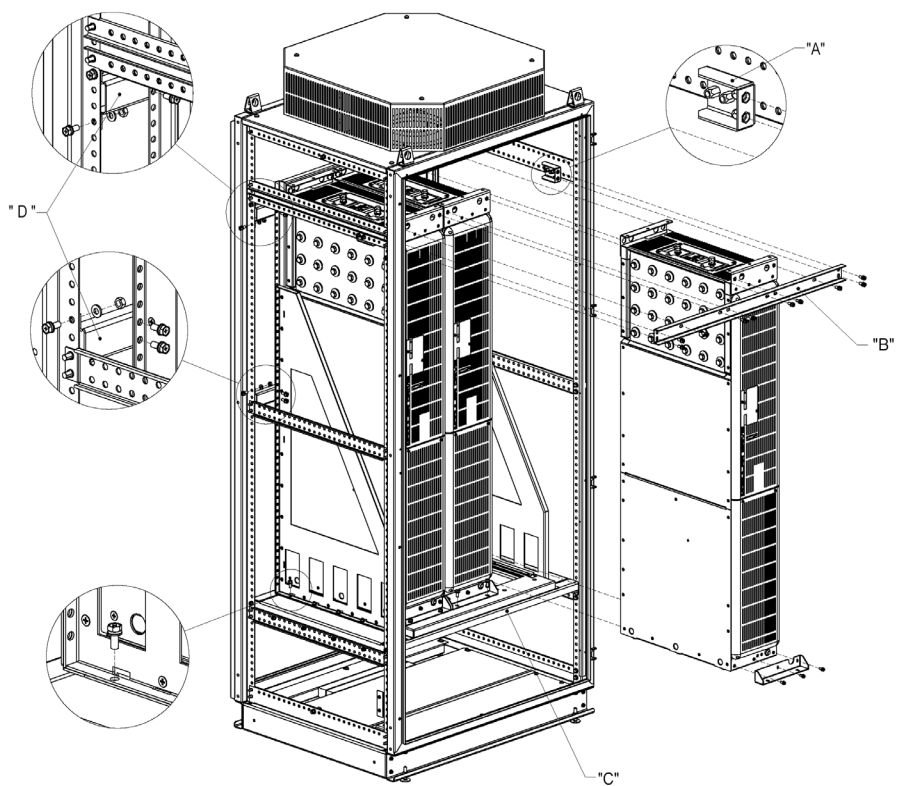

11168954

Document: 10000530330 / 00