

English / Español / Português

IP21 Accessory Guide / Guía de Accesorios IP21 / Guia do Acessório IP21

CFW11 KIT IP21 E-F-G



14347623

Document: 10005594698 / 01

1 GENERAL INFORMATION 1 INFORMACIONES GENERALES 1 INFORMAÇÕES GERAIS

For fixing the kit, position the metal cover on the top surface of the inverter and secure it with the two screws.

Para fijar el kit, coloque la cubierta metálica en la superficie superior del inversor y asegúrela con los dos tornillos.

Para fixar o kit, posicionar a tampa metálica na superfície superior do inversor e fixá-la com os dois parafusos.



Figure 1.1: Installation of the KIP21 E-F-G kit
Figura 1.1: Instalación del kit KIP21 E-F-G
Figura 1.1: Instalação do kit KIP21 E-F-G

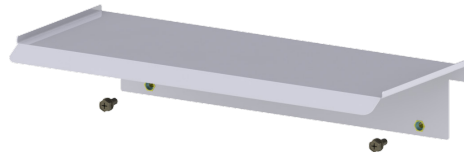

Figure 1.2: Exploded KIP21 E-F-G kit mounting
Figura 1.2: Despiece de montaje kit KIP21 E-F-G
Figura 1.2: Montagem explodida kit KIP21 E-F-G

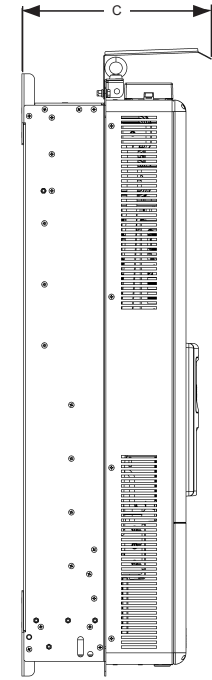
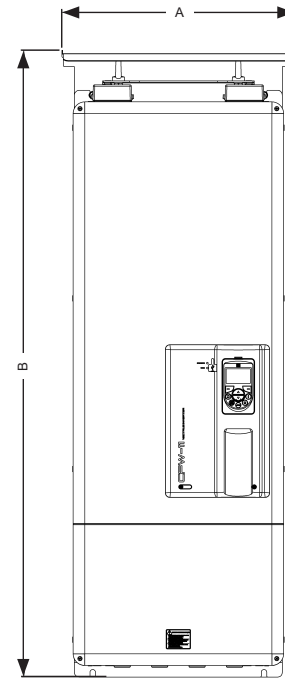

Table 1.1: Inverter dimensions with KIP21 E-F-G kit
Tabla 1.1: Dimensiones del convertidor con kit KIP21 E-F-G
Tabela 1.1: Dimensões do inversor com o kit KIP21 E-F-G

Model / Modelo	A mm [in]	B mm [in]	C mm [in]
Frame Size E / Tamaño E / Mecânica E	381[15.00]	733.6 [28.88]	385[15.16]
Frame Size F / Tamaño F / Mecânica F	476 [18.74]	1286 [50.63]	386 [15.20]
Frame Size G / Tamaño G / Mecânica G	581 [22.87]	1322 [52.05]	452 [17.80]