

## SHUNT COIL

Applicable to ACW125 ACW250 ACW400 ACW800

Please read and follow this instruction before using Shunt Trip or Under Voltage Trip.  
 -This product must be installed and serviced by electrical qualified electrical person.  
 -Please install this product only to the applicable frame types.

### SAFETY PRECAUTIONS

Before installation, wiring, operation, maintenance and inspection of the device, be sure to read safety precautions carefully and follow the message to ensure proper operations.

- ⚠ DANGER It may result in death or serious injury.
- ⚠ CAUTION It may result in injury or physical damage.

⚠ DANGER

1. Turn off the upstream circuit breaker before installation to prevent electric shocks and burns due to short circuit.

⚠ CAUTION

- Prior to fitting these devices confirm if the circuit breaker is an applicable type.
- If there is excessive pressure to the HOOK, it can be damaged.
- Don't operate MCCB unless Under Voltage Trip is energized.

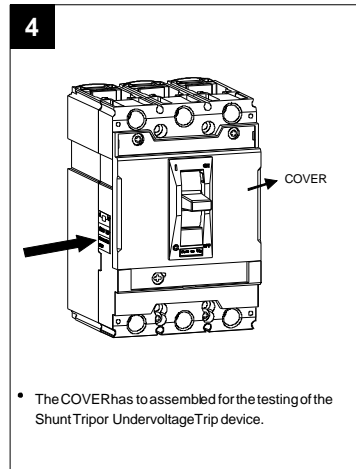
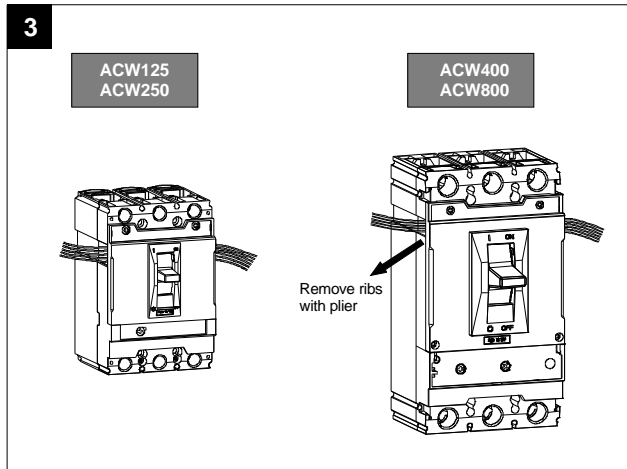
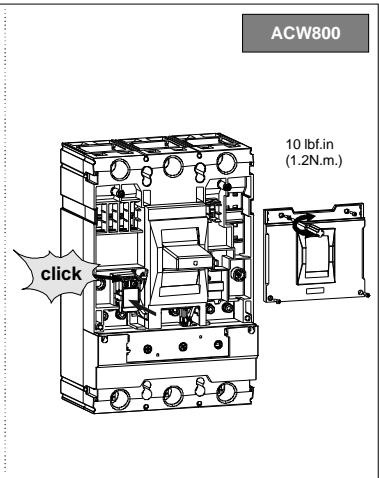
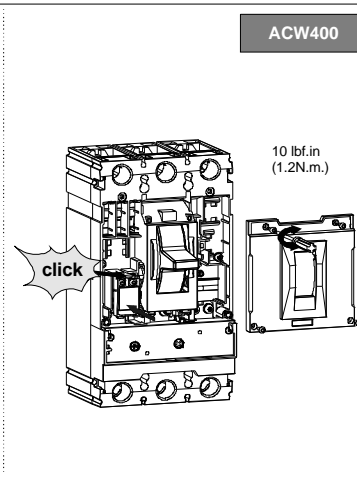
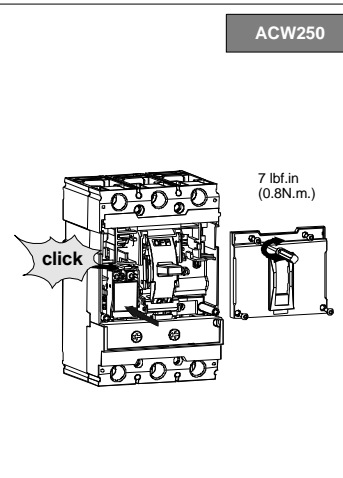
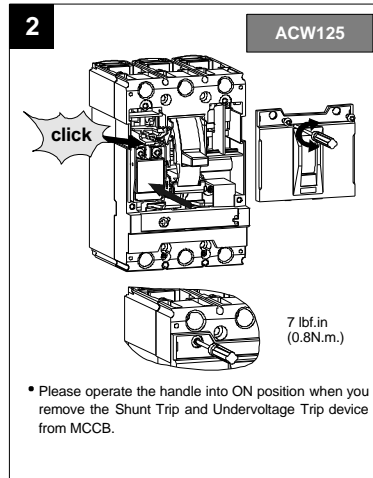
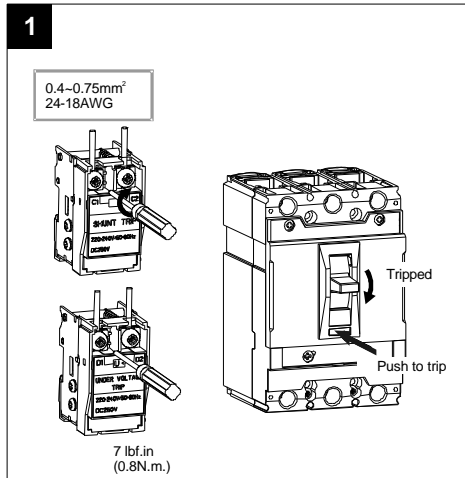

### Shunt Trip

- MCCB must trip when following Voltage is applied. (Vn : rated voltage)
- Operational voltage range : 0.7 ~ 1.1Vn
  - Frequency : 45Hz ~ 65Hz

### Under Voltage Trip

- MCCB must trip when the control voltage drop below a tripping voltage or interruption of electric power.
- Tripping voltage range : 0.35 ~ 0.7Vn
  - MCCB resumes when : 0.85Vn (exceed)
  - Frequency : 45Hz ~ 65Hz