

W21

Aluminium Multimounting
Three-phase Electric Motors
Latin American Market



Motors | Automation | Energy | Transmission & Distribution | Coatings

Visual Index

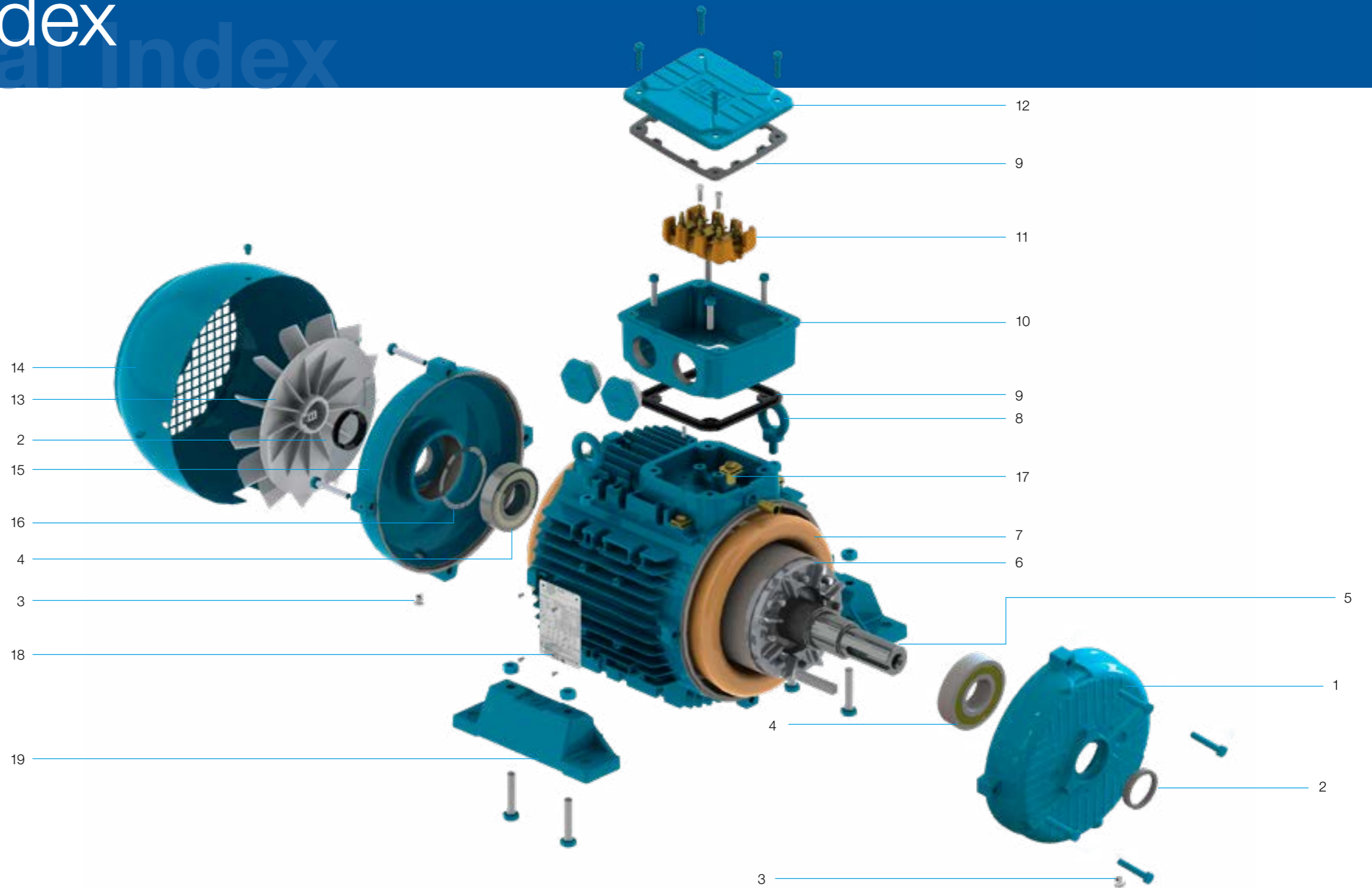

- 1 - Drive endshield
- 2 - Bearing seal (v'ring)
- 3 - Drain plug
- 4 - Bearings
- 5 - Shaft

- 6 - Squirrel cage rotor
- 7 - Wound stator
- 8 - Eye bolts
- 9 - Rubber gasket
- 10 - Terminal box

- 11 - Terminal block
- 12 - Terminal box cover
- 13 - Cooling Fan
- 14 - Fan cover
- 15 - Non-drive endshield

- 16 - Spring washer
- 17 - Grounding terminal
- 18 - Nameplate
- 19 - Removable feet

W21 Aluminium Multimounting - Three-Phase Electric Motors

Looking for the optimum solution to satisfy a diversity of requirements and applications, WEG offers its W21 Aluminium Multimounting three phase motor platform. Recognised for their high quality, reliability and flexibility, these motors are utilised throughout the world in a variety of industrial applications.

Standard Features

- Rated output: 0,12 to 37 kW
- Number of poles: 2, 4, 6 and 8
- Frame sizes IEC 63 to 200M/L
- Efficiency levels IE2 or IE3
- Ambient Temperature Range: -20°C to +40°C
- Frequency: 50 Hz or 60 HZ
- Voltage at 50 Hz: 220/380 V (up to 100 L)
380/660 V (from 112M and up);
- Voltage at 60 Hz: 220/440 V (up to 90S/L)
220/380/440 V (from 100L and up);
- Insulation class F (DT 80 K)
- Design N
- Degree of protection: IP55
- Cooling method: IC411 according to DIN EN 60034-6
- Mounting: B3T
- Frame material: Die cast aluminium
- Endshields material: Aluminium (up to 132M)
Cast iron (160M/L and up)
- Terminal box material: Aluminium
- Terminal block for motor connection
- Grounding: Simple grounding inside the terminal box
- Fan Material: Polypropylene
- Fan Cover Material: Steel
- Drain: Rubber drain plug
- V'ring seal on both endshields
- Shaft material: SAE 1040/45
- ZZ Ball bearings
- Eyebolts for frames 112M to 200M/L
- Painting Plan: WEG internal painting plans 207A semi-matt (frames 63 up to 132) and 203A semi-gloss (frames 160 up to 200), both meeting the 'C2' performance criteria defined in the DIN EN ISO 12944-2 standard
- Thermal Protection: Thermistors PTC (155 °C) in windings for frames 160 up to 200

**For further information about frequency inverter operation, please contact WEG.*

Optional Features

- Number of poles: 10, 12 or multispeed motors
- Non standard voltages
- Insulation Class H
- Thermal protections: Thermostats, Thermistors (PTC) or Thermoresistances (Pt-100) in windings
- Space Heaters
- Higher degrees of protection, up to IP66
- Forced ventilation, encoders or brakes
- Other mounting configurations, including foot/flange, flange, pad
- Accessories terminal box
- Cable glands
- Canopy for vertical shaft down applications
- Fan material: Conductive plastic, aluminium
- Shaft material: Stainless steel
- Double shaft end
- Painting plans for aggressive environments e.g. C5M / C5I acc. ISO 12944
- Internal anticorrosive epoxy painting



Features and Benefits

Reliability

WEG W21 Aluminium Motors are the result of high technological design, premium quality components and a wide application experience. Recognized for its quality, reliability and efficiency, the W21 Aluminium motor range incorporates the benefits of the W21 General Purpose cast iron line but with a lightweight construction and the with the flexibility offered by its multi-mounting mechanical design.

Flexible Construction

The W21 Aluminium motor line was developed in response to Market requirements regarding mounting flexibility. Consequently, and as its name suggests, the design incorporates a multimount feature which permits the motor to be mounted with the terminal box oriented

on the top or on either side. Additionally, the motor terminal box can be rotated in 90° increments, permitting connection of the incoming power cables in any position.

This unique system enables the mounting configuration to be easily changed with no machining or modification to the motor feet required.

Furthermore, the innovative design of the W21 Aluminium Multimounting line offers the additional advantage on standardization and stock flexibility, considering that a single motor may be utilised for all mounting possibilities whilst also offering full interchangeability with existing cast iron frame motors.

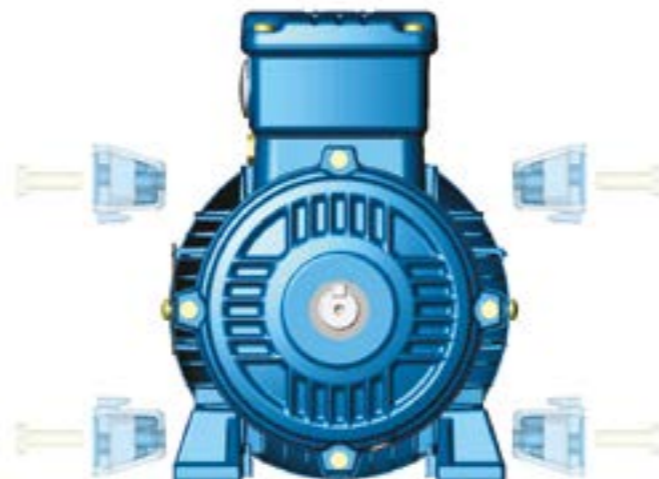

Definite Purpose Designs

Complimenting what is already a comprehensive range of industrial motors, the W21 aluminium multi-mounting line features, besides the standard version, several definite purpose derived designs, such as Brake Motors, Single Phase Motors, Marine Motors and TEAO (IC418) Motors for Fan & Exhaust applications.

These definite purpose designs are perfectly adapted to suit all application needs, and incorporate the same reliability, easy maintenance, reduced energy consumption and flexibility offered by the standard W21 Aluminium Multi-mounting line.

Construction Features

Frame		63	71	80	90S/L	100L	112M	132S	132M	S132S	160M/L	180M/L	200M/L	
Mechanical features														
Mounting		B3T												
Frame Material		Aluminium												
Degree of Protection (IP rating)		IP55												
Grounding		Single Grounding												
Cooling Method (IC)		Totally enclosed fan cooled (IC411)												
Fan Material		Plastic												
Fan Cover Material		Steel plate												
Endshields Material		Aluminium										FC-200 Cast Iron		
Drain		Rubber drain plug												
Bearings	Shielded/Clearance (DE)	ZZ										ZZ-C3		
	Shielded/Clearance (NDE)	ZZ										ZZ-C3		
	Locking	fitted with spring washer in the NDE												
	Drive End	6201	6203	6204	6205	6206	6307	6308	6308	6308	6309	6311	6312	
	Non drive end	6202	6203	6204	6205	6206	6207	6207	6207	6209	6211	6212		
Bearing Seal		V'ring												
Joint Seal		None												
Lubrica- tion	Grease type	Mobil Polyrex EM												
	Grease fitting	Without grease fitting												
Terminal block		BMC - 6-pins												
Terminal box material		Die cast aluminium												
Cable entries	Main	2 x M20 x 1.5			2 x M25 x 1.5			2 x M32 x 1.5			2 x M40 x 1.5		2 x M50 x 1.5	
	Size	Plastic plug for transport and storage												
Shaft	Material		SAE 1040/45											
	DE Threaded hole	2P	M4	M5	M6	M8	M10	M12		M16		M20		
		4 - 8P												
Vibration level		Grade A												
Key		Fitted with "A" type												
Nameplate material		Stainless steel AISI 304												
Balancing	2P	Without balance					With 1/2 key							
	4 - 12P	Without balance					With 1/2 key							
Painting	Type	207 A										203 A		
	Performance Criteria	Corrosive category C2 according to DIN EN ISO 12944-2												
	Colour	MUNSELL N6.5 (RAL 5009 as optional)												
Electrical features														
Design		N												
Voltage / Frequen- cy	IE2 / IE3	50HZ	220/380 W/ 6 term					380/660 W/ 6 term						
		60HZ	220/440 W/ 9 term					220/380/440 W/ 12 term						
Winding	Impregnation	Dip and bake												
	Insulation class	F (DT 80K)												
Service factor		1.00												
Rotor		Aluminium die cast												
Thermal protection		Without thermal protection												

Optional Features

Frame	63	71	80	90S/L	100L	112M	132S	132M	S132S	160M/L	180M/L	200M/L
Mechanical optionals												
Terminal block												
BMC terminal block - twelve-pin	0	0	0	0	0	0	0	0	0	0	0	0
Cable glands												
Plastic cable gland	0	0	0	0	0	0	0	0	0	0	0	0
Brass cable gland	0	0	0	0	0	0	0	0	0	0	0	0
Stainless steel cable gland	0	0	0	0	0	0	0	0	0	0	0	0
Flange												
Flange FF (IEC) or D (NEMA)	0	0	0	0	0	0	0	0	0	0	0	0
Flange C-DIN (IEC)	0	0	0	0	0	0	0	0	0	NA	NA	NA
Flange C (NEMA)	0	0	0	0	0	0	0	0	0	0	0	0
DE sealing												
Nitrilic rubber lip seal	0	0	0	0	0	0	0	0	0	0	0	0
Nitrilic rubber oil seal	0	0	0	0	0	0	0	0	0	0	0	0
Viton seal	0	0	0	0	0	0	0	0	0	0	0	0
Viton seal with spring	0	0	0	0	0	0	0	0	0	0	0	0
Viton seal with stainless steel spring	0	0	0	0	0	0	0	0	0	0	0	0
NDE sealing												
V-RING	0	0	0	0	0	0	0	0	0	0	0	0
Nitrilic rubber lip seal	0	0	0	0	0	0	0	0	0	0	0	0
Nitrilic rubber oil seal	0	0	0	0	0	0	0	0	0	0	0	0
Viton seal	0	0	0	0	0	0	0	0	0	0	0	0
Viton seal with spring	0	0	0	0	0	0	0	0	0	0	0	0
Joint / Bolts sealing												
Loctite 5923 (permatex) (joints / bolts)	0	0	0	0	0	0	0	0	0	0	0	0
Degree of protection												
IP56	0	0	0	0	0	0	0	0	0	0	0	0
Insulation Class												
F DT 105K	0	0	0	0	0	0	0	0	0	0	0	0
H DT 80K	0	0	0	0	0	0	0	0	0	0	0	0
H DT 105K	0	0	0	0	0	0	0	0	0	0	0	0
H DT 125K	0	0	0	0	0	0	0	0	0	0	0	0
F DT B	0	0	0	0	0	0	0	0	0	0	0	0
F DT F	0	0	0	0	0	0	0	0	0	0	0	0
H DT B	0	0	0	0	0	0	0	0	0	0	0	0
H DT F	0	0	0	0	0	0	0	0	0	0	0	0
Terminal Box												
Cast Iron	0	0	0	0	0	0	0	0	0	0	0	0
Painting												
No Painting	0	0	0	0	0	0	0	0	0	ND	ND	ND
203A	0	0	0	0	0	0	0	0	0	P	P	P
Plug												
Plain Plastic plug	0	0	0	0	0	0	0	0	0	0	0	0
No plug	0	0	0	0	0	0	0	0	0	0	0	0
Direction of Rotation												
Clockwise	0	0	0	0	0	0	0	0	0	0	0	0
Counterclockwise	0	0	0	0	0	0	0	0	0	0	0	0
Nameplate with arrow indicating direction of rotation	0	0	0	0	0	0	0	0	0	0	0	0

Notes:
P = Standard; O = Optional; E = Special; NA = Not available

Optional Features

Frame	63	71	80	90S/L	100L	112M	132S	132M	S132S	160M/L	180M/L	200M/L
Drain												
Stainless stell threaded drain plug (closed)	0	0	0	0	0	0	0	0	0	0	0	0
Balance												
Normal balance without key (2 poles)	NA	NA	NA	0	0	0	0	0	0	0	0	0
Normal balance without key (4 poles and upper)	NA	NA	NA	0	0	0	0	0	0	0	0	0
Normal balance with full key	0	0	0	0	0	0	0	0	0	0	0	0
Key												
B Key	0	0	0	0	0	0	0	0	0	0	0	0
Nameplates												
Adicional Nameplate for inverter	0	0	0	0	0	0	0	0	0	0	0	0
Bolts Material												
Stainless steel bolts 304	0	0	0	0	0	0	0	0	0	0	0	0
Stainless steel bolts 316	0	0	0	0	0	0	0	0	0	0	0	0
Other mechanical optionals												
Drip cover (recommended for vertical shaft down applications)	0	0	0	0	0	0	0	0	0	0	0	0

Electrical optionals												
Thermal protection												
Thermostat - alarm / trip (NO or NC) - 130 °C	0	0	0	0	0	0	0	0	0	0	0	0
Thermostat - alarm / trip (NO or NC) - 155 °C	0	0	0	0	0	0	0	0	0	0	0	0
Pt-100 two wires, one per phase	0	0	0	0	0	0	0	0	0	0	0	0
Pt-100 three wires, one per phase	0	0	0	0	0	0	0	0	0	0	0	0
PTC Thermistor - alarm/trip (130 °C)	0	0	0	0	0	0	0	0	0	0	0	0
PTC Thermistor - alarm/trip (155 °C)	0	0	0	0	0	0	0	0	0	0	0	0
PTC Thermistor - trip (180 °C)	0	0	0	0	0	0	0	0	0	0	0	0
Space heaters												
110-127 V	0	0	0	0	0	0	0	0	0	0	0	0
200-240 V	0	0	0	0	0	0	0	0	0	0	0	0
110-127 / 220-240 V	ND	ND	ND	ND	ND	E	E	E	E	E	E	E
380-480 V	E	E	E	E	E	E	E	E	E	E	E	E
Service factor												
At 50Hz Service factor 1.15	0	0	0	0	0	0	0	0	0	0	0	0
At 60Hz Service factor 1.25	0	0	0	0	0	0	0	0	0	0	0	0

Notes:
P = Standard; O = Optional; E = Special; NA = Not available

Flange mounted motors

“FF” Flange

Frame	"FF" Flange Dimensions								N° of Holes	
	Flange	C	LA	M	N	P	T	S		
63	FF-115	40	9	115	95	140	3	10	45°	4
71	FF-130	45		130	110	160	3.5			
80	FF-165	50	10	165	130	200		4		
90S/L		56								
100L	FF-215	63	11	215	180	250	5	19		
112M		70								
S132S	FF-265	89	12	265	230	300	5	19		
132S/M										
160M/L	FF-300	108	18	300	250	350	5	19		
180M/L		121								
200M/L	FF-350	133		350	300	400				

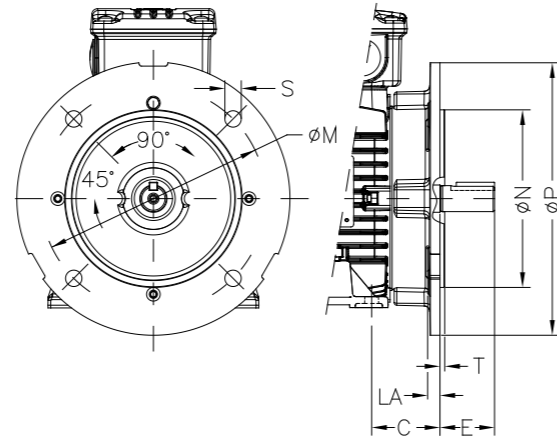

“C-DIN” Flange

Frame	"C" DIN Flange Dimensions							N° of Holes
	Flange	C	M	N	P	S	T	
63	C-90	40	75	60	90	M5	2.5	4
71	C-105	45	85	70	105	M6		
80	C-120	50	100	80	120		M8	
90S/L	C-140	56	115	95	140			
100L	C-160	63	130	110	160	M10	3.5	
112M		70						
S132S	C-200	89	165	130	200	M12	4	
132S/M								
160M/L	C-250	108	215	180	252			

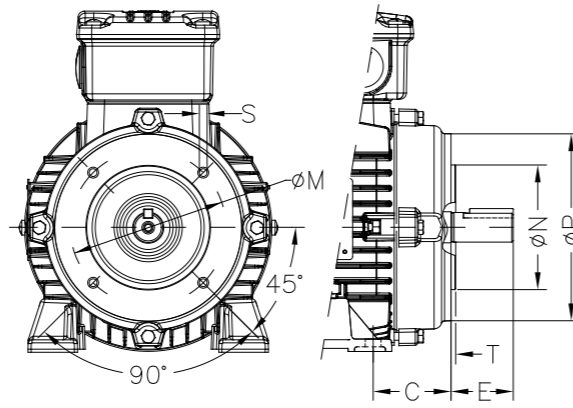



Global presence is essential, as much as understanding your needs.

Global Presence

With approximately 37,000 employees worldwide, WEG is one of the largest electric motors, electronic equipments and systems manufacturers. We are constantly expanding our portfolio of products and services with expertise and market knowledge. We create integrated and customized solutions ranging from innovative products to complete after-sales service.

WEG's know-how guarantees our **W21 Aluminum Multimounting motor** is the right choice for your application and business, assuring safety, efficiency and reliability.

-  **Availability** is to have a global support network
-  **Partnership** is to create solutions that suits your needs
-  **Competitive edge** is to unite technology and innovation



For WEG's worldwide
operations visit our website



www.weg.net



 +55 47 3276 4000

 info-br@weg.net

 WEG Group
Jaraguá do Sul - SC - Brazil

Cod: 50096575 | Rev: 04 | Date (m/y): 09/2022

The values shown are subject to change without prior notice.
The information contained is reference values.